

CATALOGUE

of profiles, produced

in „ALCOMET“ Plc - SHOUMEN

Number catalogue from 3506 to 3995

2009

Мк: -170
бр. кан.-2

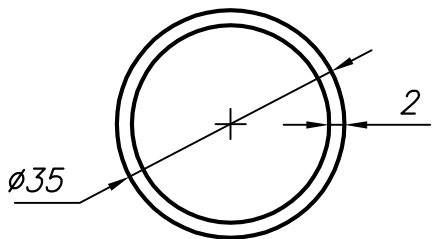

$F = 207 \text{ mm}^2$
 $G = 0,560 \text{ kg/m}$

500-3506

Мк: -170
бр. кан.-1
погд.
оп.п.

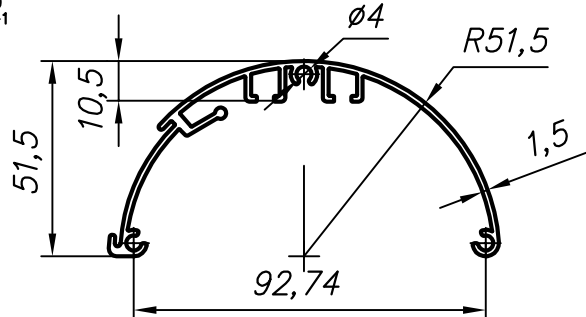

$F = 385 \text{ mm}^2$
 $G = 1,041 \text{ kg/m}$

500-3511

Мк: -130
бр. кан.-4

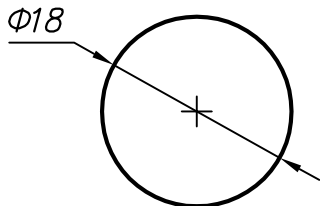

$F = 255 \text{ mm}^2$
 $G = 0,687 \text{ kg/m}$

500-3507

Мк: -230
бр. кан.-1
погд.
оп.п.

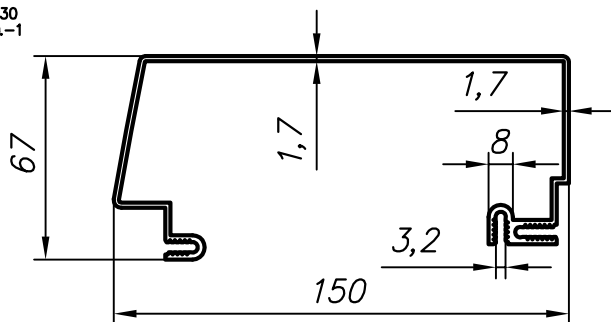

$F = 648 \text{ mm}^2$
 $G = 1,749 \text{ kg/m}$

500-3512

Мк: -170
бр. кан.-2
погд.
оп.п.

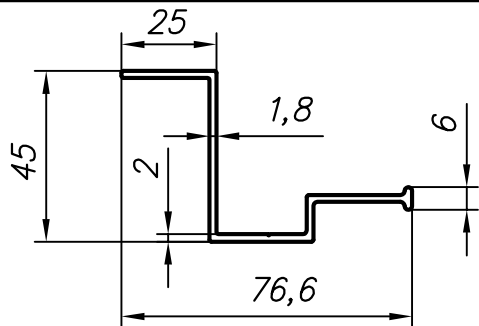

$F = 248 \text{ mm}^2$
 $G = 0,668 \text{ kg/m}$

500-3508

Мк: -230
бр. кан.-2
погд.

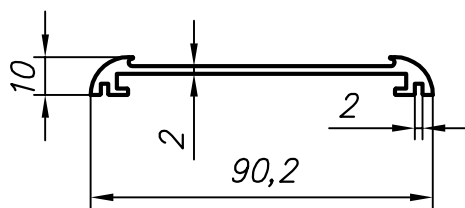

$F = 263 \text{ mm}^2$
 $G = 0,711 \text{ kg/m}$

500-3513

Мк: -130
бр. кан.-1
погд.
оп.п.

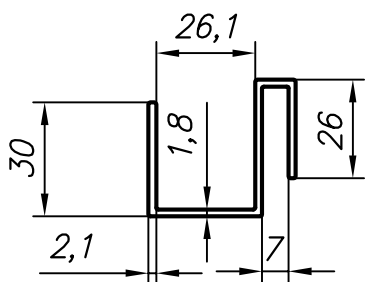

$F = 234 \text{ mm}^2$
 $G = 0,632 \text{ kg/m}$

500-3509

Мк: -270
бр. кан.-1
погд.

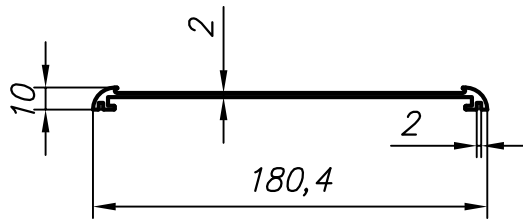

$F = 443 \text{ mm}^2$
 $G = 1,198 \text{ kg/m}$

500-3514

Мк: -170
бр. кан.-1
погд.
оп.п.

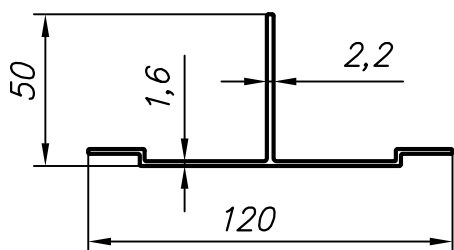

$F = 311 \text{ mm}^2$
 $G = 0,841 \text{ kg/m}$

500-3510

Мк: -130
бр. кан.-2
погд.
оп.п.

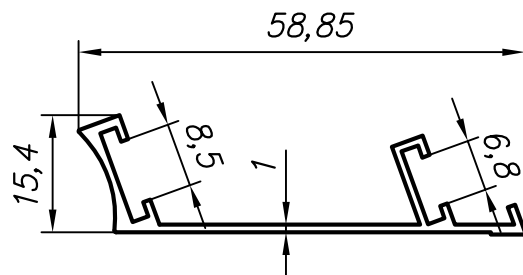

$F = 110 \text{ mm}^2$
 $G = 0,288 \text{ kg/m}$

500-3515

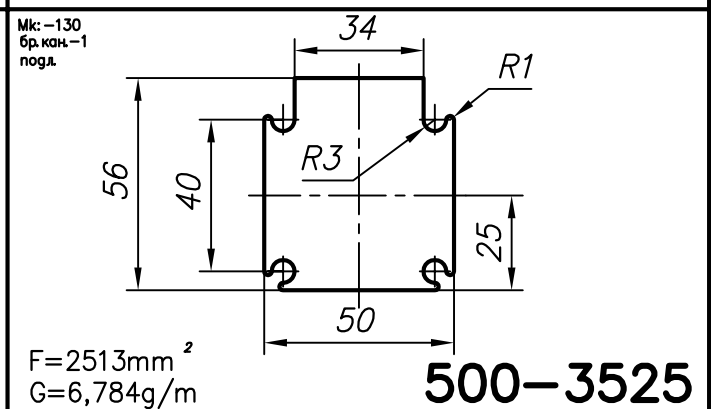
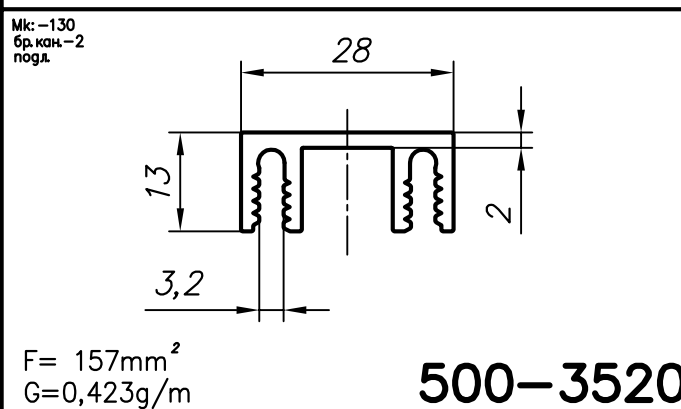
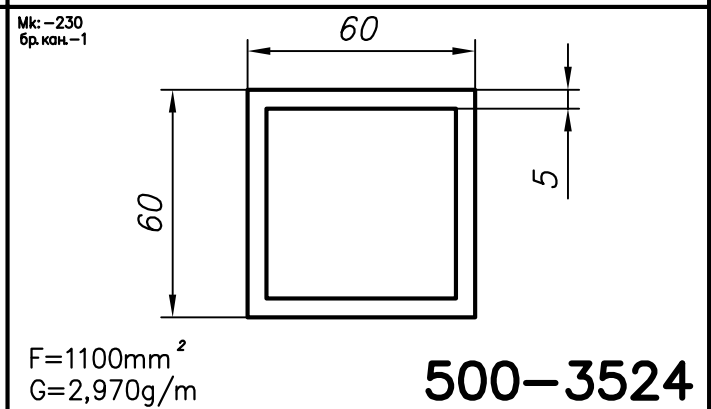
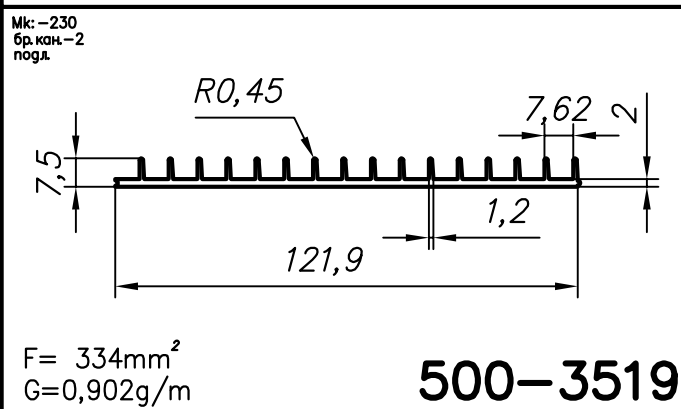
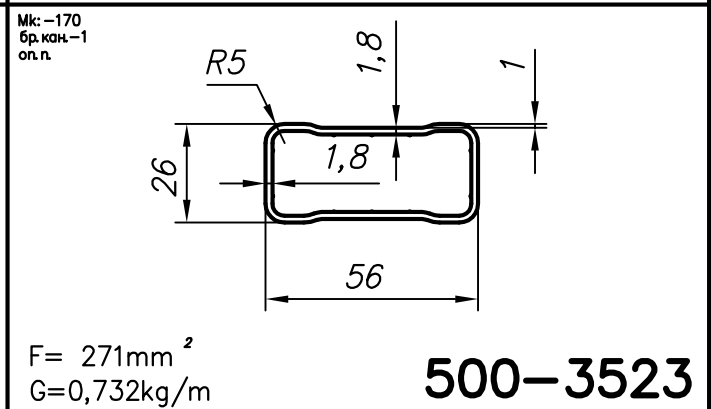
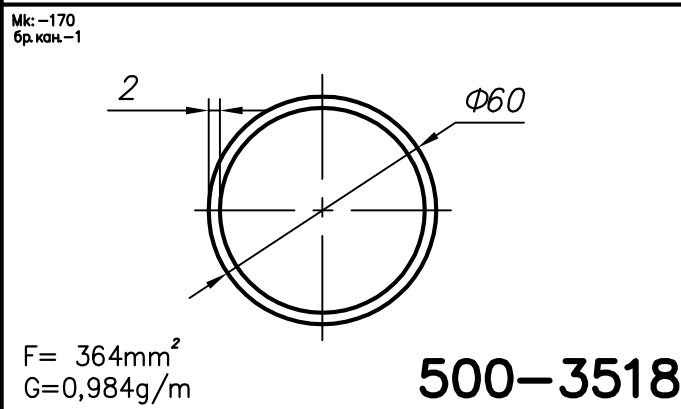
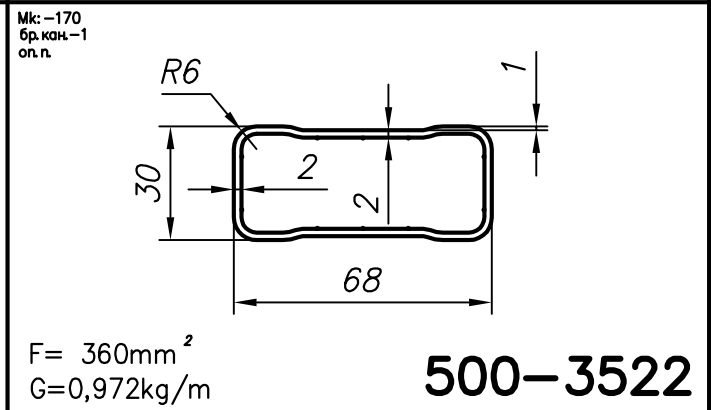
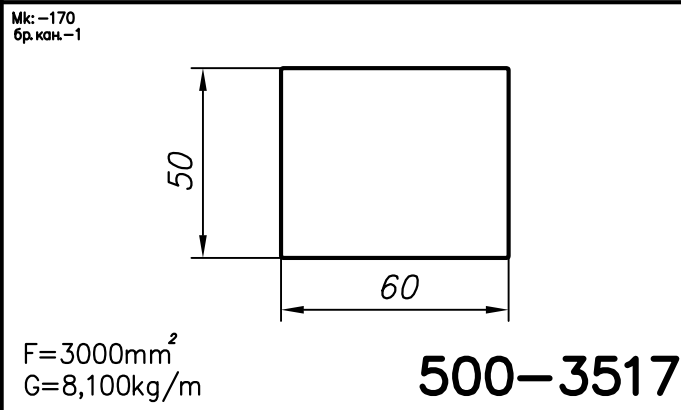
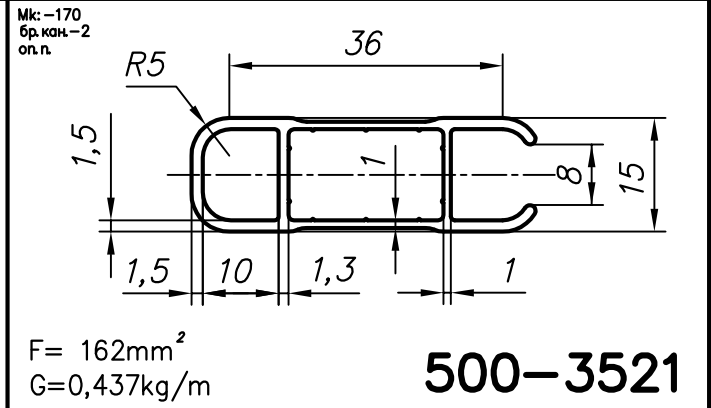
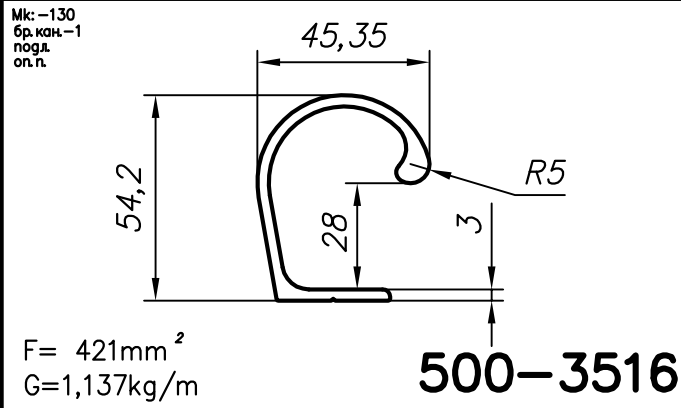

Мк: -130
бр. кан. - 4

$F = 196 \text{ mm}^2$
 $G = 0,529 \text{ kg/m}$

500-3526

Мк: -130
бр. кан. - 2
подл.

$F = 177 \text{ mm}^2$
 $G = 0,477 \text{ kg/m}$

500-3531

Мк: -130
бр. кан. - 2
подл.
оп. п.

$F = 171 \text{ mm}^2$
 $G = 0,461 \text{ kg/m}$

500-3527

Мк: -170
бр. кан. - 2
подл.
оп. п.

$F = 217 \text{ mm}^2$
 $G = 0,586 \text{ kg/m}$

500-3532

Мк: -130
бр. кан. - 2
оп. п.

$F = 131 \text{ mm}^2$
 $G = 0,353 \text{ g/m}$

500-3528

Мк: -230
бр. кан. - 1

$F = 1446 \text{ mm}^2$
 $G = 4,173 \text{ kg/m}$

500-3533

Мк: -130
бр. кан. - 4
подл.
оп. п.

$F = 58 \text{ mm}^2$
 $G = 0,157 \text{ g/m}$

500-3529

Мк: -130
бр. кан. - 1
оп. п.

$F = 151 \text{ mm}^2$
 $G = 0,408 \text{ kg/m}$

500-3534

Мк: -130
бр. кан. - 1
подл.

$F = 1428 \text{ mm}^2$
 $G = 3,856 \text{ g/m}$

500-3530

Мк: -170
бр. кан. - 4
подл.
оп. п.

$F = 162 \text{ mm}^2$
 $G = 0,437 \text{ g/m}$

500-3535

Мк: -230
бр. кан. -2

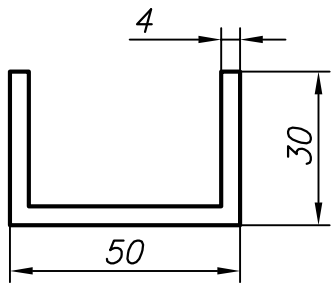

$F = 408 \text{ mm}^2$
 $G = 1,102 \text{ kg/m}$

500-3536

Мк: -170
бр. кан. -1
подл.
оп. п.

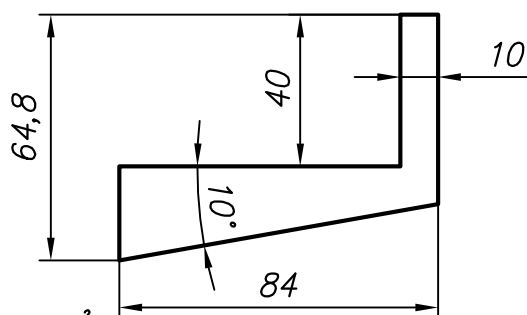

$F = 1862 \text{ mm}^2$
 $G = 5,028 \text{ kg/m}$

500-3541

Мк: -170
бр. кан. -1

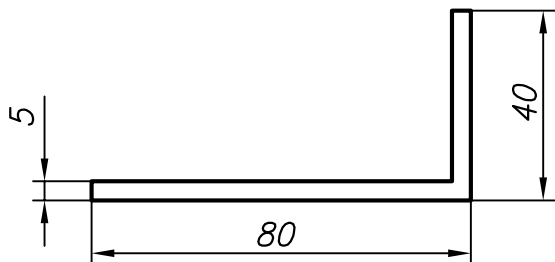

$F = 575 \text{ mm}^2$
 $G = 1,553 \text{ kg/m}$

500-3537

Мк: -130
бр. кан. -1
подл.
оп. п.

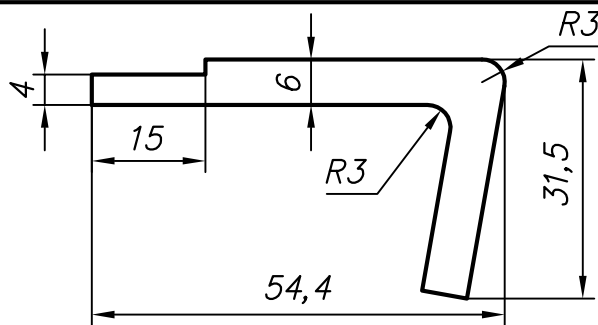

$F = 449 \text{ mm}^2$
 $G = 1,213 \text{ kg/m}$

500-3542

Мк: -130
бр. кан. -2
подл.
оп. п.

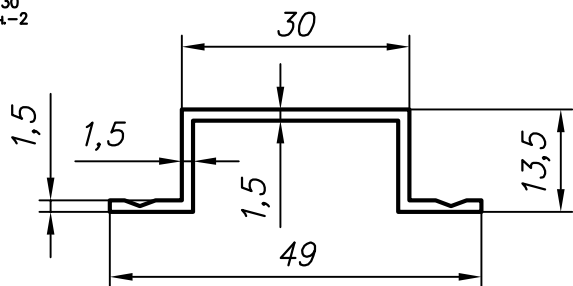

$F = 106 \text{ mm}^2$
 $G = 0,287 \text{ kg/m}$

500-3538

Мк: -130
бр. кан. -1
подл.

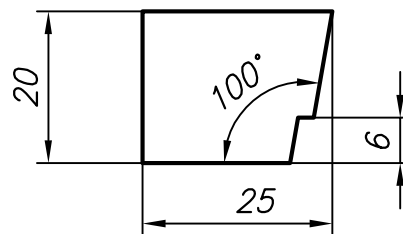

$F = 452 \text{ mm}^2$
 $G = 1,222 \text{ kg/m}$

500-3543

Мк: -230
бр. кан. -2
подл.
оп. п.

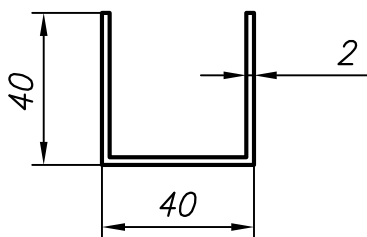

$F = 232 \text{ mm}^2$
 $G = 0,626 \text{ kg/m}$

500-3539

Мк: -270
бр. кан. -4

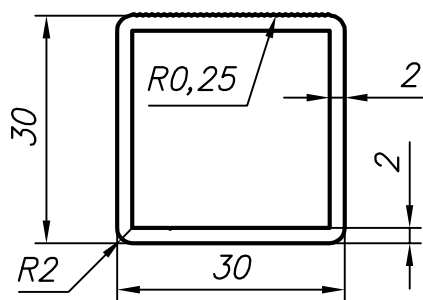

$F = 223 \text{ mm}^2$
 $G = 0,603 \text{ kg/m}$

500-3544

Мк: -170
бр. кан. -1

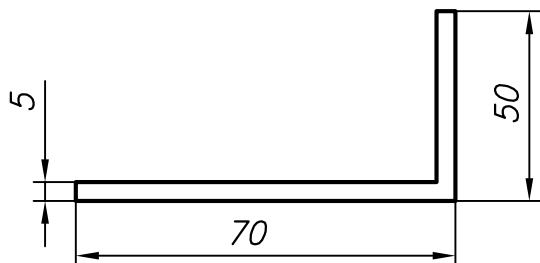

$F = 575 \text{ mm}^2$
 $G = 1,552 \text{ kg/m}$

500-3540

Мк: -270
бр. кан. -2

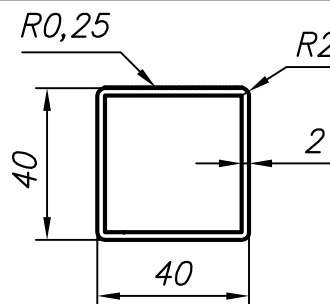

$F = 304 \text{ mm}^2$
 $G = 0,822 \text{ kg/m}$

500-3545

Мк: -170
бр. кан.-2

$F = 162 \text{ mm}^2$
 $G = 0,438 \text{ kg/m}$

500-3546

Мк: -270
бр. кан.-1

$F = 924 \text{ mm}^2$
 $G = 2,495 \text{ kg/m}$

500-3551

Мк: -170
бр. кан.-2

$F = 194 \text{ mm}^2$
 $G = 0,524 \text{ kg/m}$

500-3547

Мк: -130
бр. кан.-4
подл.

$F = 92 \text{ mm}^2$
 $G = 0,248 \text{ kg/m}$

500-3552

Мк: -270
бр. кан.-1

$F = 1722 \text{ mm}^2$
 $G = 4,649 \text{ kg/m}$

500-3548

Мк: -270
бр. кан.-1

$F = 1400 \text{ mm}^2$
 $G = 3,780 \text{ kg/m}$

500-3553

Мк: -170
бр. кан.-1

$F = 475 \text{ mm}^2$
 $G = 1,283 \text{ g/m}$

500-3549

Мк: -170
бр. кан.-1

$F = 1200 \text{ mm}^2$
 $G = 3,240 \text{ kg/m}$

500-3554

Мк: -270
бр. кан.-1

$F = 775 \text{ mm}^2$
 $G = 2,093 \text{ g/m}$

500-3550

Мк: -230
бр. кан.-2

$F = 264 \text{ mm}^2$
 $G = 0,713 \text{ g/m}$

500-3555

Мк: -230
бр. кан.-2

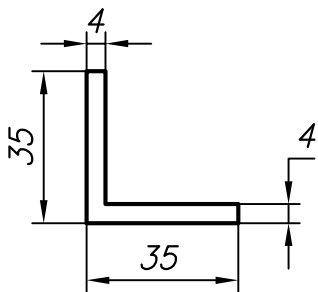

$F = 264\text{mm}^2$
 $G = 0,713\text{kg/m}$

500-3556

Мк: -270
бр. кан.-1

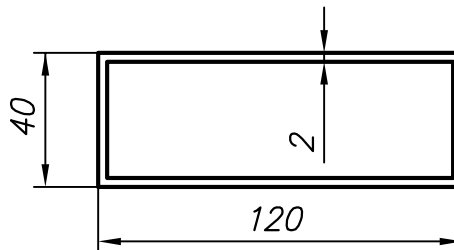

$F = 624\text{mm}^2$
 $G = 1,685\text{kg/m}$

500-3561

Мк: -130
бр. кан.-1
оп.п.

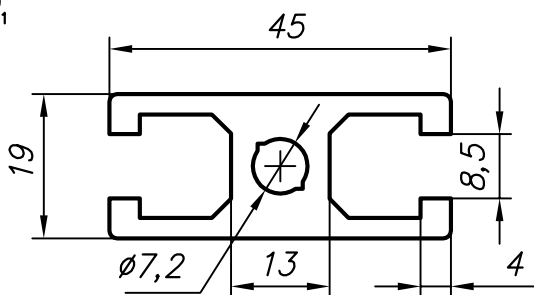

$F = 431\text{mm}^2$
 $G = 1,163\text{kg/m}$

500-3557

Мк: -130
бр. кан.-4

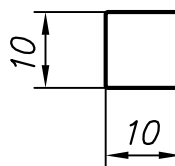

$F = 100\text{mm}^2$
 $G = 0,270\text{kg/m}$

500-3562

Мк: -130
бр. кан.-1

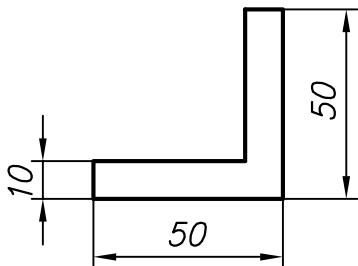

$F = 900\text{mm}^2$
 $G = 2,430\text{kg/m}$

500-3558

Мк: -170
бр. кан.-1

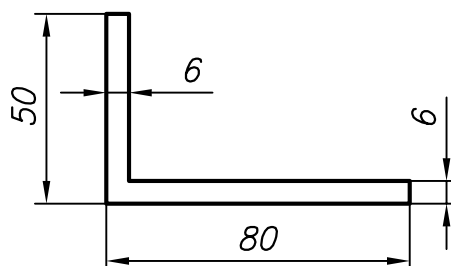

$F = 744\text{mm}^2$
 $G = 2,010\text{kg/m}$

500-3563

Мк: -170
бр. кан.-2

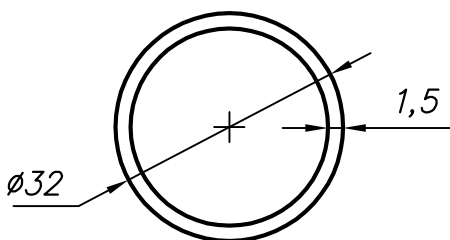

$F = 144\text{mm}^2$
 $G = 0,388\text{kg/m}$

500-3559

Мк: -130
бр. кан.-1

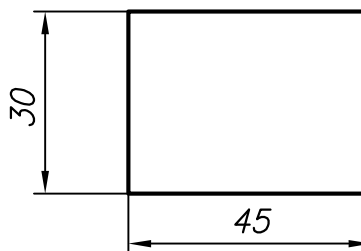

$F = 1350\text{mm}^2$
 $G = 3,645\text{kg/m}$

500-3564

Мк: -130
бр. кан.-4

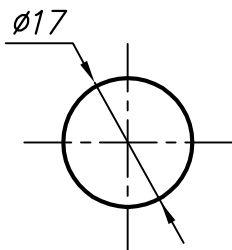

$F = 227\text{mm}^2$
 $G = 0,613\text{kg/m}$

500-3560

Мк: -130
бр. кан.-4
подл.

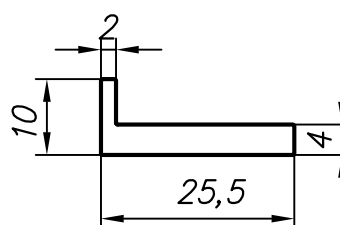

$F = 114\text{mm}^2$
 $G = 0,308\text{kg/m}$

500-3565

Мк: -270
бр. кан.-1
погд.
оп.п.

$F = 432\text{mm}^2$
 $G = 1,168\text{kg/m}$

500-3566

Мк: -170
бр. кан.-2
погд.
оп.п.

$F = 323\text{mm}^2$
 $G = 0,872\text{kg/m}$

500-3571

Мк: -170
бр. кан.-1
погд.
оп.п.

$F = 1128\text{mm}^2$
 $G = 3,046\text{kg/m}$

500-3567

Мк: -170
бр. кан.-2
погд.
оп.п.

$F = 265\text{mm}^2$
 $G = 0,717\text{kg/m}$

500-3572

Мк: -270
бр. кан.-2

$F = 384\text{mm}^2$
 $G = 1,037\text{g/m}$

500-3568

Мк: -130
бр. кан.-4

$F = 256\text{mm}^2$
 $G = 0,691\text{kg/m}$

500-3573

Мк: -270
бр. кан.-1
погд.

$F = 415\text{mm}^2$
 $G = 1,121\text{g/m}$

500-3569

Мк: -130
бр. кан.-4

$F = 96\text{mm}^2$
 $G = 0,261\text{kg/m}$

500-3574

Мк: -270
бр. кан.-1
погд.

$F = 546\text{mm}^2$
 $G = 1,474\text{g/m}$

500-3570

Мк: -130
бр. кан.-1

$F = 1125\text{mm}^2$
 $G = 3,038\text{g/m}$

500-3575

Мк: -130
бр. кан. - 4
погл.

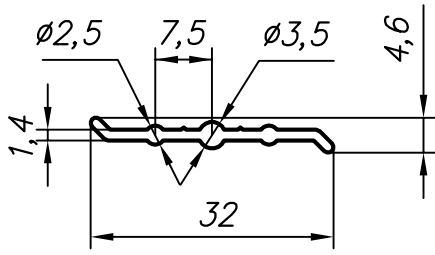

$F = 55 \text{ mm}^2$
 $G = 0,147 \text{ kg/m}$

500-3576

Мк: -270
бр. кан. - 2

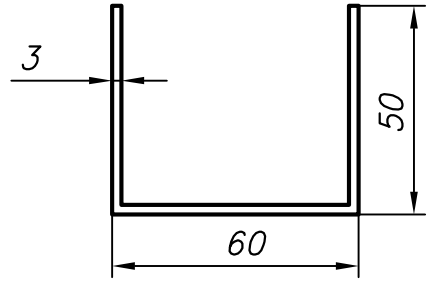

$F = 462 \text{ mm}^2$
 $G = 1,247 \text{ kg/m}$

500-3581

Мк: -130
бр. кан. - 4
погл.

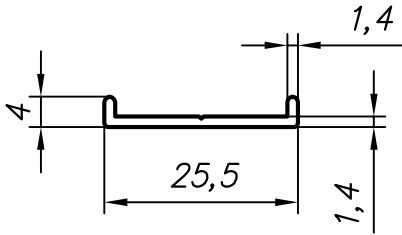

$F = 42 \text{ mm}^2$
 $G = 0,114 \text{ kg/m}$

500-3577

Мк: -230
бр. кан. - 2

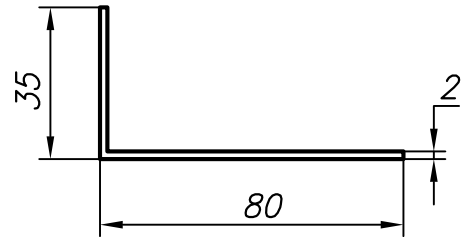

$F = 226 \text{ mm}^2$
 $G = 0,610 \text{ kg/m}$

500-3582

Мк: -170
бр. кан. - 4
оп. п.

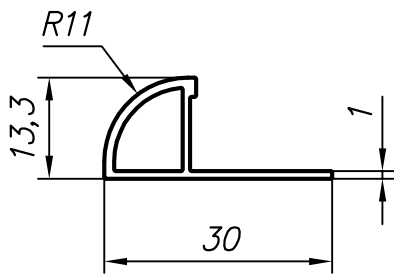

$F = 66 \text{ mm}^2$
 $G = 0,180 \text{ kg/m}$

500-3578

Мк: -170
бр. кан. - 1
погл.

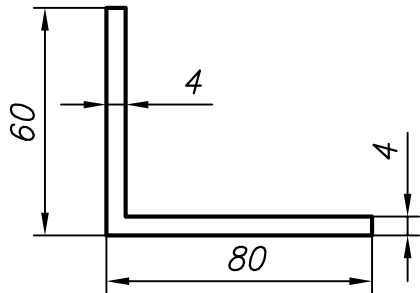

$F = 544 \text{ mm}^2$
 $G = 1,470 \text{ kg/m}$

500-3583

Мк: -170
бр. кан. - 4
оп. п.

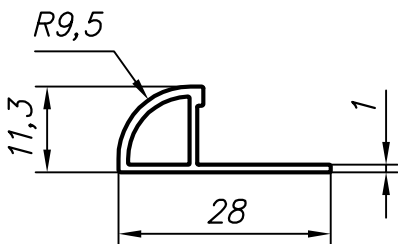

$F = 59 \text{ mm}^2$
 $G = 0,160 \text{ kg/m}$

500-3579

Мк: -170
бр. кан. - 1
погл.

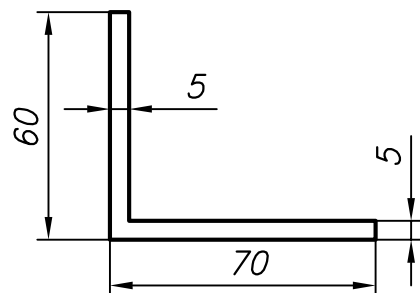

$F = 584 \text{ mm}^2$
 $G = 1,687 \text{ kg/m}$

500-3584

Мк: -270
бр. кан. - 1
оп. п.

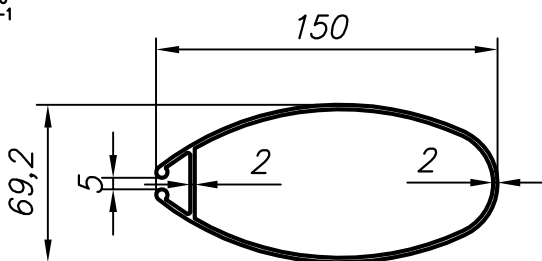

$F = 767 \text{ mm}^2$
 $G = 2,072 \text{ kg/m}$

500-3580

Мк: -230
бр. кан. - 1

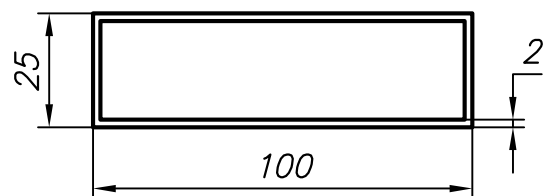

$F = 484 \text{ mm}^2$
 $G = 1,307 \text{ kg/m}$

500-3585

Мк: -170
бр. кан. -1

$F = 227\text{mm}^2$
 $G = 0,614\text{kg/m}$

500-3586

Мк: -170
бр. кан. -1

$F = 504\text{mm}^2$
 $G = 1,361\text{kg/m}$

500-3591

Мк: -270
бр. кан. -1
подл.
оп. п.
пр. кам.

$F = 867\text{mm}^2$
 $G = 2,342\text{kg/m}$

500-3587

Мк: -270
бр. кан. -1
подл.

$F = 1376\text{mm}^2$
 $G = 3,715\text{kg/m}$

500-3592

Мк: -270
бр. кан. -1

$F = 1248\text{mm}^2$
 $G = 3,370\text{kg/m}$

500-3588

Мк: -270
бр. кан. -1
оп. п.

$F = 1536\text{mm}^2$
 $G = 4,147\text{kg/m}$

500-3593

Мк: -130
бр. кан. -1
подл.

$F = 550\text{mm}^2$
 $G = 1,485\text{kg/m}$

500-3589

Мк: -170
бр. кан. -2
подл.

$F = 124\text{mm}^2$
 $G = 0,335\text{kg/m}$

500-3594

Мк: -270
бр. кан. -1

$F = 975\text{mm}^2$
 $G = 2,632\text{kg/m}$

500-3590

Мк: -130
бр. кан. -2
подл.

$F = 142\text{mm}^2$
 $G = 0,383\text{kg/m}$

500-3595

Мк: -230
бр. кан.-1
погл.
оп. п.
пр. кам.

$F = 724 \text{mm}^2$
 $G = 1,956 \text{kg/m}$

500-3596

Мк: -130
бр. кан.-4
погл.

$F = 58,5 \text{mm}^2$
 $G = 0,158 \text{kg/m}$

500-3601

Мк: -200
бр. кан.-2
погл.
оп. п.

$F = 242 \text{mm}^2$
 $G = 0,653 \text{kg/m}$

500-3597

Мк: -200
бр. кан.-2
погл.

$F = 152 \text{mm}^2$
 $G = 0,410 \text{kg/m}$

500-3602

Мк: -200
бр. кан.-2
погл.
оп. п.

$F = 337 \text{mm}^2$
 $G = 0,911 \text{kg/m}$

500-3598

Мк: -130
бр. кан.-1
оп. п.

$F = 265 \text{mm}^2$
 $G = 0,715 \text{kg/m}$

500-3603

Мк: -270
бр. кан.-1
погл.

$F = 1248 \text{mm}^2$
 $G = 3,370 \text{kg/m}$

500-3599

Мк: -230
бр. кан.-1
оп. п.

$F = 582 \text{mm}^2$
 $G = 1,571 \text{kg/m}$

500-3604

Мк: -130
бр. кан.-2
оп. п.

$F = 134 \text{mm}^2$
 $G = 0,362 \text{g/m}$

500-3600

Мк: -130
бр. кан.-1
оп. п.

$F = 709 \text{mm}^2$
 $G = 1,914 \text{g/m}$

500-3605

Мк: -200
бр. кан.-1
оп. п.

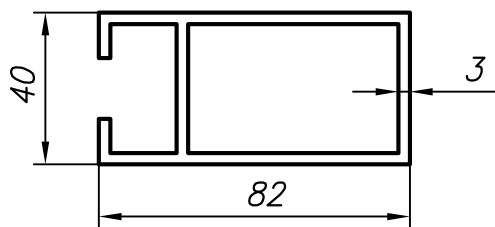

$F = 750 \text{ mm}^2$
 $G = 2,025 \text{ kg/m}$

500-3606

Мк: -200
бр. кан.-2
подл.
пр. кан.

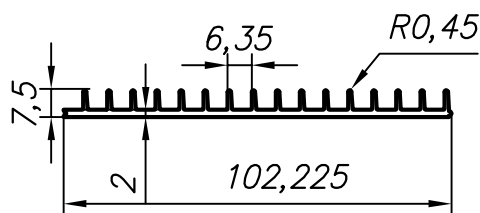

$F = 286 \text{ mm}^2$
 $G = 0,771 \text{ kg/m}$

500-3611

Мк: -170
бр. кан.-1

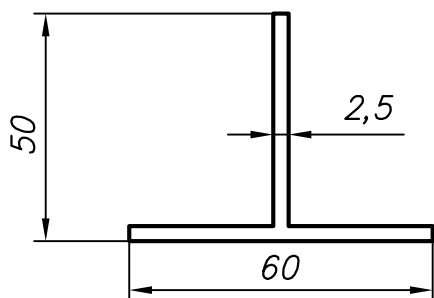

$F = 269 \text{ mm}^2$
 $G = 0,726 \text{ kg/m}$

500-3607

Мк: -200
бр. кан.-2
подл.

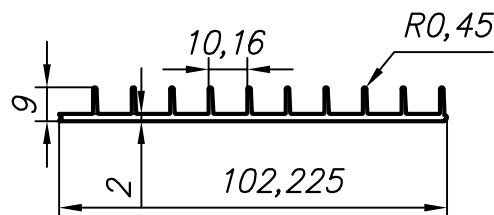

$F = 275 \text{ mm}^2$
 $G = 0,743 \text{ kg/m}$

500-3612

Мк: -170
бр. кан.-2

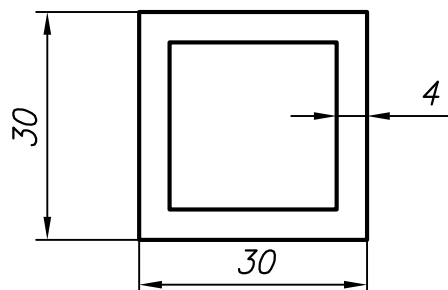

$F = 416 \text{ mm}^2$
 $G = 1,123 \text{ g/m}$

500-3608

Мк: -200
бр. кан.-1
подл.
оп. п.
пр. кан.

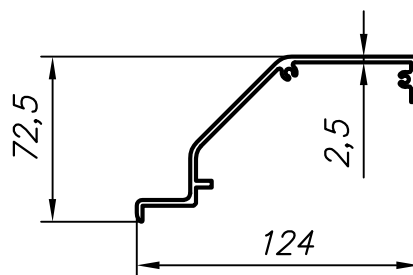

$F = 550 \text{ mm}^2$
 $G = 1,485 \text{ kg/m}$

500-3613

Мк: -170
бр. кан.-1
подл.
оп. п.

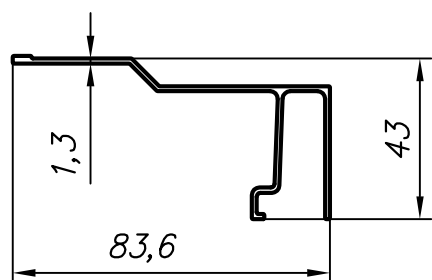

$F = 215 \text{ mm}^2$
 $G = 0,581 \text{ g/m}$

500-3609

Мк: -270
бр. кан.-2

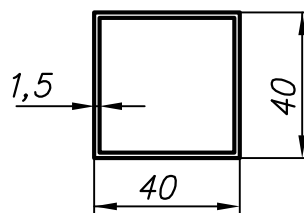

$F = 231 \text{ mm}^2$
 $G = 0,624 \text{ kg/m}$

500-3614

Мк: -170
бр. кан.-1
подл.
оп. п.

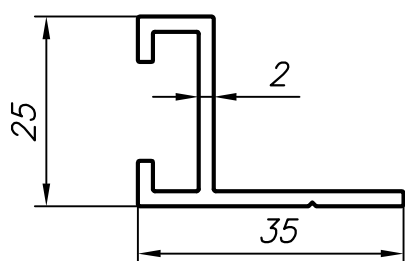

$F = 311 \text{ mm}^2$
 $G = 0,841 \text{ g/m}$

500-3610

Мк: -270
бр. кан.-1
оп. п.

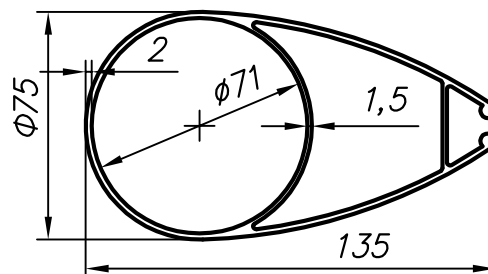

$F = 866 \text{ mm}^2$
 $G = 2,338 \text{ g/m}$

500-3615

Мк: -270
бр. кан.-1
погл.
оп.п.

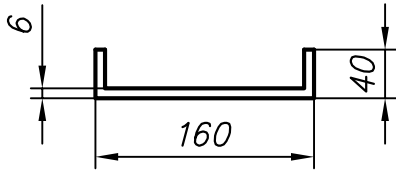

$F=1368\text{mm}^2$
 $G=3,694\text{kg/m}$

500-3616

Мк: -230
бр. кан.-2

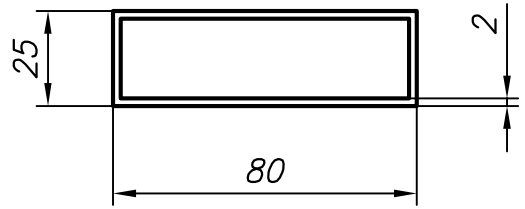

$F=404\text{mm}^2$
 $G=1,090\text{kg/m}$

500-3621

Мк: -270
бр. кан.-2

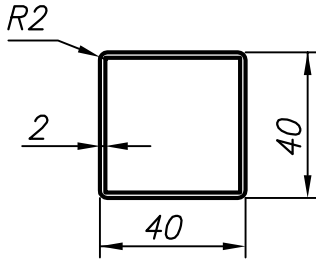

$F=301\text{mm}^2$
 $G=0,812\text{kg/m}$

500-3617

Мк: -130
бр. кан.-4
погл.

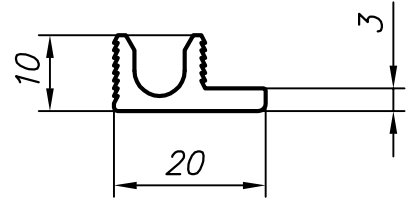

$F=89\text{mm}^2$
 $G=0,241\text{kg/m}$

500-3622

Мк: -170
бр. кан.-4
погл.

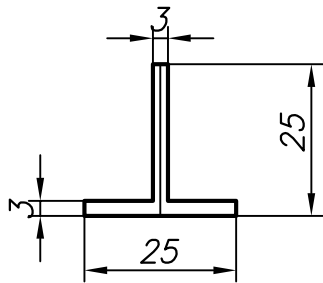

$F=141\text{mm}^2$
 $G=0,381\text{kg/m}$

500-3618

Мк: -270
бр. кан.-1

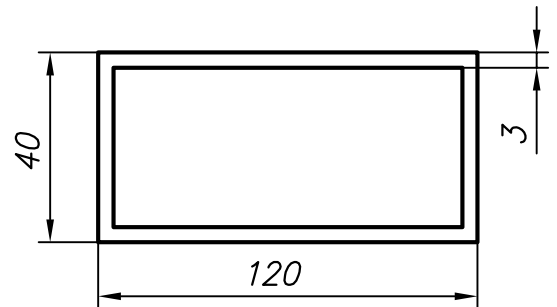

$F=924\text{mm}^2$
 $G=2,495\text{kg/m}$

500-3623

Мк: -230
бр. кан.-2

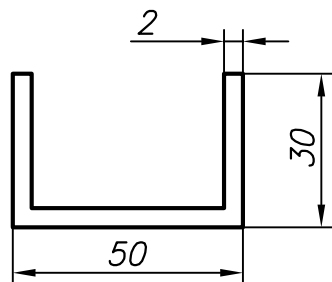

$F=212\text{mm}^2$
 $G=0,572\text{kg/m}$

500-3619

Мк: -230
бр. кан.-2
оп.п.

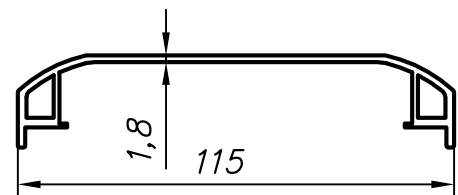

$F=365\text{mm}^2$
 $G=0,986\text{kg/m}$

500-3624

Мк: -170
бр. кан.-1

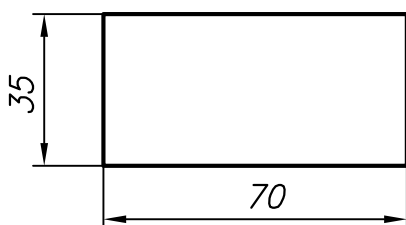

$F=2450\text{mm}^2$
 $G=6,615\text{kg/m}$

500-3620

Мк: -170
бр. кан.-2
погл.

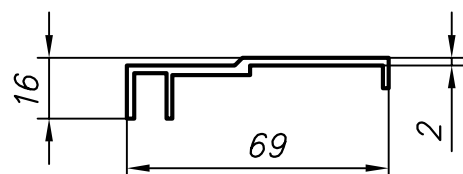

$F=205\text{mm}^2$
 $G=0,554\text{kg/m}$

500-3625

Мк: -200
бр. кан. - 2
подл.

$F=167,5\text{mm}^2$
 $G=0,452\text{kg/m}$

500-3626

Мк: -270
бр. кан. - 1

$F=1225\text{mm}^2$
 $G=3,308\text{kg/m}$

500-3631

Мк: -230
бр. кан. - 1
оп. п.

$F=868\text{mm}^2$
 $G=2,344\text{kg/m}$

500-3627

Мк: -130
бр. кан. - 4

$F=160\text{mm}^2$
 $G=0,432\text{kg/m}$

500-3632

Мк: -230
бр. кан. - 1
подл.
оп. п.

$F=1500\text{mm}^2$
 $G=4,050\text{kg/m}$

500-3628

Мк: -270
бр. кан. - 1
оп. п.

$F=665\text{mm}^2$
 $G=1,796\text{kg/m}$

500-3633

Мк: -170
бр. кан. - 1
подл.

$F=677\text{mm}^2$
 $G=1,830\text{kg/m}$

500-3629

Мк: -270
бр. кан. - 1

$F=1376\text{mm}^2$
 $G=3,715\text{kg/m}$

500-3634

Мк: -130
бр. кан. - 1
подл.

$F=604\text{mm}^2$
 $G=1,632\text{kg/m}$

500-3630

Мк: -170
бр. кан. - 2
подл.
оп. п.
пр. кан.

$F=283\text{mm}^2$
 $G=0,765\text{kg/m}$

500-3635

Мк: -170
бр. кан.-2
подл.

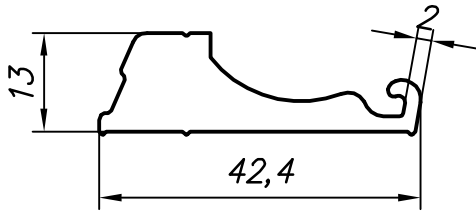

$F = 291\text{mm}^2$
 $G = 0,786\text{kg/m}$

500-3636

Мк: -170
бр. кан.-1
подл.
оп.п.

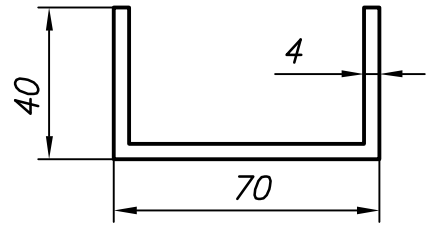

$F = 568\text{mm}^2$
 $G = 1,534\text{kg/m}$

500-3641

Мк: -130
бр. кан.-2
подл.

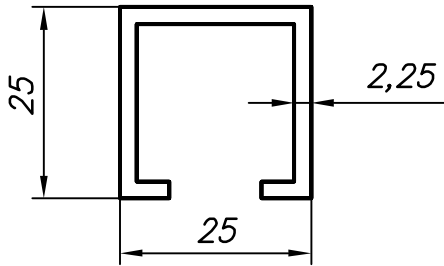

$F = 178\text{mm}^2$
 $G = 0,480\text{kg/m}$

500-3637

Мк: -130
бр. кан.-2

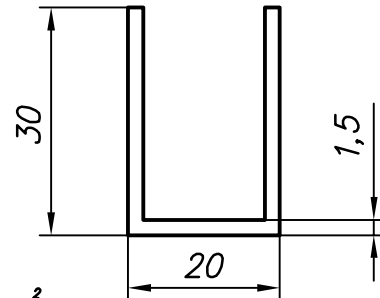

$F = 116\text{mm}^2$
 $G = 0,312\text{kg/m}$

500-3642

Мк: -170
бр. кан.-2
подл.

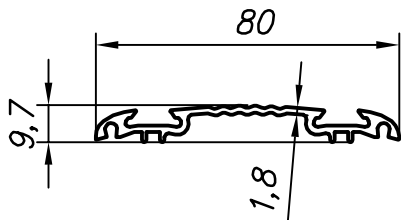

$F = 225\text{mm}^2$
 $G = 0,605\text{kg/m}$

500-3638

Мк: -170
бр. кан.-2
подл.
оп.п.

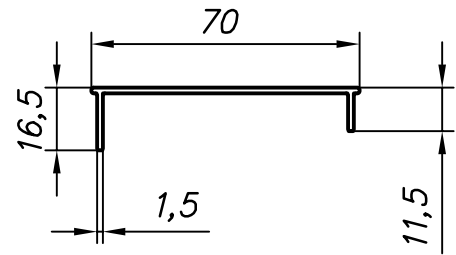

$F = 142\text{mm}^2$
 $G = 0,384\text{kg/m}$

500-3643

Мк: -270
бр. кан.-1

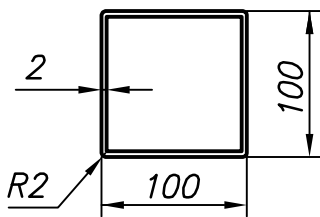

$F = 781\text{mm}^2$
 $G = 2,108\text{kg/m}$

500-3639

Мк: -130
бр. кан.-4

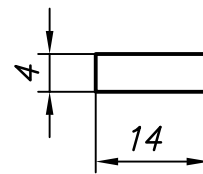

$F = 56\text{mm}^2$
 $G = 0,151\text{kg/m}$

500-3644

Мк: -230
бр. кан.-1

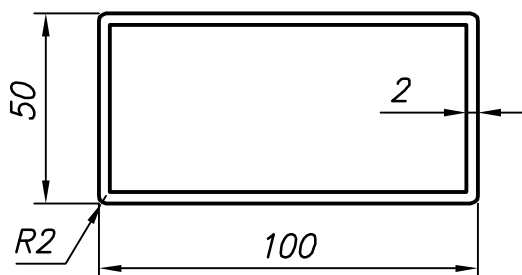

$F = 581\text{mm}^2$
 $G = 1,568\text{kg/m}$

500-3640

Мк: -270
бр. кан.-2

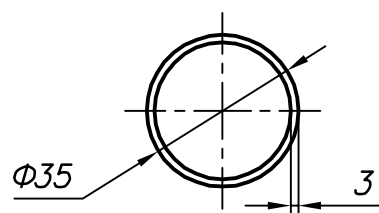

$F = 302\text{mm}^2$
 $G = 0,814\text{kg/m}$

500-3645

Мк: -230
бр. кан.-2
оп. п.

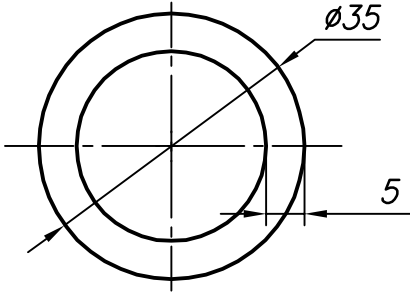

$F = 471 \text{ mm}^2$
 $G = 1,272 \text{ kg/m}$

500-3646

Мк: -170
бр. кан.-1
подл.
оп. п.

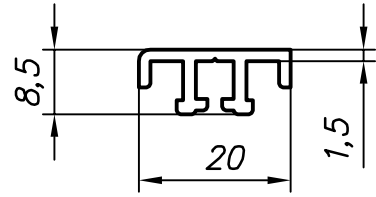

$F = 70 \text{ mm}^2$
 $G = 0,189 \text{ kg/m}$

500-3651

Мк: -170
бр. кан.-1

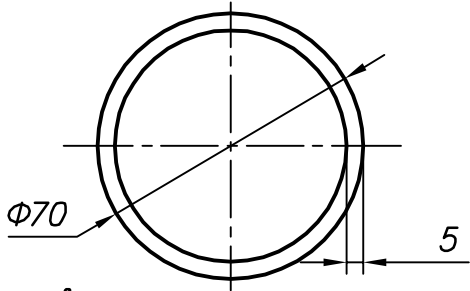

$F = 1021 \text{ mm}^2$
 $G = 2,757 \text{ kg/m}$

500-3647

Мк: -170
бр. кан.-1
подл.
оп. п.

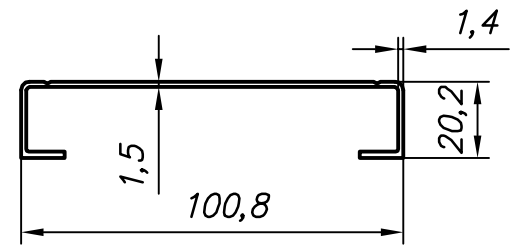

$F = 235 \text{ mm}^2$
 $G = 0,634 \text{ kg/m}$

500-3652

Мк: -200
бр. кан.-4
оп. п.

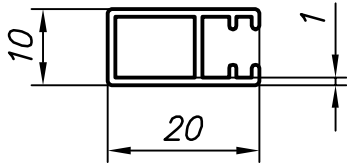

$F = 62 \text{ mm}^2$
 $G = 0,168 \text{ kg/m}$

500-3648

Мк: -130
бр. кан.-2

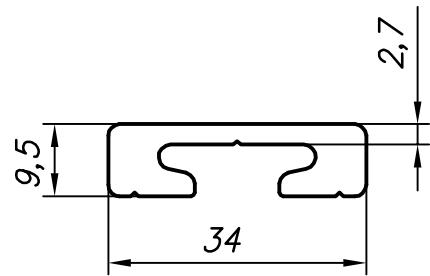

$F = 213 \text{ mm}^2$
 $G = 0,575 \text{ kg/m}$

500-3653

Мк: -170
бр. кан.-1
оп. п.

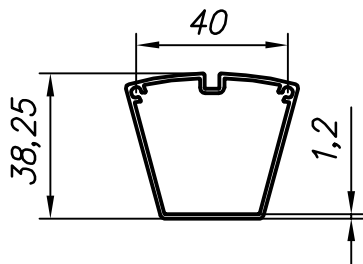

$F = 187 \text{ mm}^2$
 $G = 0,504 \text{ kg/m}$

500-3649

Мк: -200
бр. кан.-1
подл.
оп. п.

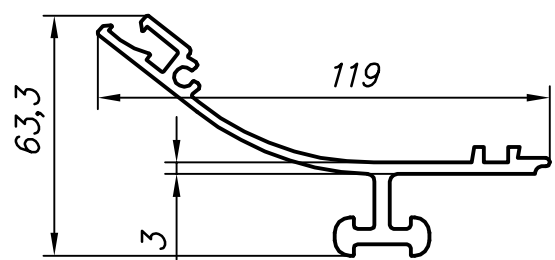

$F = 668 \text{ mm}^2$
 $G = 1,804 \text{ kg/m}$

500-3654

Мк: -170
бр. кан.-1
оп. п.

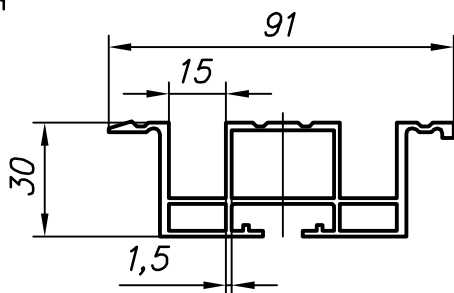

$F = 501 \text{ mm}^2$
 $G = 1,354 \text{ kg/m}$

500-3650

Мк: -270
бр. кан.-1
подл.
оп. п.

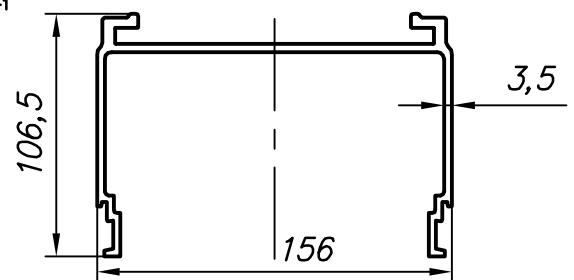

$F = 1511 \text{ mm}^2$
 $G = 4,080 \text{ kg/m}$

500-3655

Мк: -170
бр. кан.-1

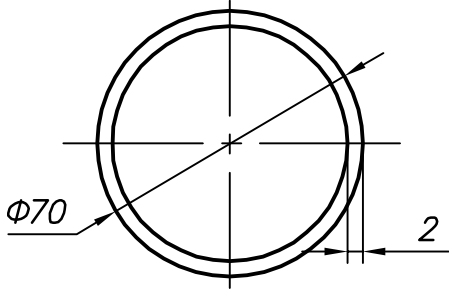

F= 472mm²
G=1,154kg/m

500-3656

Мк: -130
бр. кан.-1

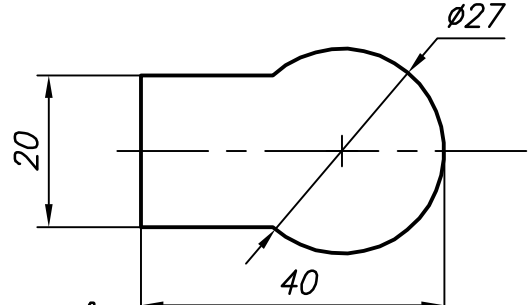

F= 860mm²
G=2,322kg/m

500-3661

Мк: -130
бр. кан.-4
подл.

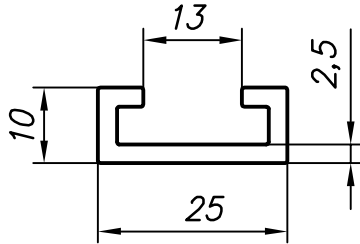

F= 117mm²
G=0,317kg/m

500-3657

Мк: -200
бр. кан.-2
оп.п.

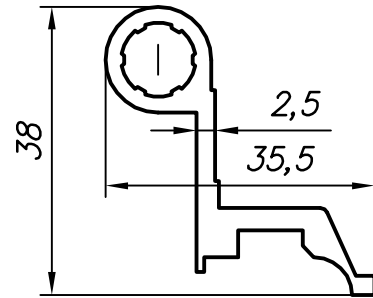

F= 230mm²
G=0,621kg/m

500-3662

Мк: -130
бр. кан.-2
подл.
оп.п.

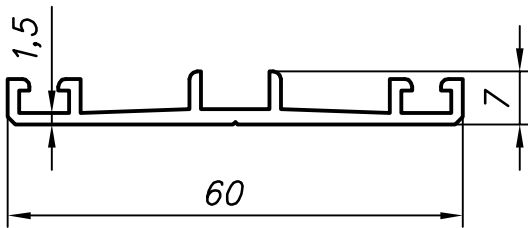

F= 151mm²
G=0,408kg/m

500-3658

Мк: -200
бр. кан.-2
оп.п.

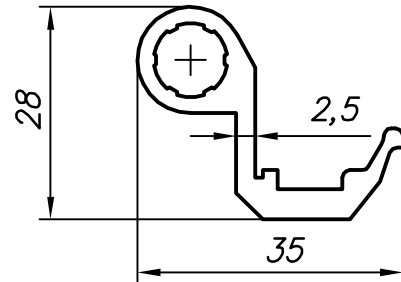

F= 219mm²
G=0,592kg/m

500-3663

Мк: -170
бр. кан.-1
оп.п.

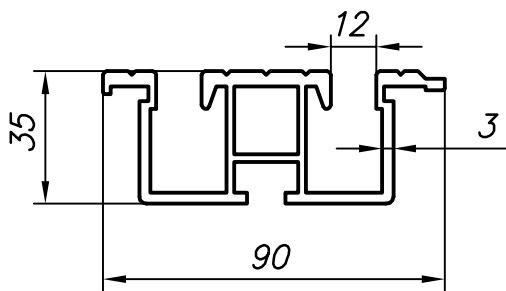

F= 768mm²
G=2,075kg/m

500-3659

Мк: -230
бр. кан.-1

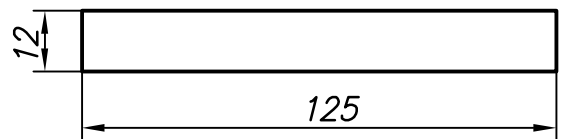

F=1500mm²
G=4,050kg/m

500-3664

Мк: -130
бр. кан.-1
подл.
оп.п.

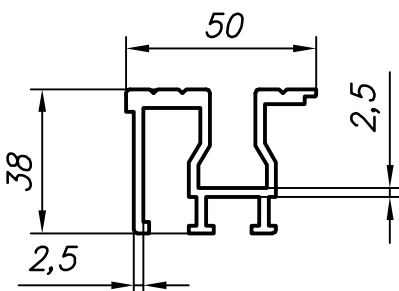

F= 485mm²
G=1,311kg/m

500-3660

Мк: -270
бр. кан.-1
подл.

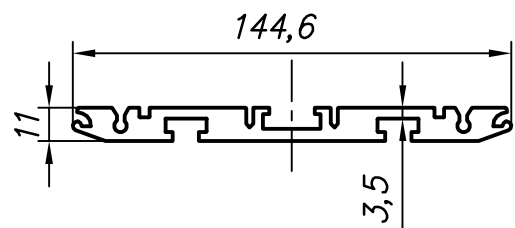

F=1103mm²
G=2,978kg/m

500-3665

Мк: -270
бр. кан.-1
подл.

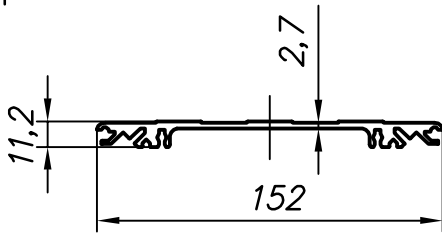

$F = 674 \text{ mm}^2$
 $G = 1,819 \text{ kg/m}$

500-3666

Мк: -130
бр. кан.-2

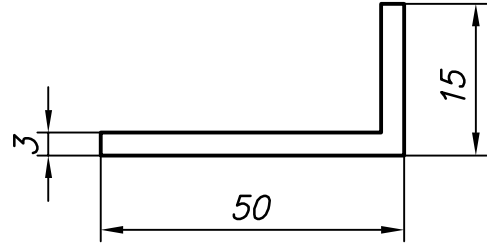

$F = 186 \text{ mm}^2$
 $G = 0,502 \text{ kg/m}$

500-3671

Мк: -170
бр. кан.-1

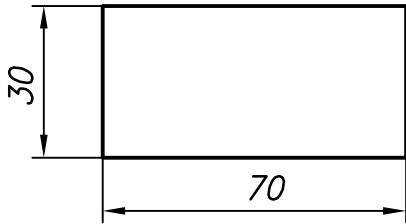

$F = 2100 \text{ mm}^2$
 $G = 5,670 \text{ kg/m}$

500-3667

Мк: -170
бр. кан.-2

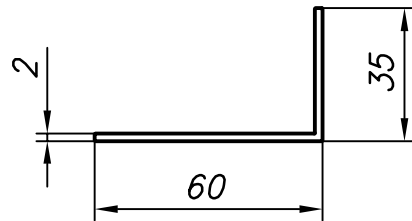

$F = 186 \text{ mm}^2$
 $G = 0,502 \text{ kg/m}$

500-3672

Мк: -200
бр. кан.-4

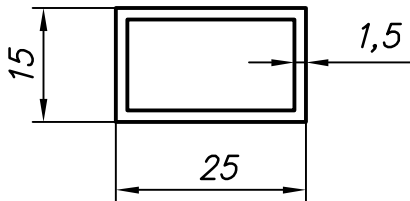

$F = 111 \text{ mm}^2$
 $G = 0,300 \text{ kg/m}$

500-3668

Мк: -270
бр. кан.-1

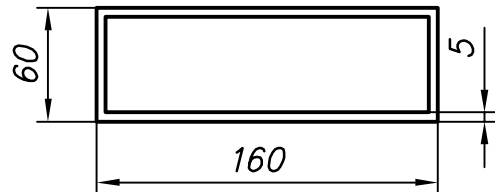

$F = 2100 \text{ mm}^2$
 $G = 5,670 \text{ kg/m}$

500-3673

Мк: -170
бр. кан.-1
подл.
оп.п.

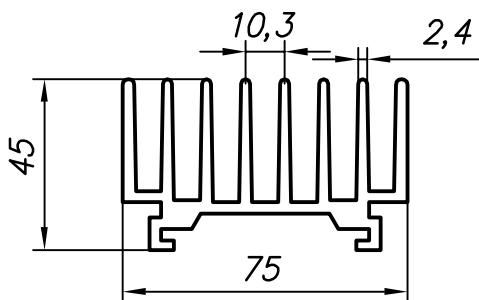

$F = 1131 \text{ mm}^2$
 $G = 3,054 \text{ kg/m}$

500-3669

Мк: -170
бр. кан.-1

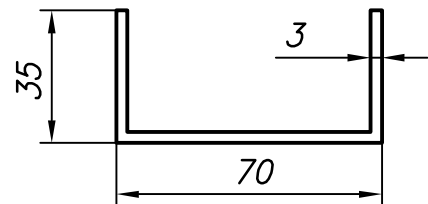

$F = 402 \text{ mm}^2$
 $G = 1,085 \text{ kg/m}$

500-3674

Мк: -130
бр. кан.-2

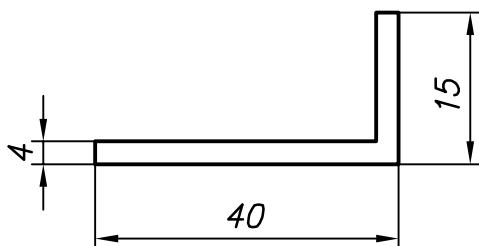

$F = 204 \text{ mm}^2$
 $G = 0,551 \text{ kg/m}$

500-3670

Мк: -270
бр. кан.-1

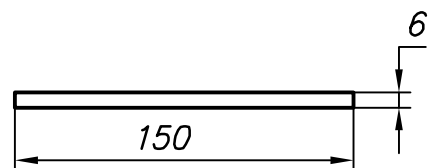

$F = 900 \text{ mm}^2$
 $G = 2,430 \text{ kg/m}$

500-3675

Мк: -170
бр. кан.-1

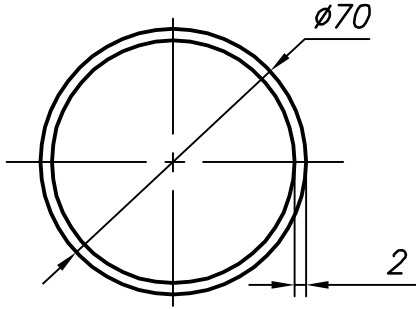

$F = 465\text{mm}^2$
 $G = 1,255\text{kg/m}$

500-3676

Мк: -200
бр. кан.-2
подл.

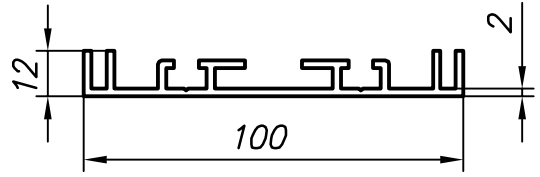

$F = 395\text{mm}^2$
 $G = 1,066\text{kg/m}$

500-3681

Мк: -200
бр. кан.-4
оп. п.

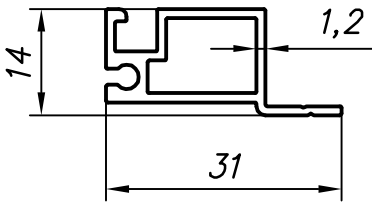

$F = 106\text{mm}^2$
 $G = 0,286\text{kg/m}$

500-3677

Мк: -130
бр. кан.-4
подл.

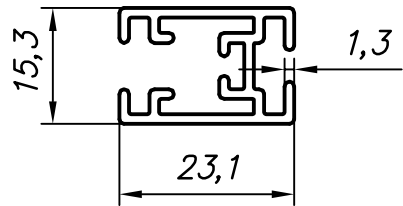

$F = 122\text{mm}^2$
 $G = 0,329\text{kg/m}$

500-3682

Мк: -170
бр. кан.-1

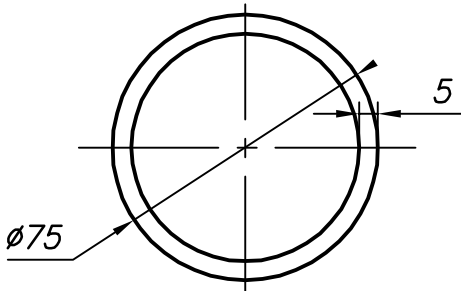

$F = 1100\text{mm}^2$
 $G = 2,969\text{kg/m}$

500-3678

Мк: -170
бр. кан.-1
подл.
оп. п.

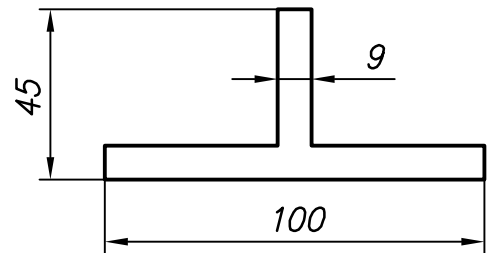

$F = 1224\text{mm}^2$
 $G = 3,305\text{kg/m}$

500-3683

Мк: -130
бр. кан.-2
подл.

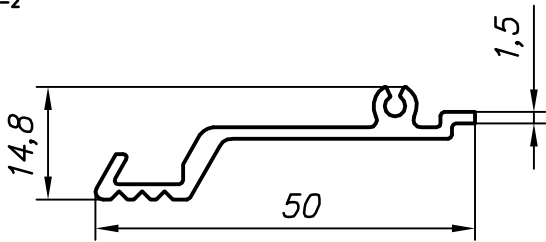

$F = 124\text{mm}^2$
 $G = 0,334\text{kg/m}$

500-3679

Мк: -170
бр. кан.-1
подл.

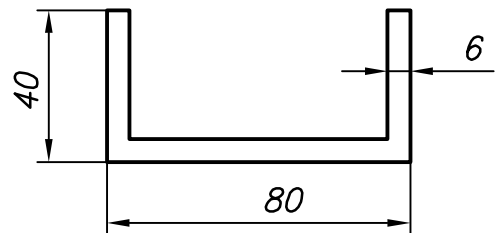

$F = 888\text{mm}^2$
 $G = 2,298\text{kg/m}$

500-3684

Мк: -170
бр. кан.-2

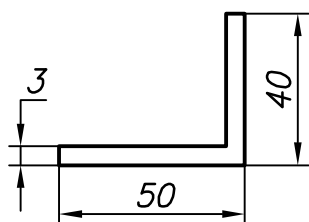

$F = 261\text{mm}^2$
 $G = 0,705\text{kg/m}$

500-3680

Мк: -130
бр. кан.-1

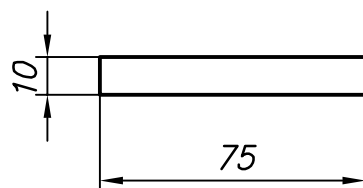

$F = 750\text{mm}^2$
 $G = 2,025\text{kg/m}$

500-3685

Мк: -170
бр. кан.-2

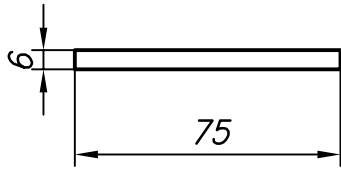

$F = 450\text{mm}^2$
 $G = 1,215\text{kg/m}$

500-3686

Мк: -130
бр. кан.-1

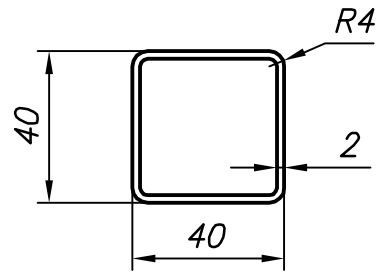

$F = 294\text{mm}^2$
 $G = 0,793\text{kg/m}$

500-3691

Мк: -170
бр. кан.-2
подл.
оп.п.

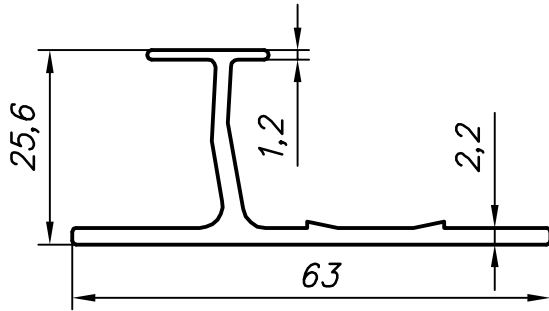

$F = 216\text{mm}^2$
 $G = 0,584\text{kg/m}$

500-3687

Мк: -130
бр. кан.-1

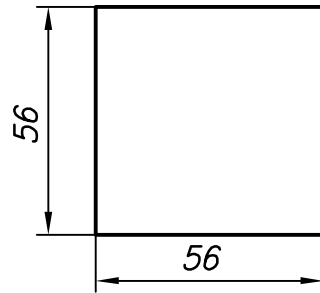

$F = 3136\text{mm}^2$
 $G = 8,467\text{kg/m}$

500-3692

Мк: -200
бр. кан.-4
подл.

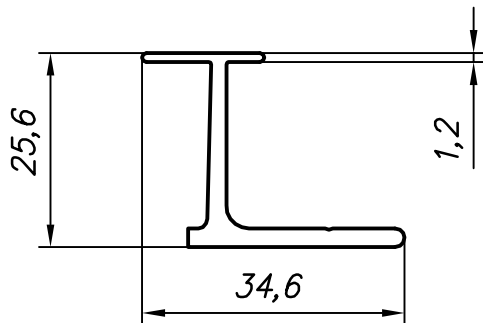

$F = 141\text{mm}^2$
 $G = 0,381\text{kg/m}$

500-3688

Мк: -230
бр. кан.-1

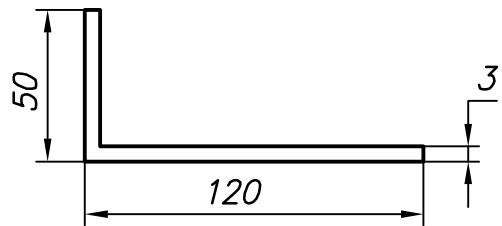

$F = 501\text{mm}^2$
 $G = 1,353\text{kg/m}$

500-3693

Мк: -200
бр. кан.-1
оп.п.

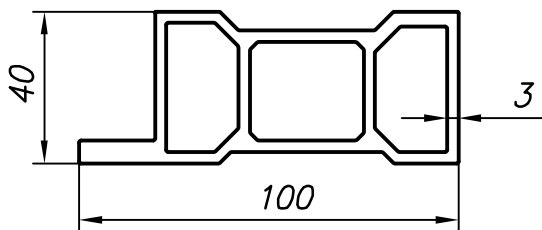

$F = 1022\text{mm}^2$
 $G = 2,759\text{kg/m}$

500-3689

Мк: -270
бр. кан.-1

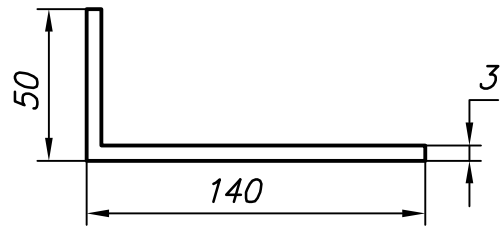

$F = 561\text{mm}^2$
 $G = 1,515\text{kg/m}$

500-3694

Мк: -170
бр. кан.-1
подл.

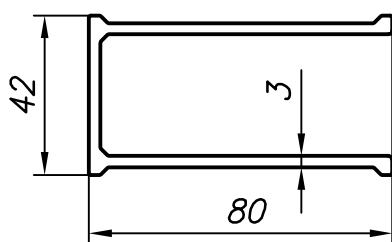

$F = 611\text{mm}^2$
 $G = 1,651\text{kg/m}$

500-3690

Мк: -170
бр. кан.-2

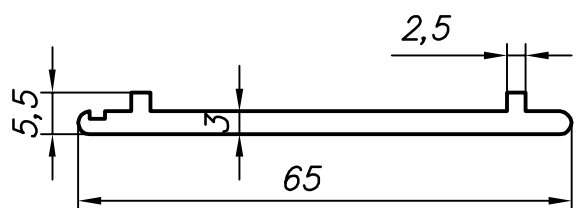

$F = 204\text{mm}^2$
 $G = 0,550\text{kg/m}$

500-3695

Мк: -130
бр. кан.-1

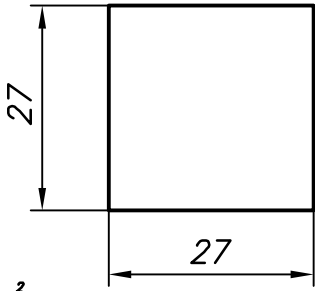

$F = 729 \text{ mm}^2$
 $G = 1,968 \text{ kg/m}$

500-3696

Мк: -130
бр. кан.-1

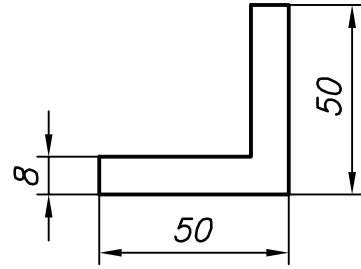

$F = 736 \text{ mm}^2$
 $G = 1,987 \text{ kg/m}$

500-3701

Мк: -130
бр. кан.-1

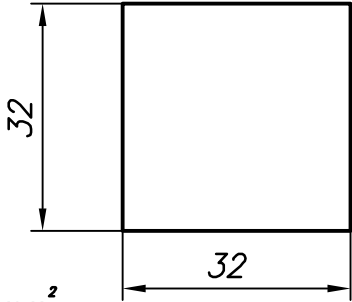

$F = 1024 \text{ mm}^2$
 $G = 2,764 \text{ kg/m}$

500-3697

Мк: -130
бр. кан.-1
оп. п.

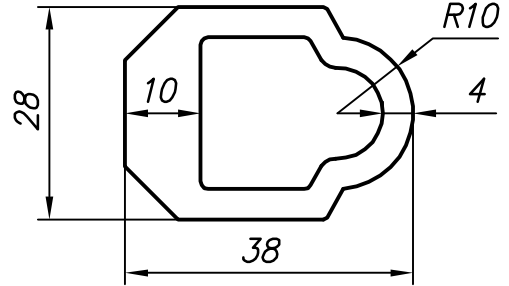

$F = 494 \text{ mm}^2$
 $G = 1,334 \text{ kg/m}$

500-3702

Мк: -230
бр. кан.-1

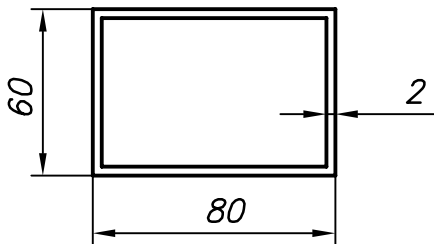

$F = 544 \text{ mm}^2$
 $G = 1,469 \text{ kg/m}$

500-3698

Мк: -170
бр. кан.-1
оп. п.

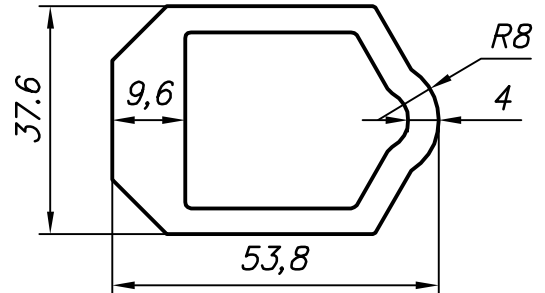

$F = 822 \text{ mm}^2$
 $G = 2,219 \text{ kg/m}$

500-3703

Мк: -170
бр. кан.-1

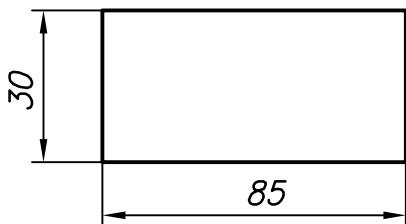

$F = 2550 \text{ mm}^2$
 $G = 6,885 \text{ kg/m}$

500-3699

Мк: -170
бр. кан.-1

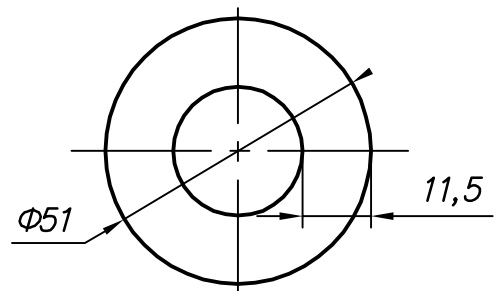

$F = 1420 \text{ mm}^2$
 $G = 3,853 \text{ kg/m}$

500-3704

Мк: -130
бр. кан.-1

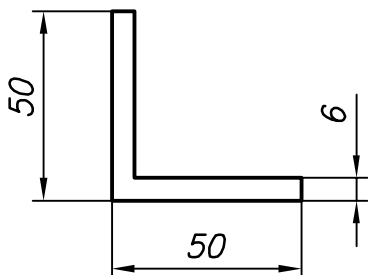

$F = 564 \text{ mm}^2$
 $G = 1,523 \text{ kg/m}$

500-3700

Мк: -130
бр. кан.-2
подл.

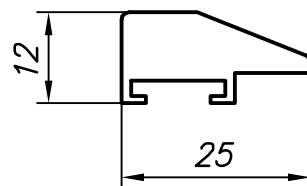

$F = 1376 \text{ mm}^2$
 $G = 1,048 \text{ kg/m}$

500-3705

Мк: -170
бр. кан.-1

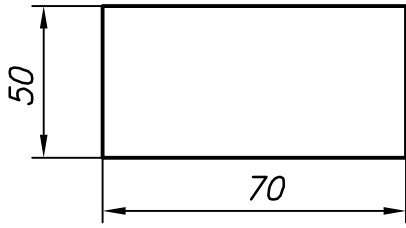

$F = 3500 \text{ mm}^2$
 $G = 9,450 \text{ kg/m}$

500-3706

Мк: -130
бр. кан.-1

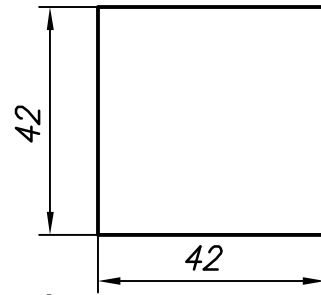

$F = 1764 \text{ mm}^2$
 $G = 4,763 \text{ kg/m}$

500-3711

Мк: -200
бр. кан.-2

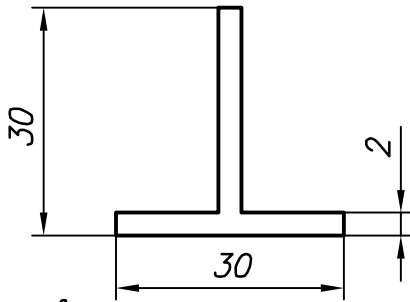

$F = 116 \text{ mm}^2$
 $G = 0,313 \text{ kg/m}$

500-3707

Мк: -270
бр. кан.-1
подл.

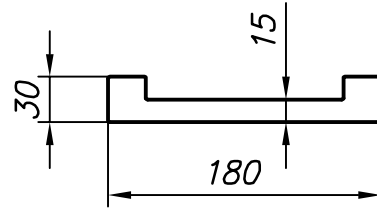

$F = 3449 \text{ mm}^2$
 $G = 9,313 \text{ kg/m}$

500-3712

Мк: -170
бр. кан.-2
оп.п.

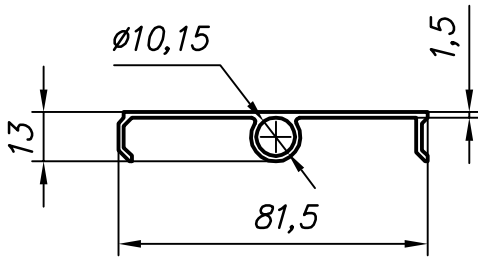

$F = 203 \text{ mm}^2$
 $G = 0,549 \text{ kg/m}$

500-3708

Мк: -270
бр. кан.-1
подл.
оп.п.

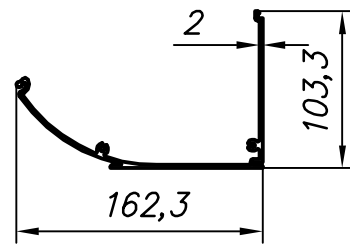

$F = 722 \text{ mm}^2$
 $G = 1,949 \text{ kg/m}$

500-3713

Мк: -200
бр. кан.-2

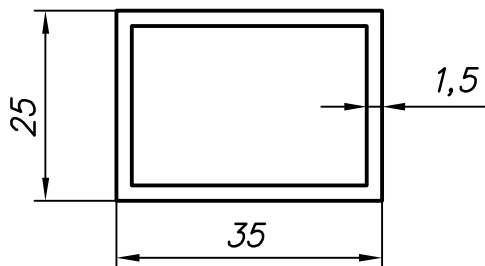

$F = 171 \text{ mm}^2$
 $G = 0,462 \text{ kg/m}$

500-3709

Мк: -270
бр. кан.-1
подл.
оп.п.

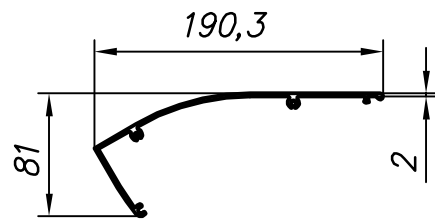

$F = 602 \text{ mm}^2$
 $G = 1,627 \text{ kg/m}$

500-3714

Мк: -130
бр. кан.-4

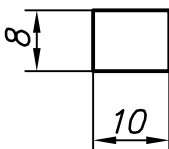

$F = 80 \text{ mm}^2$
 $G = 0,216 \text{ kg/m}$

500-3710

Мк: -200
бр. кан.-4

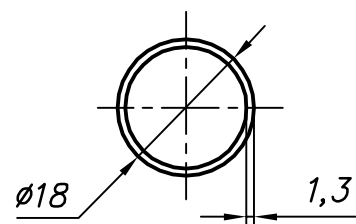

$F = 68 \text{ mm}^2$
 $G = 0,184 \text{ kg/m}$

500-3715

Мк: -270
бр. кан.-1

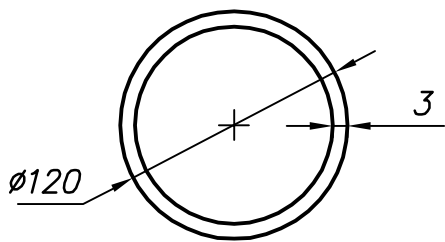

$F=1103\text{mm}^2$
 $G=2,977\text{kg/m}$

500-3716

Мк: -230
бр. кан.-2

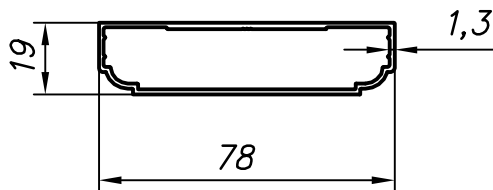

$F= 261\text{mm}^2$
 $G=0,706\text{kg/m}$

500-3721

Мк: -170
бр. кан.-1
подл.

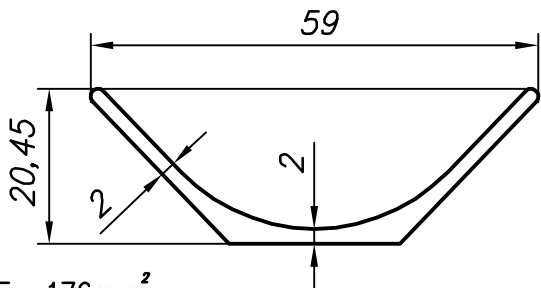

$F= 176\text{mm}^2$
 $G=5,130\text{kg/m}$

500-3717

Мк: -130
бр. кан.-2

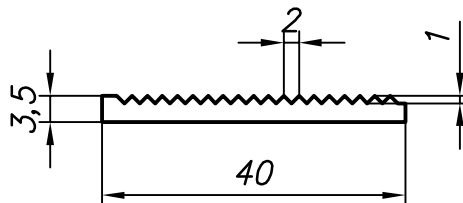

$F= 120\text{mm}^2$
 $G=0,325\text{kg/m}$

500-3722

Мк: -170
бр. кан.-1

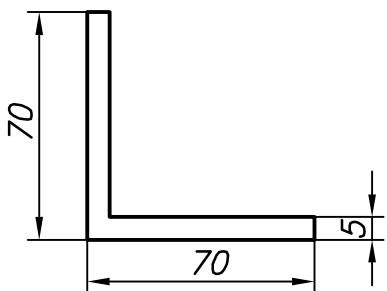

$F= 675\text{mm}^2$
 $G=1,823\text{kg/m}$

500-3718

Мк: -170
бр. кан.-1
подл.
оп.п.

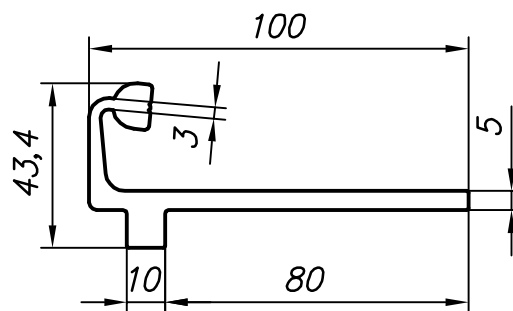

$F= 805\text{mm}^2$
 $G=2,174\text{kg/m}$

500-3723

Мк: -270
бр. кан.-1

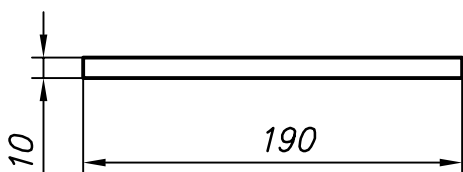

$F=1900\text{mm}^2$
 $G=2,108\text{kg/m}$

500-3719

Мк: -130
бр. кан.-1
подл.

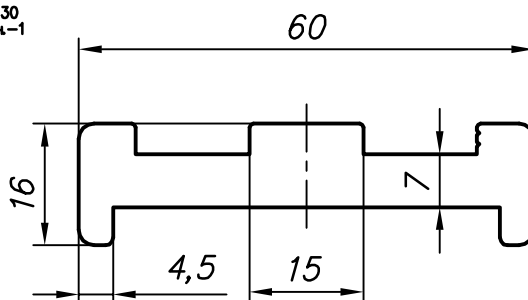

$F= 581\text{mm}^2$
 $G=1,568\text{kg/m}$

500-3724

Мк: -270
бр. кан.-1

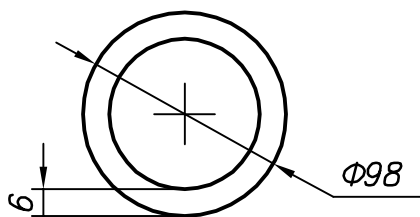

$F=1734\text{mm}^2$
 $G=4,682\text{kg/m}$

500-3720

Мк: -170
бр. кан.-2

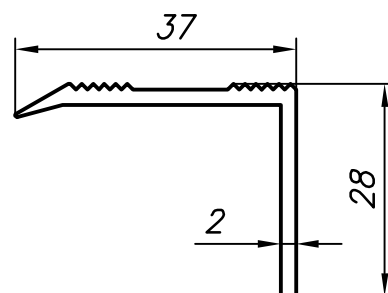

$F= 127\text{mm}^2$
 $G=0,343\text{kg/m}$

500-3725

Мк: -130
бр. кан.-1

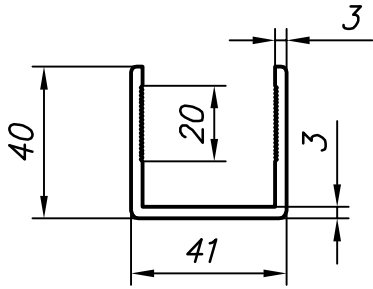

$F = 332\text{mm}^2$
 $G = 0,897\text{kg/m}$

500-3726

Мк: -130
бр. кан.-2
подл.
оп.п.

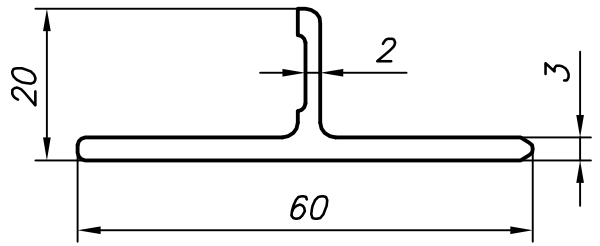

$F = 220\text{mm}^2$
 $G = 0,595\text{kg/m}$

500-3731

Мк: -270
бр. кан.-1

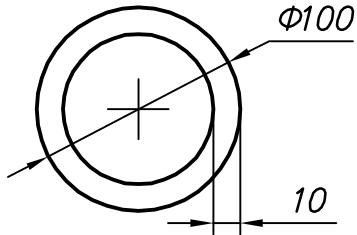

$F = 2827\text{mm}^2$
 $G = 7,634\text{kg/m}$

500-3727

Мк: -130
бр. кан.-2
подл.

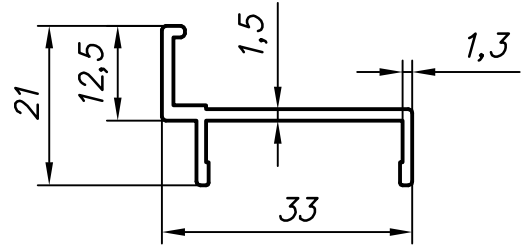

$F = 94\text{mm}^2$
 $G = 0,253\text{kg/m}$

500-3732

Мк: -170
бр. кан.-1

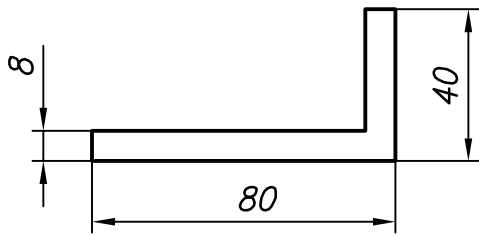

$F = 896\text{mm}^2$
 $G = 2,419\text{kg/m}$

500-3728

Мк: -130
бр. кан.-4
подл.

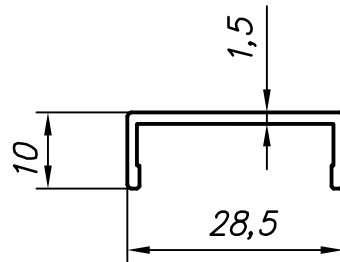

$F = 66\text{mm}^2$
 $G = 0,179\text{kg/m}$

500-3733

Мк: -230
бр. кан.-1

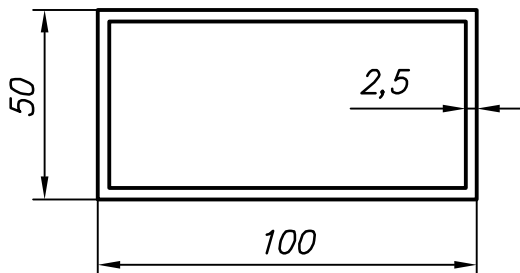

$F = 725\text{mm}^2$
 $G = 1,957\text{kg/m}$

500-3729

Мк: -270
бр. кан.-1
оп.п.

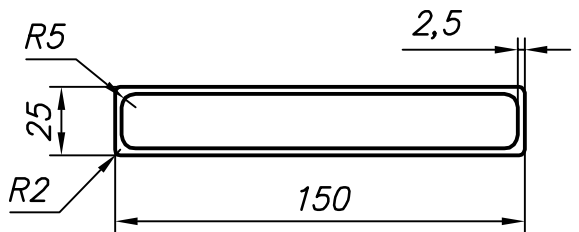

$F = 868\text{mm}^2$
 $G = 2,344\text{kg/m}$

500-3734

Мк: -200
бр. кан.-1

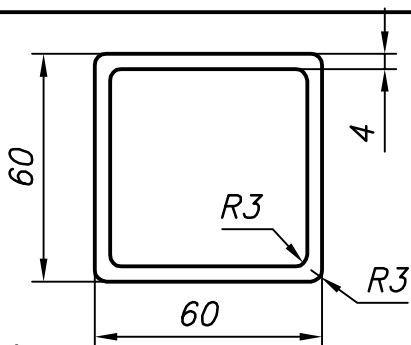

$F = 896\text{mm}^2$
 $G = 2,419\text{kg/m}$

500-3730

Мк: -130
бр. кан.-2
подл.

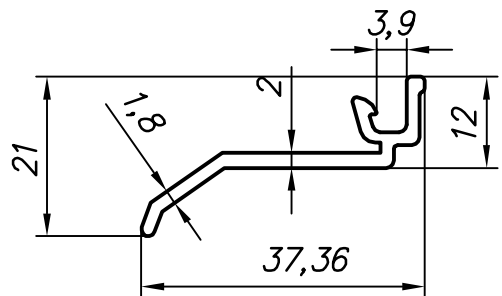

$F = 107\text{mm}^2$
 $G = 0,290\text{kg/m}$

500-3735

Мк: -130
бр. кан.-2
подл.

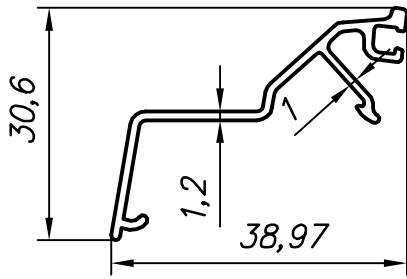

$F = 99 \text{ mm}^2$
 $G = 0,266 \text{ kg/m}$

500-3736

Мк: -170
бр. кан.-1

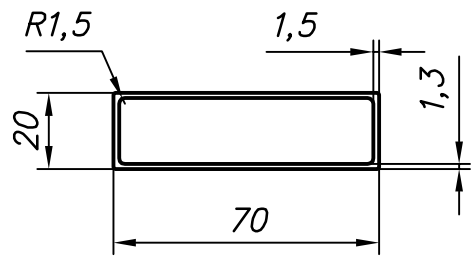

$F = 236 \text{ mm}^2$
 $G = 0,637 \text{ kg/m}$

500-3741

Мк: -230
бр. кан.-1
оп. п.

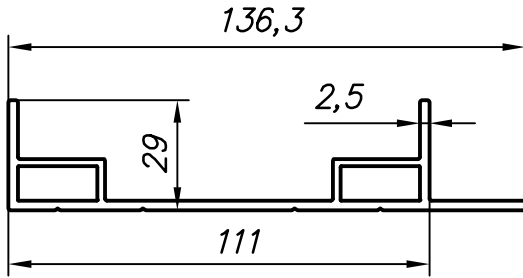

$F = 600 \text{ mm}^2$
 $G = 1,620 \text{ kg/m}$

500-3737

Мк: -200
бр. кан.-2

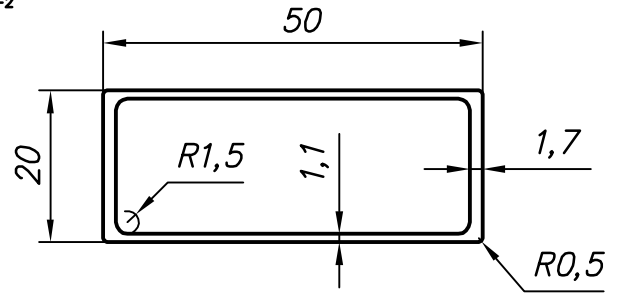

$F = 172 \text{ mm}^2$
 $G = 0,465 \text{ kg/m}$

500-3742

Мк: -200
бр. кан.-2
подл.

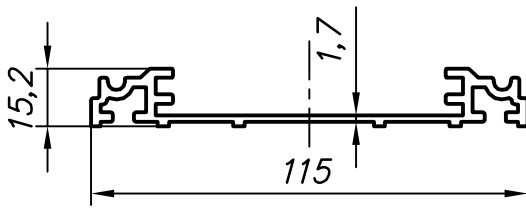

$F = 425 \text{ mm}^2$
 $G = 1,148 \text{ kg/m}$

500-3738

Мк: -130
бр. кан.-1
оп. п.

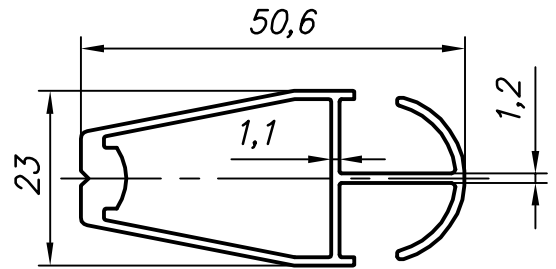

$F = 207 \text{ mm}^2$
 $G = 0,558 \text{ kg/m}$

500-3743

Мк: -170
бр. кан.-1
подл.

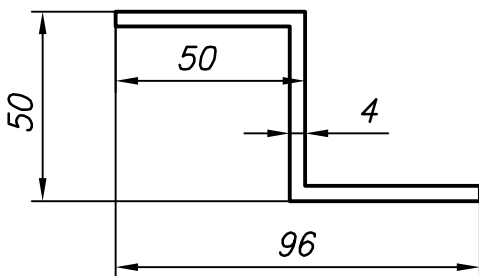

$F = 568 \text{ mm}^2$
 $G = 1,534 \text{ kg/m}$

500-3739

Мк: -170
бр. кан.-1

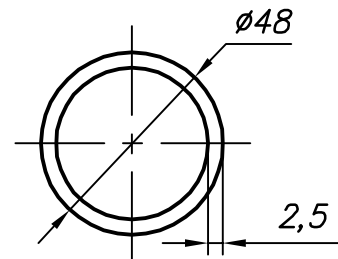

$F = 357 \text{ mm}^2$
 $G = 0,965 \text{ kg/m}$

500-3744

Мк: -270
бр. кан.-1
оп. п.

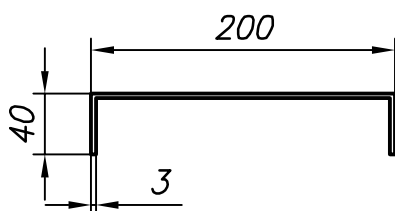

$F = 822 \text{ mm}^2$
 $G = 2,219 \text{ kg/m}$

500-3740

Мк: -170
бр. кан.-1

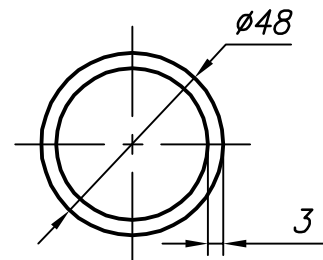

$F = 424 \text{ mm}^2$
 $G = 1,145 \text{ kg/m}$

500-3745

Мк: -130
бр. кан.-1
подл.

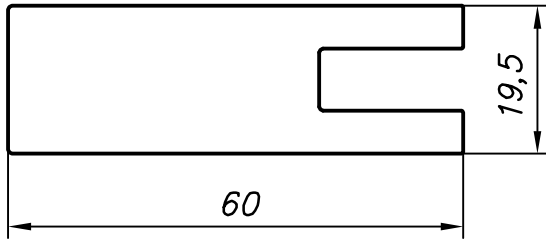

$F=1014\text{mm}^2$
 $G=2,738\text{kg/m}$

500-3746

Мк: -170
бр. кан.-1

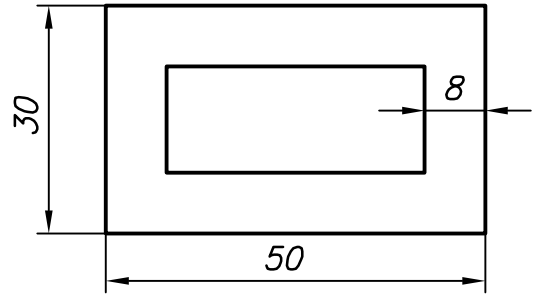

$F=1024\text{mm}^2$
 $G=2,765\text{kg/m}$

500-3751

Мк: -130
бр. кан.-1

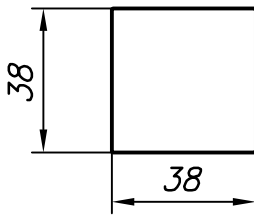

$F=1444\text{mm}^2$
 $G=3,898\text{kg/m}$

500-3747

Мк: -200
бр. кан.-1
оп. л.

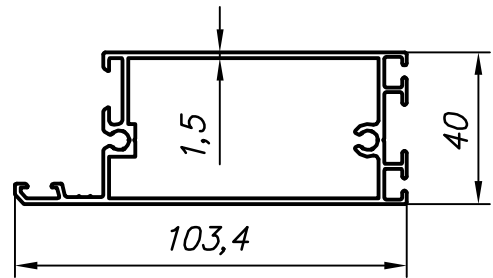

$F=497\text{mm}^2$
 $G=1,343\text{kg/m}$

500-3752

Мк: -130
бр. кан.-1

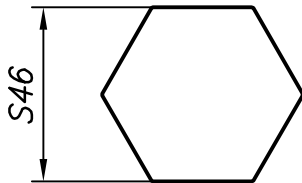

$F=1832\text{mm}^2$
 $G=4,948\text{kg/m}$

500-3748

Мк: -200
бр. кан.-1
оп. л.

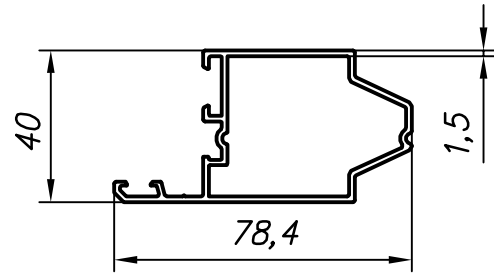

$F=336\text{mm}^2$
 $G=0,909\text{kg/m}$

500-3753

Мк: -170
бр. кан.-1

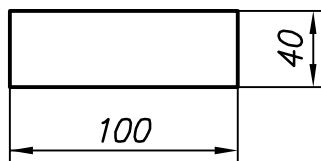

$F=4000\text{mm}^2$
 $G=10,80\text{kg/m}$

500-3749

Мк: -170
бр. кан.-1
оп. л.

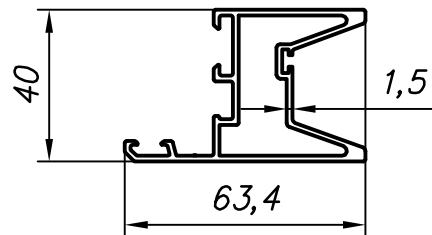

$F=367\text{mm}^2$
 $G=0,992\text{kg/m}$

500-3754

Мк: -270
бр. кан.-1

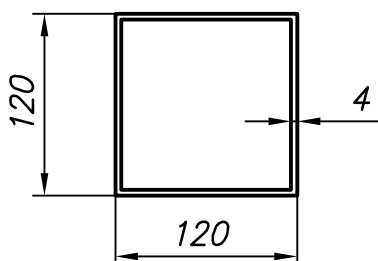

$F=1856\text{mm}^2$
 $G=5,011\text{kg/m}$

500-3750

Мк: -200
бр. кан.-4
оп. л.

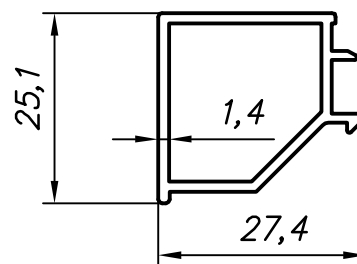

$F=127\text{mm}^2$
 $G=0,343\text{kg/m}$

500-3755

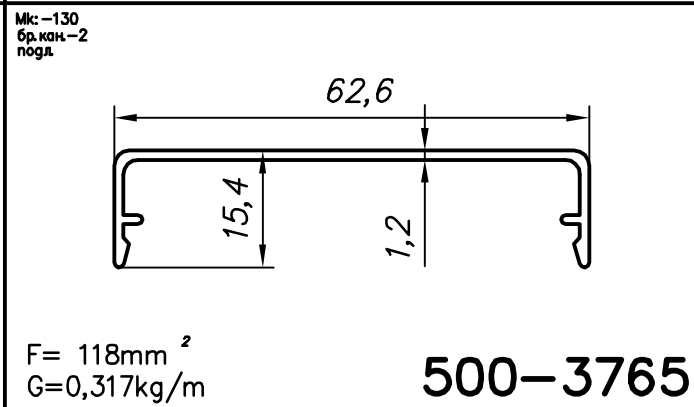
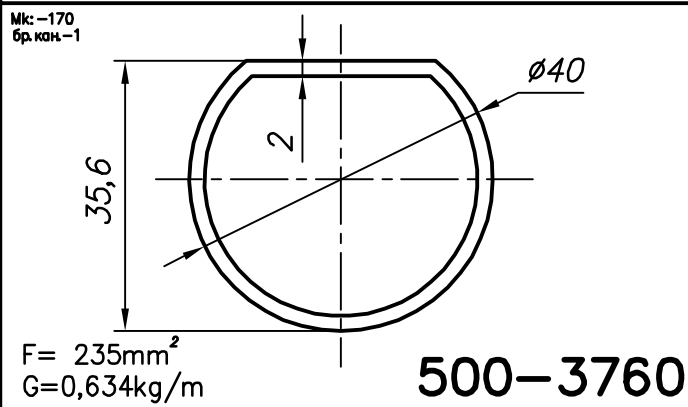
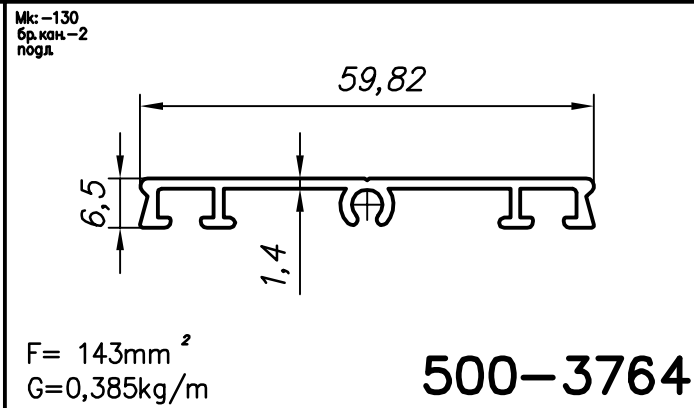
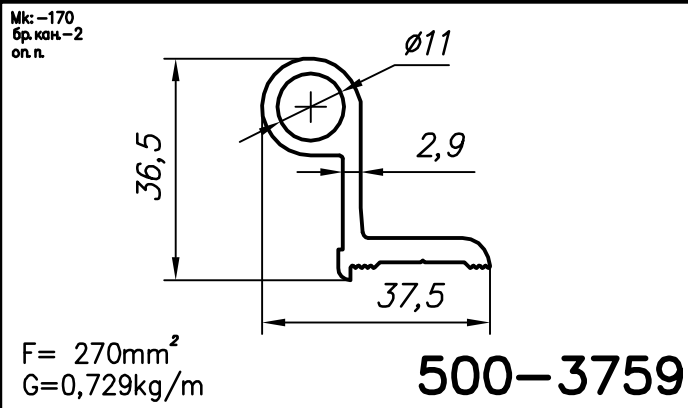
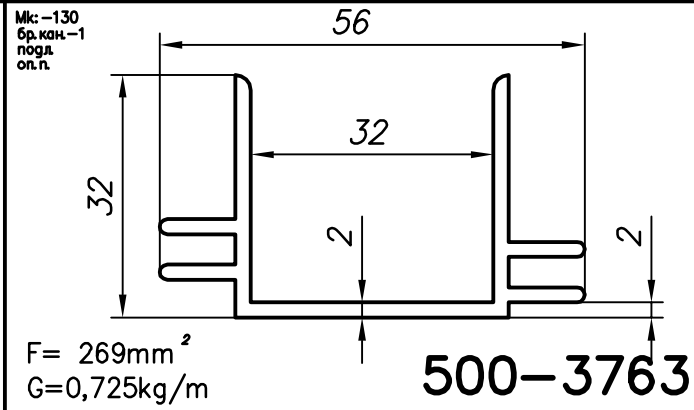
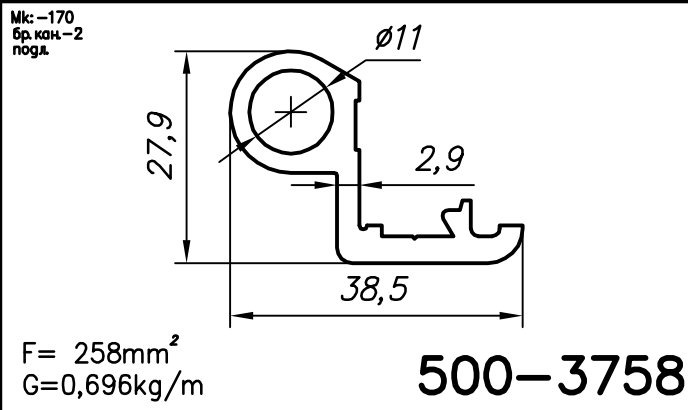
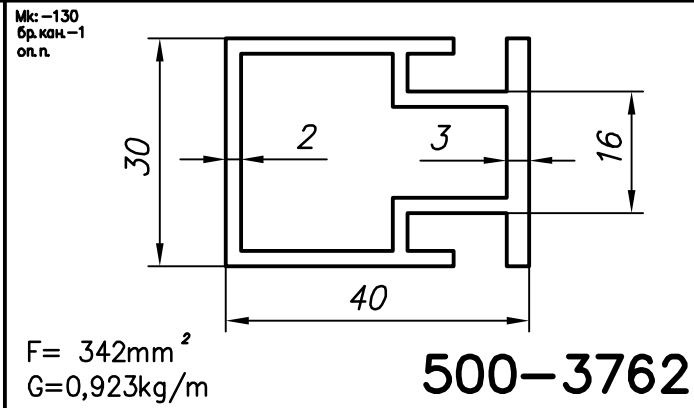
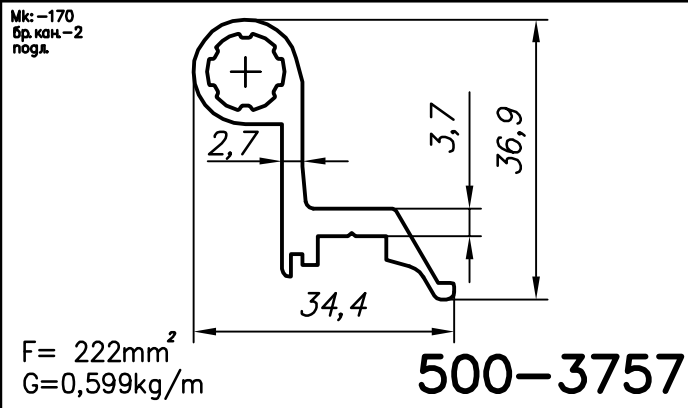
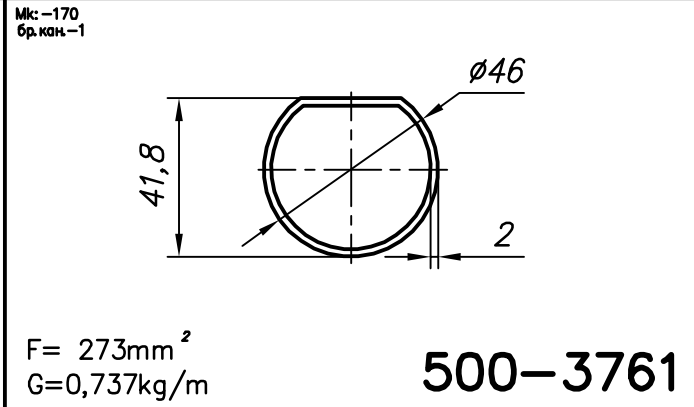
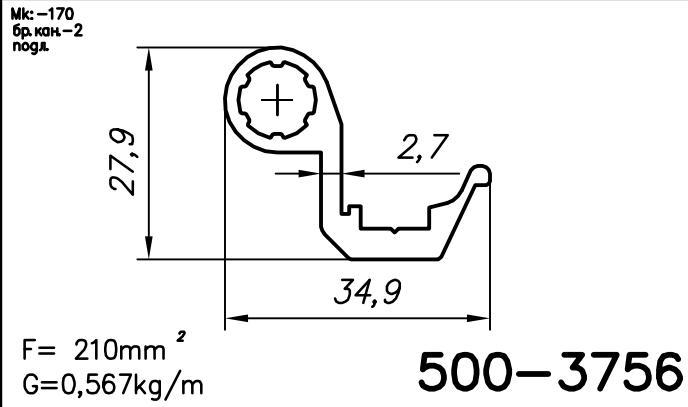

Мк: -130
бр. кан.-4

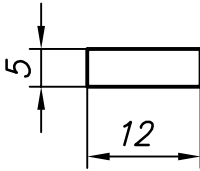

$F = 60 \text{ mm}^2$
 $G = 0,162 \text{ kg/m}$

500-3766

Мк: -230
бр. кан.-2

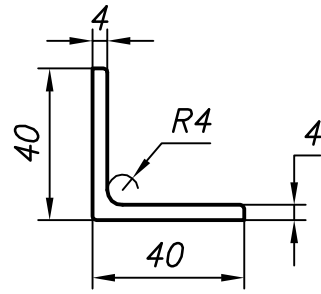

$F = 307 \text{ mm}^2$
 $G = 0,828 \text{ kg/m}$

500-3771

Мк: -170
бр. кан.-1

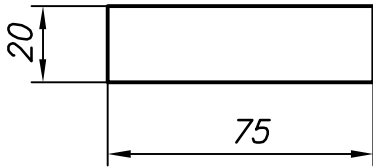

$F = 1500 \text{ mm}^2$
 $G = 4,050 \text{ kg/m}$

500-3767

Мк: -170
бр. кан.-1
подл.
оп.п.

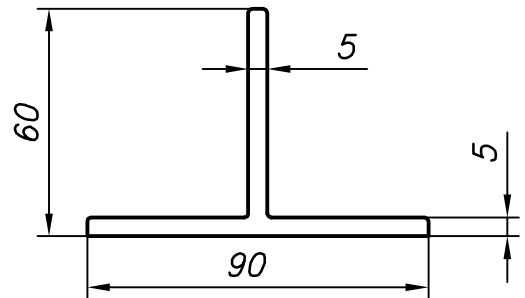

$F = 725 \text{ mm}^2$
 $G = 1,956 \text{ kg/m}$

500-3772

Мк: -170
бр. кан.-2

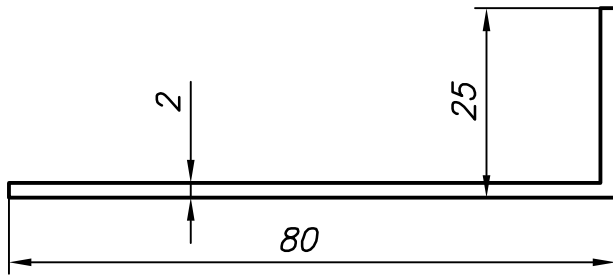

$F = 206 \text{ mm}^2$
 $G = 0,556 \text{ kg/m}$

500-3768

Мк: -130
бр. кан.-1
оп.п.

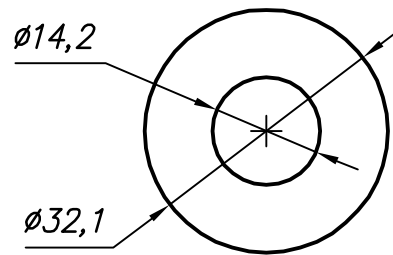

$F = 646 \text{ mm}^2$
 $G = 1,744 \text{ kg/m}$

500-3773

Мк: -130
бр. кан.-1
оп.п.

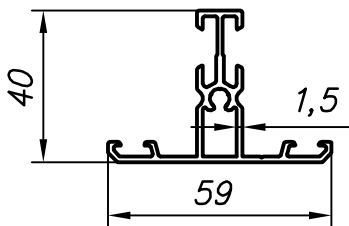

$F = 268 \text{ mm}^2$
 $G = 0,724 \text{ kg/m}$

500-3769

Мк: -130
бр. кан.-1
оп.п.

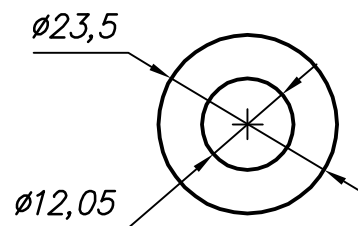

$F = 323 \text{ mm}^2$
 $G = 0,872 \text{ kg/m}$

500-3774

Мк: -130
бр. кан.-4

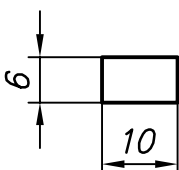

$F = 60 \text{ mm}^2$
 $G = 0,162 \text{ kg/m}$

500-3770

Мк: -130
бр. кан.-1
оп.п.

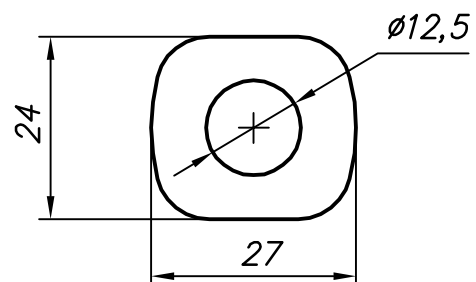

$F = 459 \text{ mm}^2$
 $G = 1,240 \text{ kg/m}$

500-3775

Мк: -200
бр. кан.-1
оп. п.

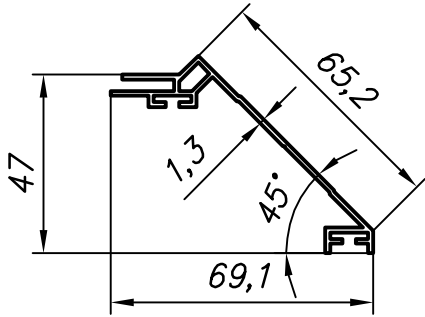

$F = 206\text{mm}^2$
 $G = 0,557\text{kg/m}$

500-3776

Мк: -130
бр. кан.-2

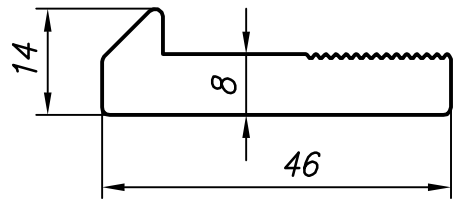

$F = 389\text{mm}^2$
 $G = 1,050\text{kg/m}$

500-3781

Мк: -270
бр. кан.-1

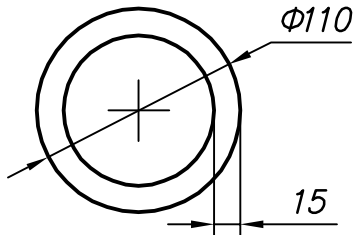

$F = 4477\text{mm}^2$
 $G = 12,10\text{kg/m}$

500-3777

Мк: -130
бр. кан.-1
оп. п.

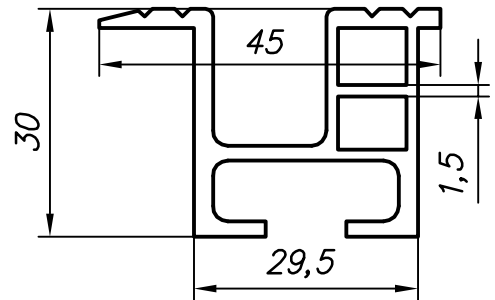

$F = 302\text{mm}^2$
 $G = 0,876\text{kg/m}$

500-3782

Мк: -170
бр. кан.-1

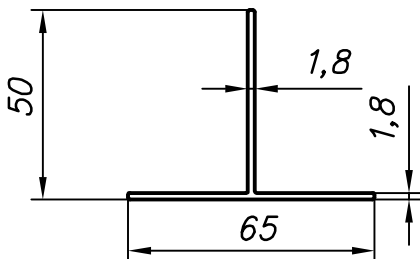

$F = 203\text{mm}^2$
 $G = 0,550\text{kg/m}$

500-3778

Мк: -170
бр. кан.-2
оп. п.

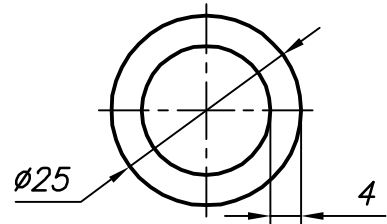

$F = 264\text{mm}^2$
 $G = 0,713\text{kg/m}$

500-3783

Мк: -170
бр. кан.-1

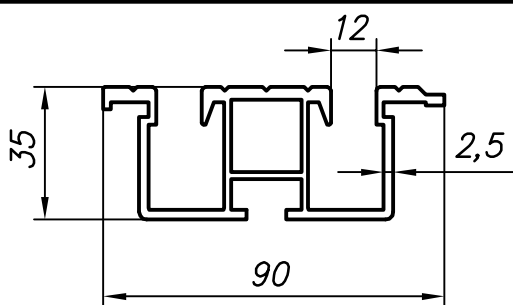

$F = 695\text{mm}^2$
 $G = 1,876\text{kg/m}$

500-3779

Мк: -230
бр. кан.-1
оп. п.

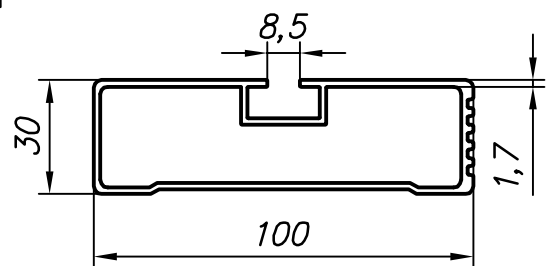

$F = 507\text{mm}^2$
 $G = 1,369\text{kg/m}$

500-3784

Мк: -270
бр. кан.-1

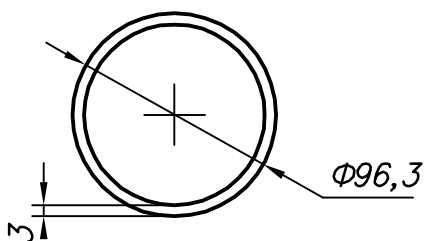

$F = 879\text{mm}^2$
 $G = 2,374\text{kg/m}$

500-3780

Мк: -200
бр. кан.-4
оп. п.

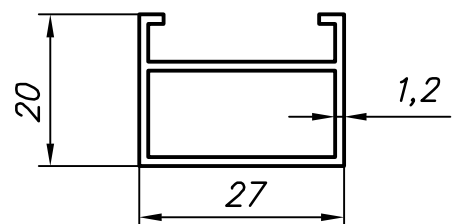

$F = 112\text{mm}^2$
 $G = 0,302\text{kg/m}$

500-3785

Мк: -230
бр. кан.-1
оп.п.

$F=1209\text{mm}^2$
 $G=3,264\text{kg/m}$

500-3786

Мк: -170
бр. кан.-1
оп.п.

$F= 477\text{mm}^2$
 $G=1,289\text{kg/m}$

500-3791

Мк: -130
бр. кан.-2
подл.

$F= 180\text{mm}^2$
 $G=0,487\text{kg/m}$

500-3787

Мк: -170
бр. кан.-1
подл.
оп.п.

$F= 602\text{mm}^2$
 $G=1,627\text{kg/m}$

500-3792

Мк: -130
бр. кан.-2
подл.

$F= 251\text{mm}^2$
 $G=0,679\text{kg/m}$

500-3788

Мк: -270
бр. кан.-1
подл.
оп.п.

$F=1196\text{mm}^2$
 $G=3,230\text{kg/m}$

500-3793

Мк: -270
бр. кан.-1

$F=1618\text{mm}^2$
 $G=4,368\text{kg/m}$

500-3789

Мк: -270
бр. кан.-1
подл.
оп.п.

$F= 740\text{mm}^2$
 $G=1,998\text{kg/m}$

500-3794

Мк: -270
бр. кан.-1

$F= 879\text{mm}^2$
 $G=2,374\text{kg/m}$

500-3790

Мк: -130
бр. кан.-1
подл.
оп.п.

$F= 241\text{mm}^2$
 $G=0,650\text{kg/m}$

500-3795

Мк: -170
бр. кан.-1
оп.п.

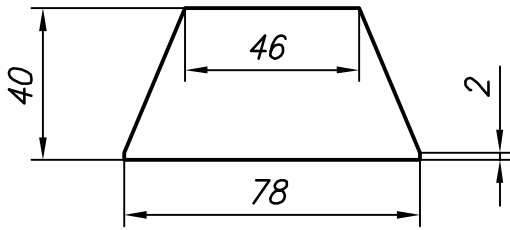

$F=2512\text{mm}^2$
 $G=6,782\text{kg/m}$

500-3796

Мк: -230
бр. кан.-1
оп.п.

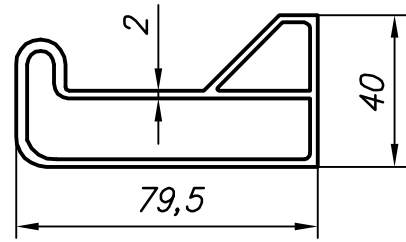

$F= 575\text{mm}^2$
 $G=1,552\text{kg/m}$

500-3801

Мк: -200
бр. кан.-1
оп.п.

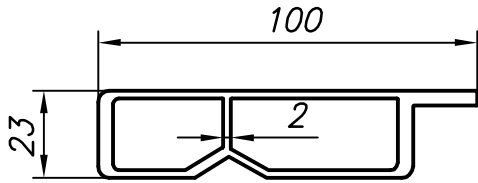

$F= 592\text{mm}^2$
 $G=1,598\text{kg/m}$

500-3797

Мк: -130
бр. кан.-1
оп.п.

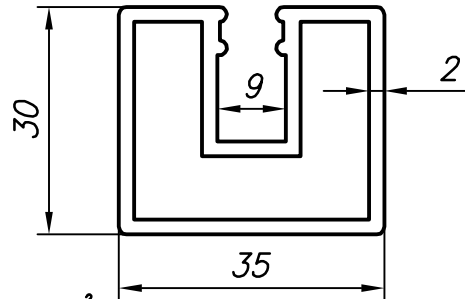

$F= 324\text{mm}^2$
 $G=0,874\text{kg/m}$

500-3802

Мк: -200
бр. кан.-1
оп.п.

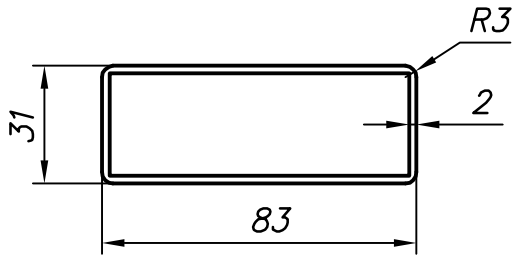

$F= 432\text{mm}^2$
 $G=1,167\text{kg/m}$

500-3798

Мк: -200
бр. кан.-4
оп.п.

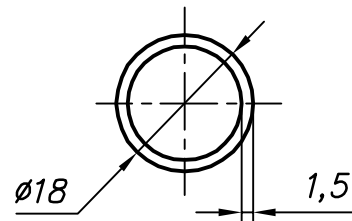

$F= 78 \text{mm}^2$
 $G=0,210\text{kg/m}$

500-3803

Мк: -170
бр. кан.-1
оп.п.

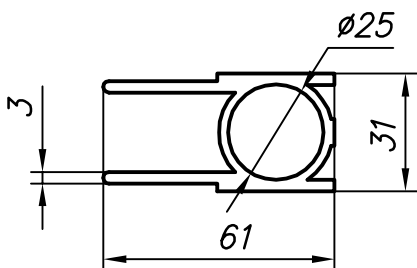

$F= 552\text{mm}^2$
 $G=1,490\text{kg/m}$

500-3799

Мк: -230
бр. кан.-1
оп.п.

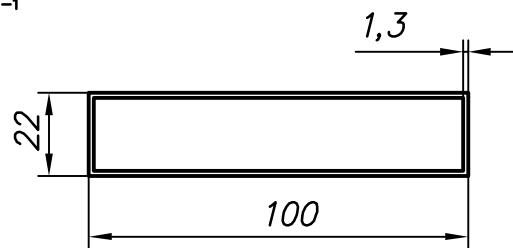

$F= 310\text{mm}^2$
 $G=0,838\text{kg/m}$

500-3804

Мк: -230
бр. кан.-1
оп.п.

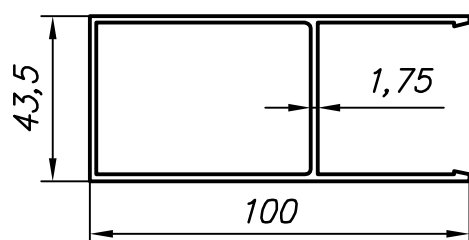

$F= 494\text{mm}^2$
 $G=1,334\text{kg/m}$

500-3800

Мк: -170
бр. кан.-1
оп.п.



$F= 688\text{mm}^2$
 $G=1,858\text{kg/m}$

500-3805

Мк: -170
бр. кан.-1
подл.
оп. п.

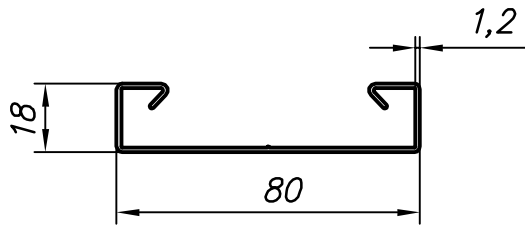

$F = 179 \text{ mm}^2$
 $G = 0,483 \text{ kg/m}$

500-3806

Мк: -170
бр. кан.-2
подл.

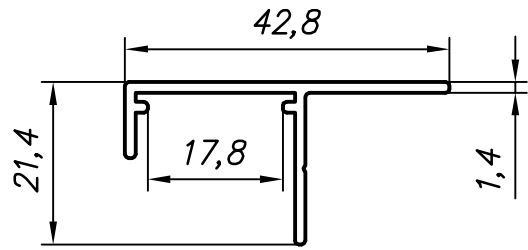

$F = 104 \text{ mm}^2$
 $G = 0,279 \text{ kg/m}$

500-3811

Мк: -130
бр. кан.-4

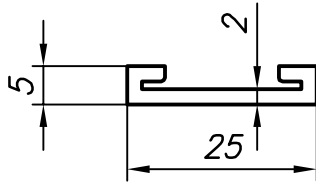

$F = 74 \text{ mm}^2$
 $G = 0,200 \text{ kg/m}$

500-3807

Мк: -270
бр. кан.-2

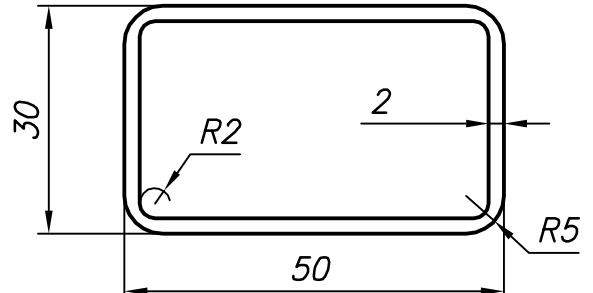

$F = 286 \text{ mm}^2$
 $G = 0,772 \text{ kg/m}$

500-3812

Мк: -170
бр. кан.-2
подл.

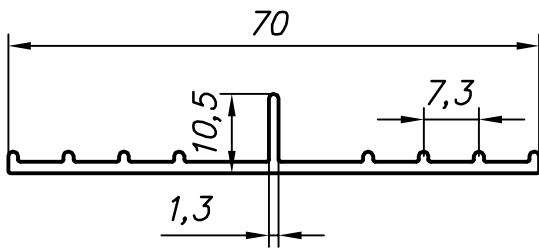

$F = 130 \text{ mm}^2$
 $G = 0,351 \text{ kg/m}$

500-3808

Мк: -170
бр. кан.-2

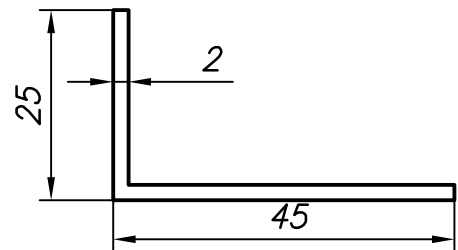

$F = 136 \text{ mm}^2$
 $G = 0,367 \text{ kg/m}$

500-3813

Мк: -230
бр. кан.-1

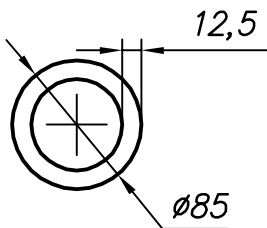

$F = 2847 \text{ mm}^2$
 $G = 7,687 \text{ kg/m}$

500-3809

Мк: -230
бр. кан.-1

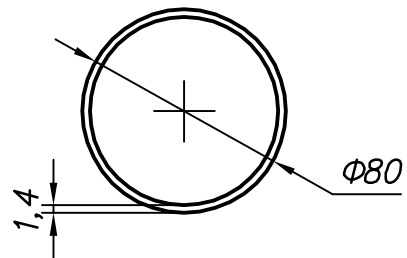

$F = 346 \text{ mm}^2$
 $G = 0,933 \text{ kg/m}$

500-3814

Мк: -130
бр. кан.-1

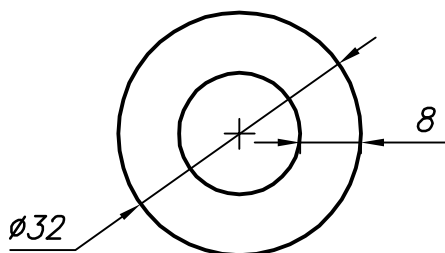

$F = 603 \text{ mm}^2$
 $G = 1,629 \text{ kg/m}$

500-3810

Мк: -130
бр. кан.-2
подл.

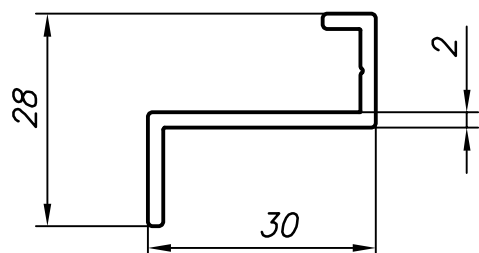

$F = 124 \text{ mm}^2$
 $G = 0,696 \text{ kg/m}$

500-3815

Мк: -170
бр. кан.-1
подл.
оп. п.

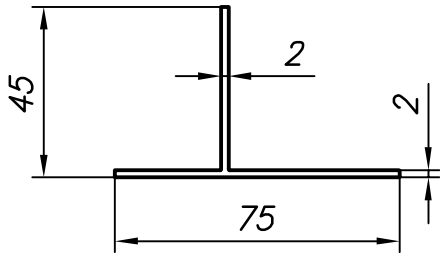

$F = 236\text{mm}^2$
 $G = 0,637\text{kg/m}$

500-3816

Мк: -170
бр. кан.-1
подл.

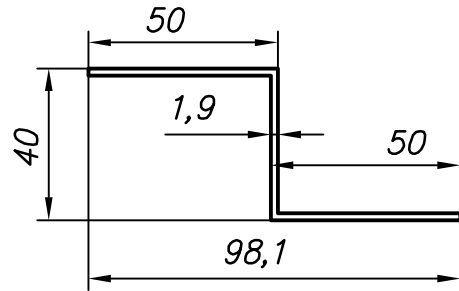

$F = 259\text{mm}^2$
 $G = 0,700\text{kg/m}$

500-3821

Мк: -170
бр. кан.-1
оп. п.

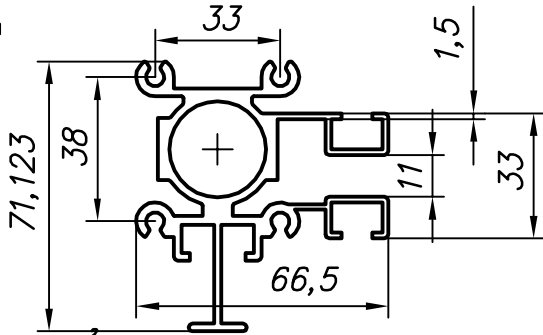

$F = 871\text{mm}^2$
 $G = 2,352\text{kg/m}$

500-3817

Мк: -130
бр. кан.-1

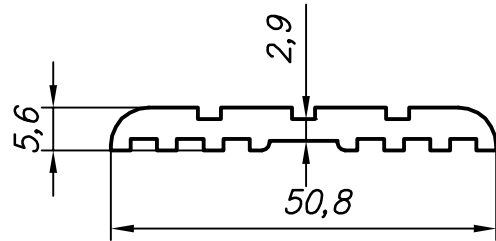

$F = 217\text{mm}^2$
 $G = 0,587\text{kg/m}$

500-3822

Мк: -130
бр. кан.-1
оп. п.

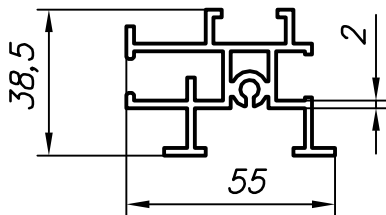

$F = 442\text{mm}^2$
 $G = 1,193\text{kg/m}$

500-3818

Мк: -173
бр. кан.-1
оп. п.

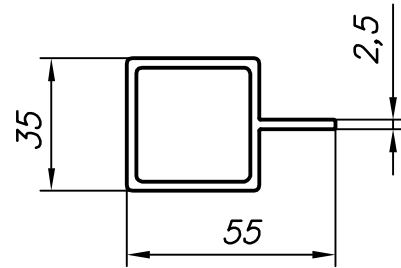

$F = 375\text{mm}^2$
 $G = 1,012\text{kg/m}$

500-3823

Мк: -170
бр. кан.-1
оп. п.

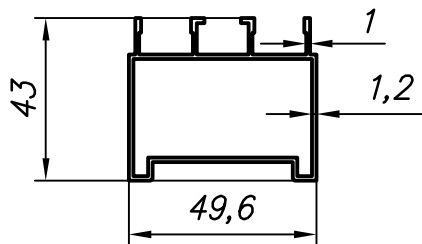

$F = 781\text{mm}^2$
 $G = 0,696\text{kg/m}$

500-3819

Мк: -130
бр. кан.-2

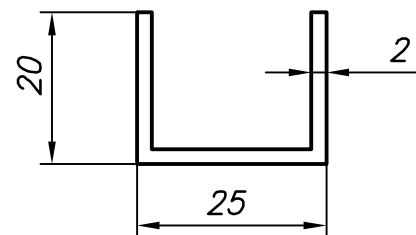

$F = 122\text{mm}^2$
 $G = 0,329\text{kg/m}$

500-3824

Мк: -230
бр. кан.-1
подл.
оп. п.

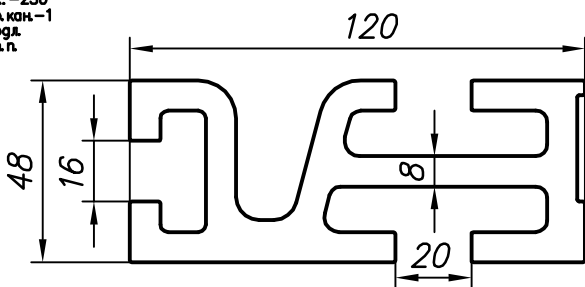

$F = 2818\text{mm}^2$
 $G = 7,610\text{kg/m}$

500-3820

Мк: -230
бр. кан.-1

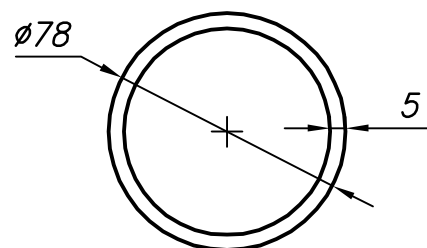

$F = 1147\text{mm}^2$
 $G = 3,096\text{kg/m}$

500-3825

Мк: -170
бр. кан.-2
оп. п.

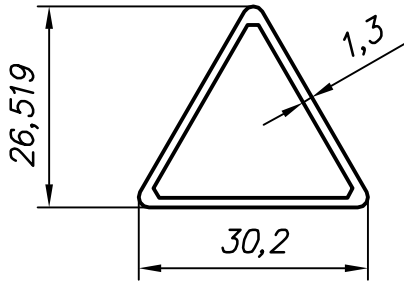

$F = 116 \text{ mm}^2$
 $G = 0,312 \text{ kg/m}$

500-3826

Мк: -200
бр. кан.-1
подл.
оп. п.

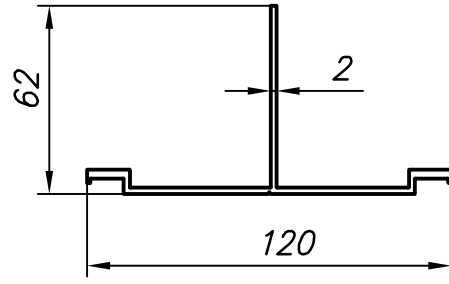

$F = 411 \text{ mm}^2$
 $G = 1,109 \text{ kg/m}$

500-3831

Мк: -130
бр. кан.-1
подл.

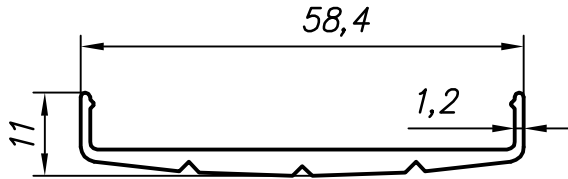

$F = 175 \text{ mm}^2$
 $G = 0,473 \text{ kg/m}$

500-3827

Мк: -170
бр. кан.-2
подл.

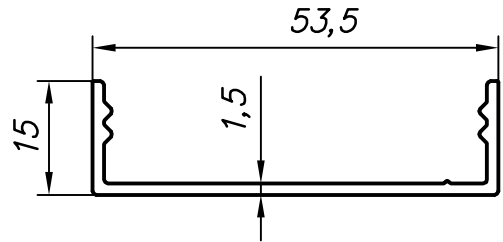

$F = 127 \text{ mm}^2$
 $G = 0,343 \text{ kg/m}$

500-3832

Мк: -170
бр. кан.-1
подл.
оп. п.

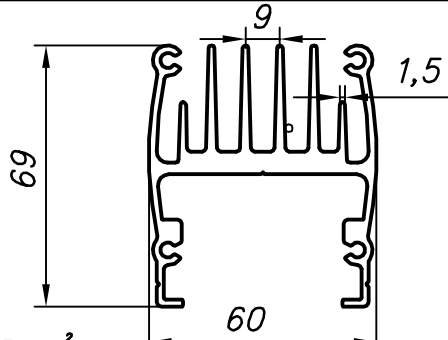

$F = 545 \text{ mm}^2$
 $G = 2,745 \text{ kg/m}$

500-3828

Мк: -130
бр. кан.-4

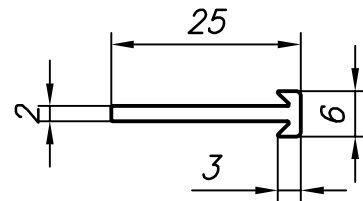

$F = 59 \text{ mm}^2$
 $G = 0,159 \text{ kg/m}$

500-3833

Мк: -170
бр. кан.-1
подл.
оп. п.

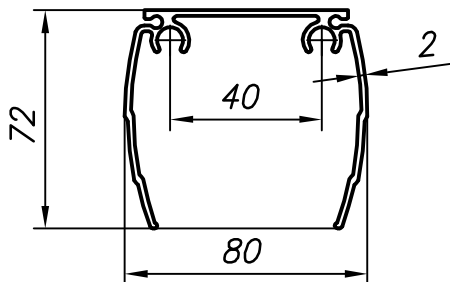

$F = 781 \text{ mm}^2$
 $G = 1,471 \text{ kg/m}$

500-3829

Мк: -200
бр. кан.-1
подл.

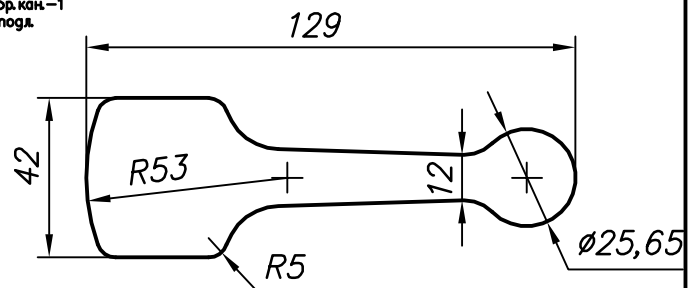

$F = 2998 \text{ mm}^2$
 $G = 8,096 \text{ kg/m}$

500-3834

Мк: -230
бр. кан.-1
подл.
оп. п.

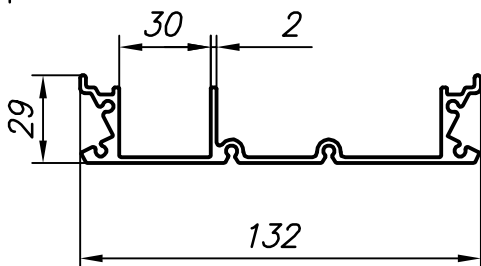

$F = 617 \text{ mm}^2$
 $G = 1,670 \text{ kg/m}$

500-3830

Мк: -130
бр. кан.-4
подл.

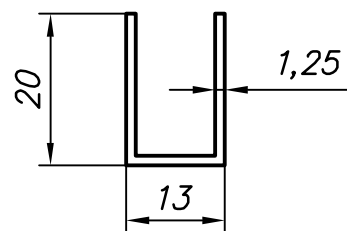

$F = 63 \text{ mm}^2$
 $G = 0,170 \text{ kg/m}$

500-3835

Мк: -130
бр. кан.-2

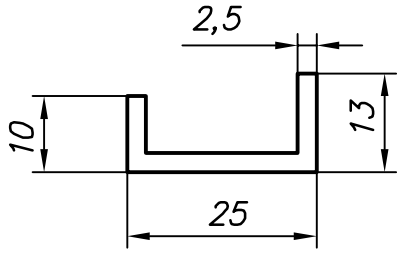

$F = 107\text{mm}^2$
 $G = 0,290\text{kg/m}$

500-3836

Мк: -170
бр. кан.-2
подл.
оп.п.

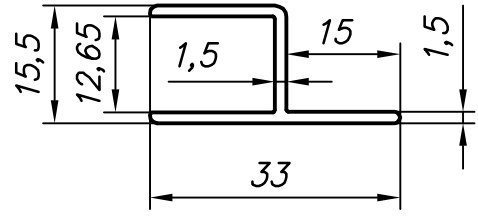

$F = 91,6\text{mm}^2$
 $G = 0,247\text{kg/m}$

500-3841

Мк: -200
бр. кан.-2
оп.п.

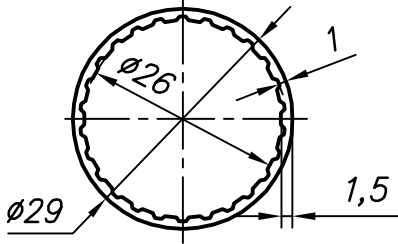

$F = 113\text{mm}^2$
 $G = 0,306\text{kg/m}$

500-3837

Мк: -130
бр. кан.-1
подл.
оп.п.

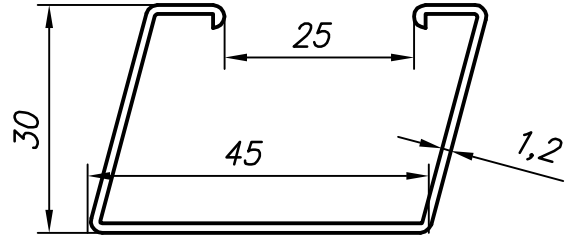

$F = 148\text{mm}^2$
 $G = 0,400\text{kg/m}$

500-3842

Мк: -130
бр. кан.-4

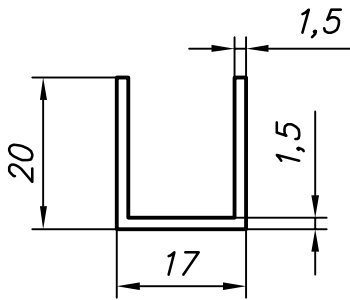

$F = 111\text{mm}^2$
 $G = 0,219\text{kg/m}$

500-3838

Мк: -170
бр. кан.-1
подл.
оп.п.

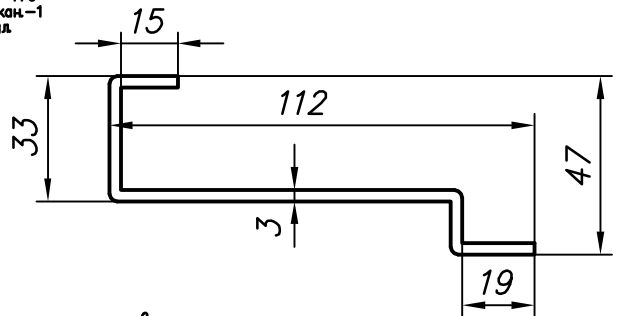

$F = 510\text{mm}^2$
 $G = 1,376\text{kg/m}$

500-3843

Мк: -200
бр. кан.-1
оп.п.

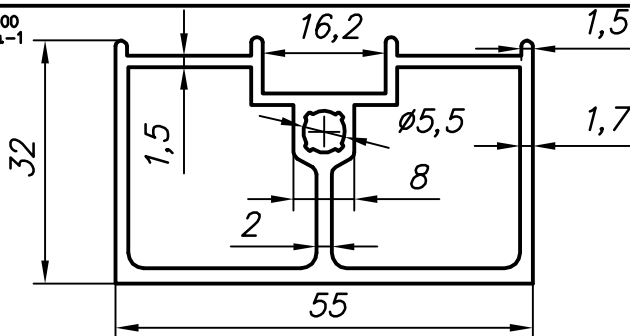

$F = 377\text{mm}^2$
 $G = 1,017\text{kg/m}$

500-3839

Мк: -200
бр. кан.-1
оп.п.

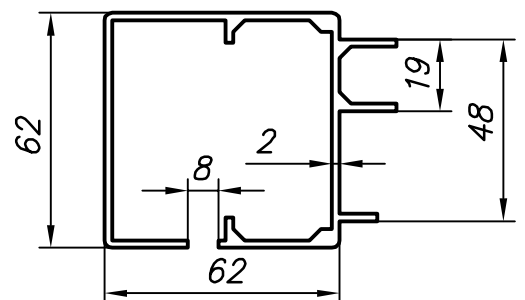

$F = 610\text{mm}^2$
 $G = 1,646\text{kg/m}$

500-3844

Мк: -270
бр. кан.-1

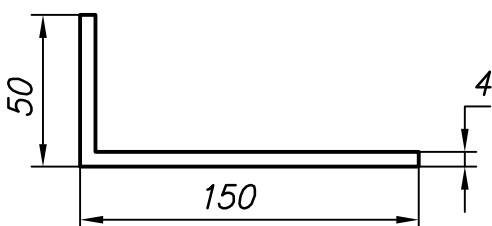

$F = 784\text{mm}^2$
 $G = 2,117\text{kg/m}$

500-3840

Мк: -200
бр. кан.-1

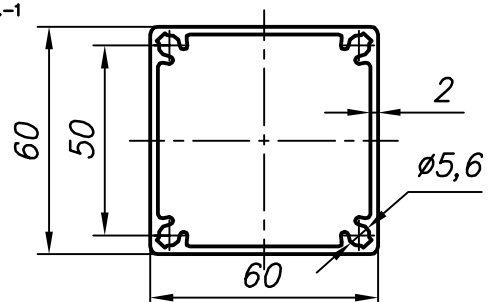

$F = 540\text{mm}^2$
 $G = 1,459\text{kg/m}$

500-3845

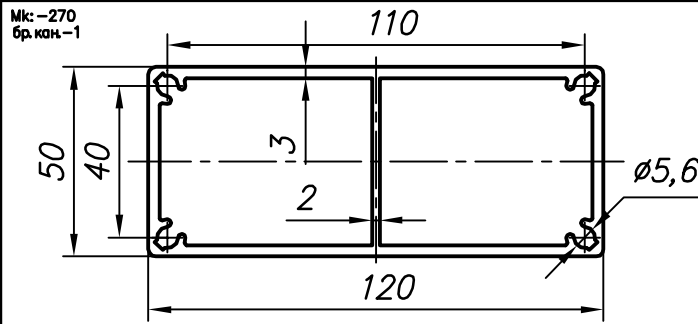

$F=1092\text{mm}^2$
 $G=2,948\text{kg/m}$

500-3846

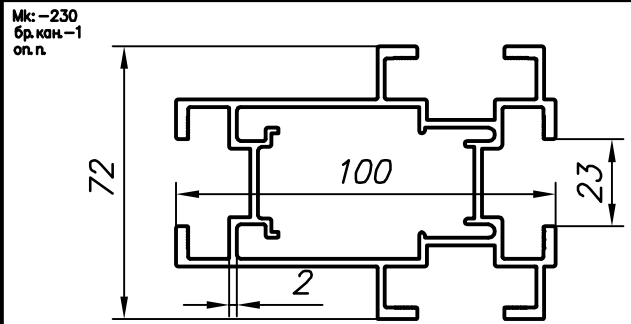

$F=997\text{mm}^2$
 $G=2,690\text{kg/m}$

500-3851

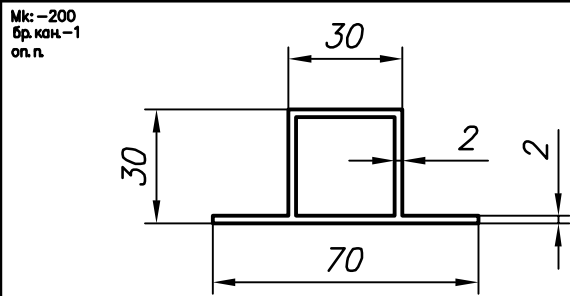

$F=304\text{mm}^2$
 $G=0,821\text{kg/m}$

500-3847

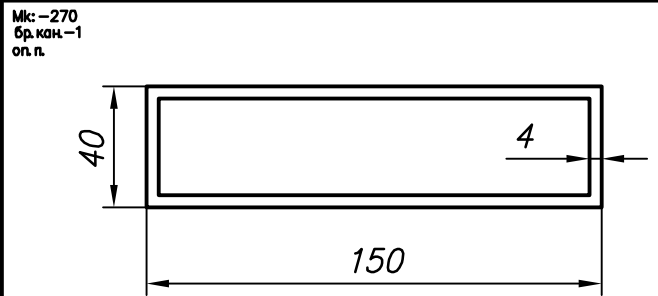

$F=1456\text{mm}^2$
 $G=3,931\text{kg/m}$

500-3852

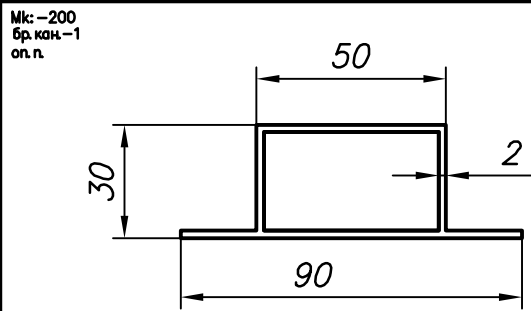

$F=384\text{mm}^2$
 $G=1,037\text{kg/m}$

500-3848

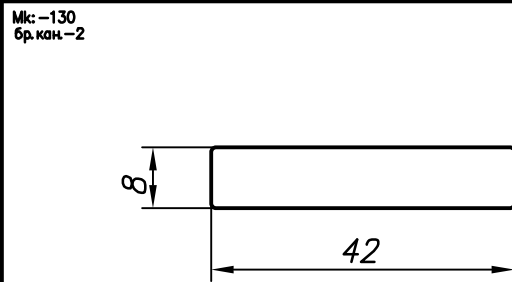

$F=336\text{mm}^2$
 $G=0,907\text{kg/m}$

500-3853

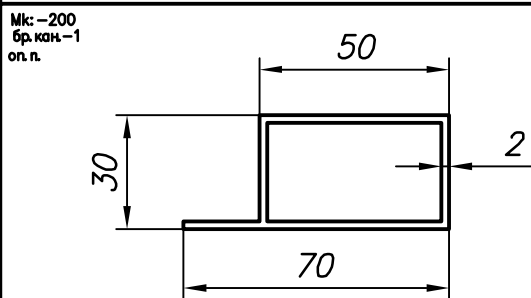

$F=344\text{mm}^2$
 $G=0,929\text{kg/m}$

500-3849

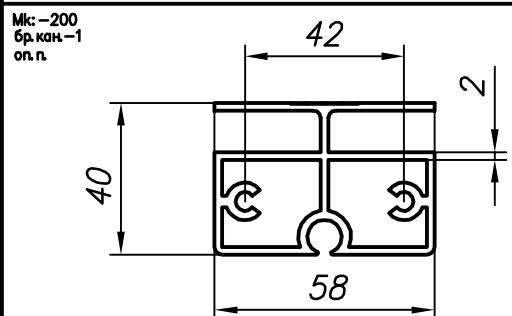

$F=635\text{mm}^2$
 $G=1,715\text{kg/m}$

500-3854

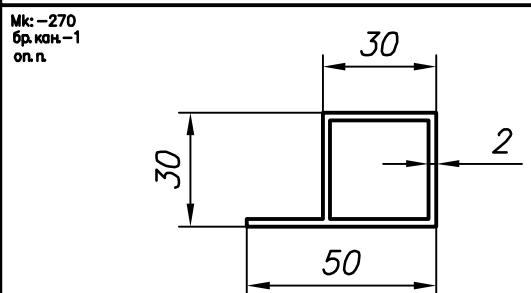

$F=264\text{mm}^2$
 $G=0,713\text{kg/m}$

500-3850

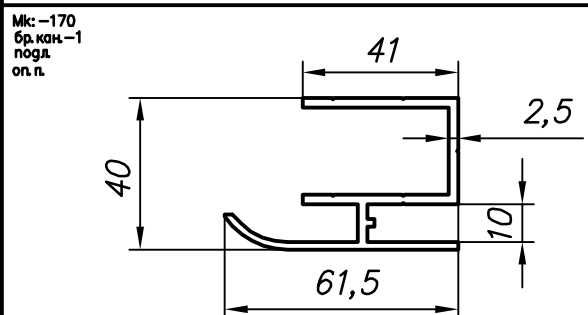

$F=418\text{mm}^2$
 $G=1,129\text{kg/m}$

500-3855

Мк: -170
бр. кан.-1
подл.
оп.п.

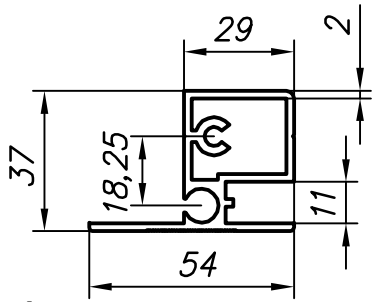

$F = 400\text{mm}^2$
 $G = 1,080\text{kg/m}$

500-3856

Мк: -170
бр. кан.-1
подл.
оп.п.

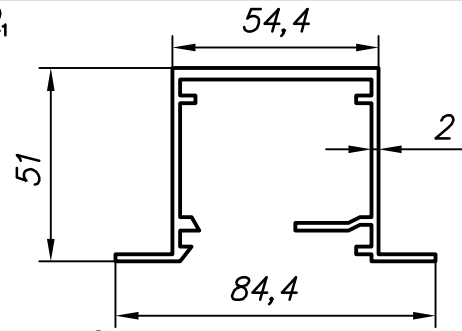

$F = 499\text{mm}^2$
 $G = 1,348\text{kg/m}$

500-3861

Мк: -170
бр. кан.-1
подл.
оп.п.

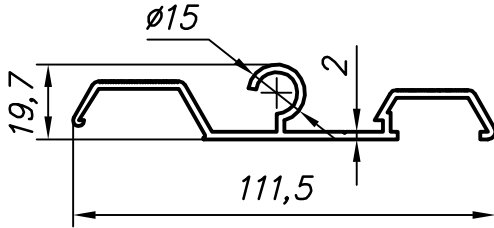

$F = 352\text{mm}^2$
 $G = 0,950\text{kg/m}$

500-3857

Мк: -170
бр. кан.-1
подл.
оп.п.

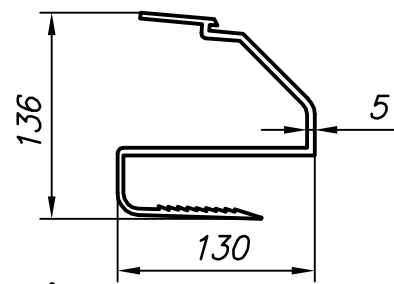

$F = 1992\text{mm}^2$
 $G = 5,379\text{kg/m}$

500-3862

Мк: -230
бр. кан.-1
оп.п.

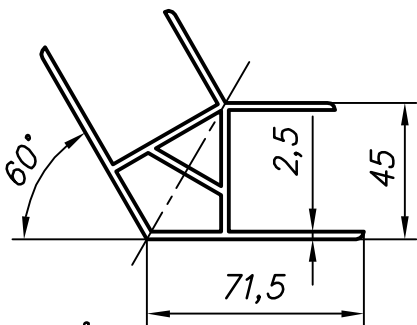

$F = 798\text{mm}^2$
 $G = 2,154\text{kg/m}$

500-3858

Мк: -200
бр. кан.-1
оп.п.

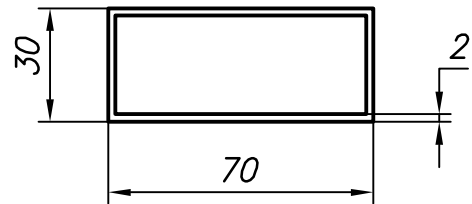

$F = 384\text{mm}^2$
 $G = 1,037\text{kg/m}$

500-3863

Мк: -200
бр. кан.-1
оп.п.

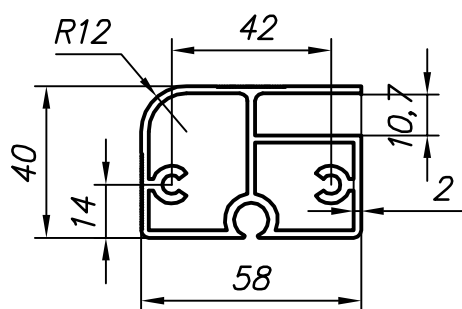

$F = 593\text{mm}^2$
 $G = 1,602\text{kg/m}$

500-3859

Мк: -200
бр. кан.-4
оп.п.

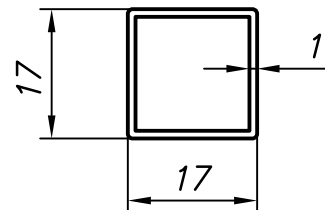

$F = 63,8\text{mm}^2$
 $G = 0,172\text{kg/m}$

500-3864

Мк: -170
бр. кан.-1

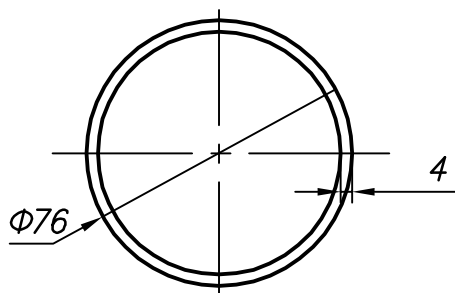

$F = 905\text{mm}^2$
 $G = 2,443\text{kg/m}$

500-3860

Мк: -170
бр. кан.-4

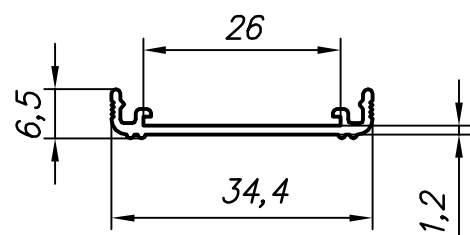

$F = 60\text{mm}^2$
 $G = 0,162\text{kg/m}$

500-3865

Мк: -200
бр. кан.-1
оп.п.

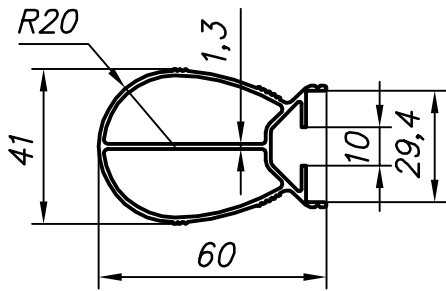

$F = 308\text{mm}^2$
 $G = 0,831\text{kg/m}$

500-3866

Мк: -170
бр. кан.-1

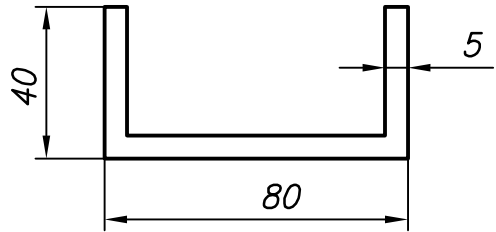

$F = 750\text{mm}^2$
 $G = 2,025\text{kg/m}$

500-3871

Мк: -170
бр. кан.-1
подл.
оп.п.

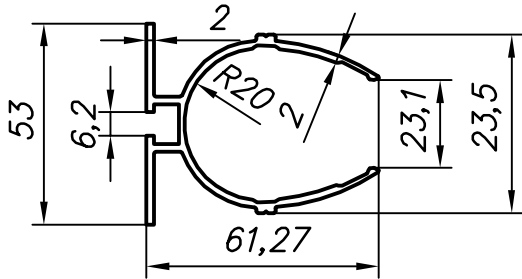

$F = 373\text{mm}^2$
 $G = 1,009\text{kg/m}$

500-3867

Мк: -130
бр. кан.-2

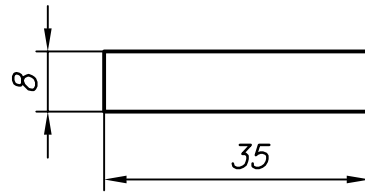

$F = 280\text{mm}^2$
 $G = 0,756\text{kg/m}$

500-3872

Мк: -200
бр. кан.-1
оп.п.

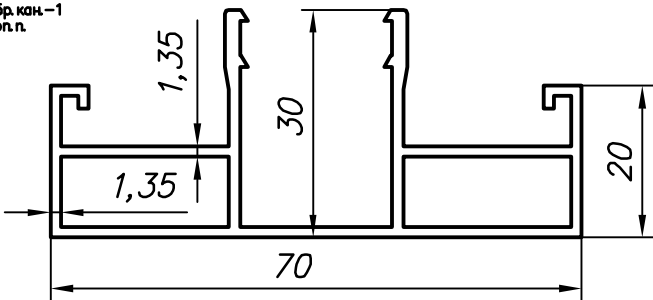

$F = 317\text{mm}^2$
 $G = 0,728\text{kg/m}$

500-3868

Мк: -170
бр. кан.-2
подл.
оп.п.

Мк: -130
бр. кан.-1
подл.
оп.п.

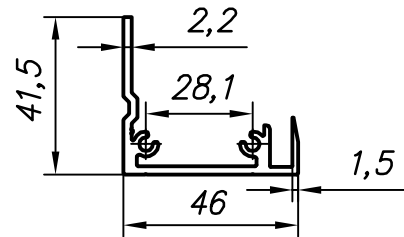

$F = 273\text{mm}^2$
 $G = 0,737\text{kg/m}$

500-3873

Мк: -200
бр. кан.-1
оп.п.

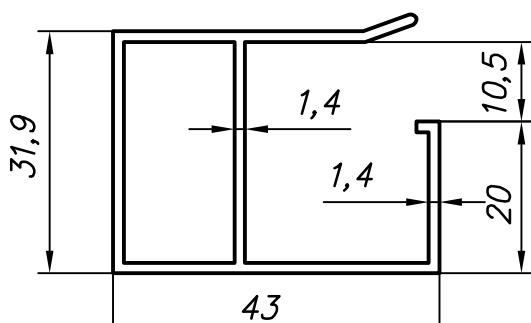

$F = 226\text{mm}^2$
 $G = 0,611\text{kg/m}$

500-3869

Мк: -130
бр. кан.-4
подл.

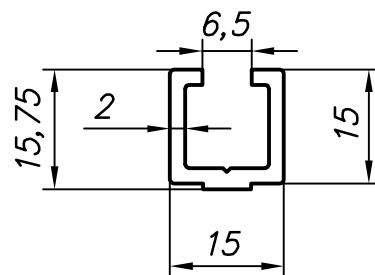

$F = 95,5\text{mm}^2$
 $G = 0,258\text{kg/m}$

500-3874

Мк: -170
бр. кан.-1

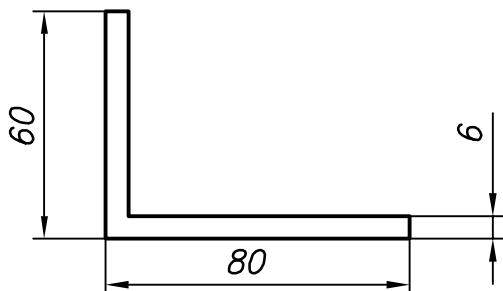

$F = 804\text{mm}^2$
 $G = 2,171\text{kg/m}$

500-3870

Мк: -170
бр. кан.-4

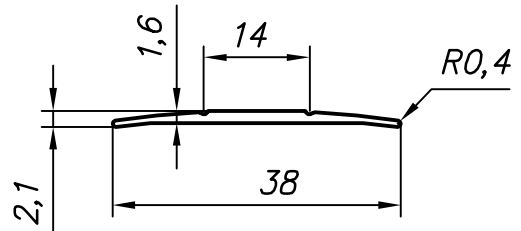

$F = 41,7\text{mm}^2$
 $G = 0,128\text{kg/m}$

500-3875

Мк: -170
бр. кан.-4
подл.

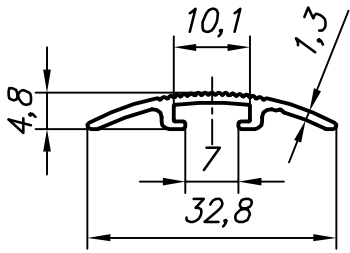

$F = 54 \text{ mm}^2$
 $G = 0,145 \text{ kg/m}$

500-3876

Мк: -270
бр. кан.-1

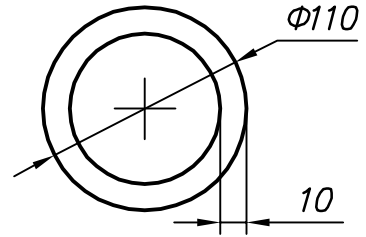

$F = 3142 \text{ mm}^2$
 $G = 8,482 \text{ kg/m}$

500-3881

Мк: -130
бр. кан.-4

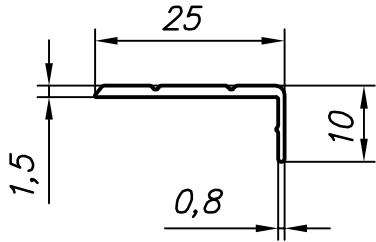

$F = 43 \text{ mm}^2$
 $G = 0,115 \text{ kg/m}$

500-3877

Мк: -170
бр. кан.-1

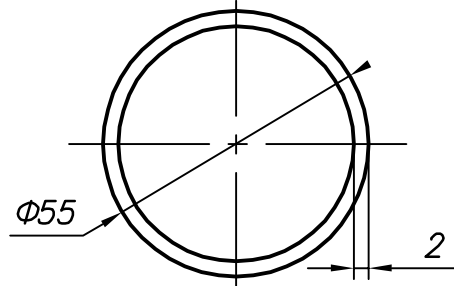

$F = 333 \text{ mm}^2$
 $G = 0,899 \text{ kg/m}$

500-3882

Мк: -170
бр. кан.-4

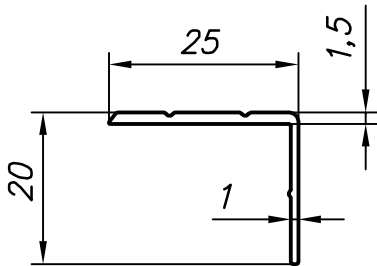

$F = 54 \text{ mm}^2$
 $G = 0,147 \text{ kg/m}$

500-3878

Мк: -230
бр. кан.-1

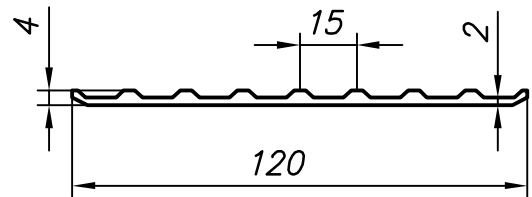

$F = 312 \text{ mm}^2$
 $G = 0,842 \text{ kg/m}$

500-3883

Мк: -170
бр. кан.-4
подл.

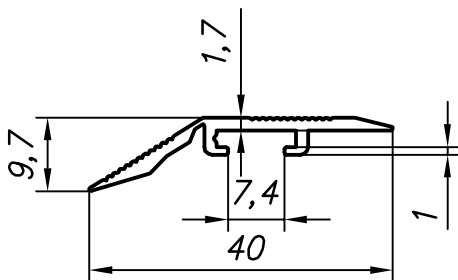

$F = 78 \text{ mm}^2$
 $G = 0,211 \text{ kg/m}$

500-3879

Мк: -130
бр. кан.-2
подл.
оп.п.

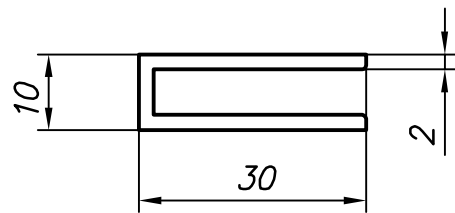

$F = 132 \text{ mm}^2$
 $G = 0,356 \text{ kg/m}$

500-3884

Мк: -170
бр. кан.-2
подл.

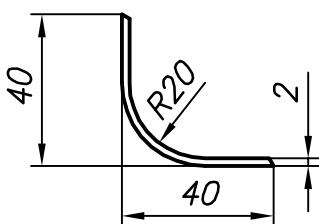

$F = 136 \text{ mm}^2$
 $G = 0,366 \text{ kg/m}$

500-3880

Мк: -200
бр. кан.-1

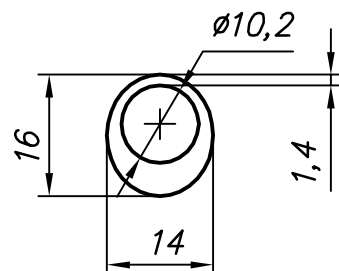

$F = 94 \text{ mm}^2$
 $G = 0,254 \text{ kg/m}$

500-3885

Мк: -200
бр. кан.-2
оп.п.

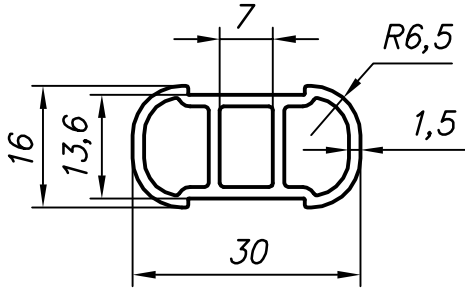

F= 151mm²
G=0,408kg/m

500-3886

Мк: -130
бр. кан.-1

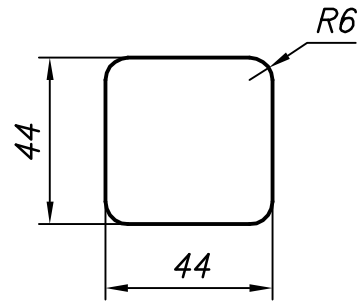

F=1901mm²
G=5,144kg/m

500-3891

Мк: -200
бр. кан.-4
оп.п.

Мк: -130
бр. кан.-2
оп.п.

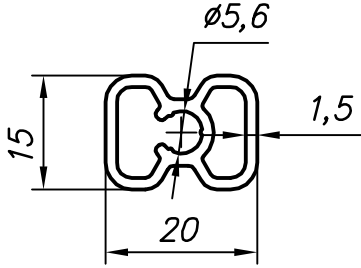

F= 115mm²
G=0,311kg/m

500-3887

Мк: -130
бр. кан.-2

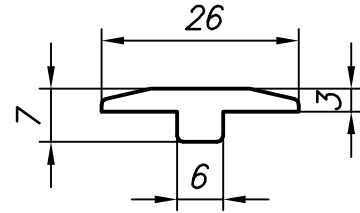

F= 92 mm²
G=0,248kg/m

500-3892

Мк: -200
бр. кан.-1
подл.
оп.п.

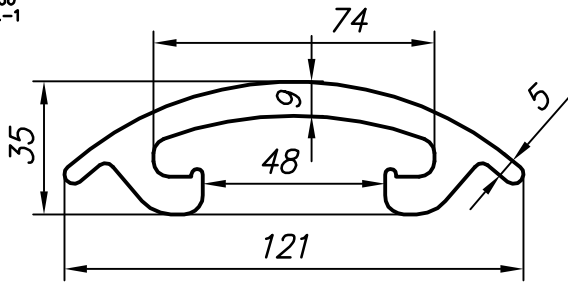

F=1451mm²
G=3,919kg/m

500-3888

Мк: -130
бр. кан.-2

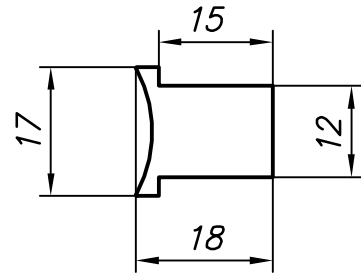

F= 207mm²
G=0,559kg/m

500-3893

Мк: -170
бр. кан.-2
оп.п.

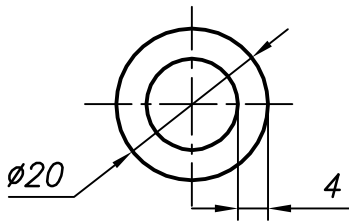

F= 201mm²
G=0,543kg/m

500-3889

Мк: -130
бр. кан.-4

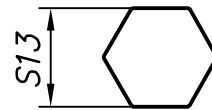

F= 146mm²
G=0,395kg/m

500-3894

Мк: -170
бр. кан.-1
подл.
оп.п.

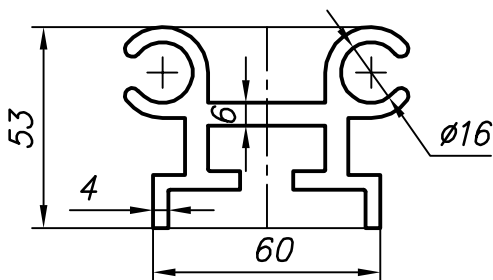

F=1132mm²
G=3,056kg/m

500-3890

Мк: -170
бр. кан.-1
оп.п.

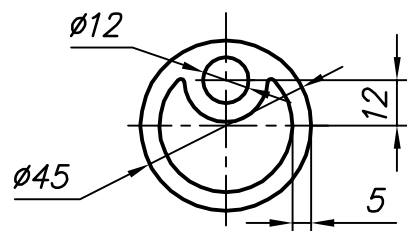

F= 801mm²
G=2,162kg/m

500-3895

Мк: -130
бр. кан.-2

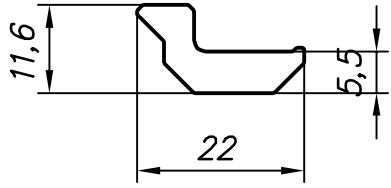

$F = 121\text{mm}^2$
 $G = 0,327\text{kg/m}$

500-3896

Мк: -170
бр. кан.-1
подл.
оп.п.

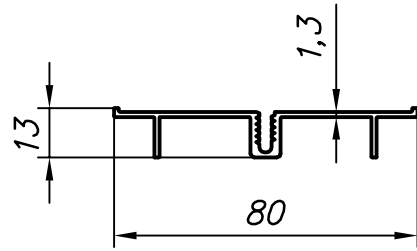

$F = 182\text{mm}^2$
 $G = 0,492\text{kg/m}$

500-3901

Мк: -230
бр. кан.-1
оп.п.

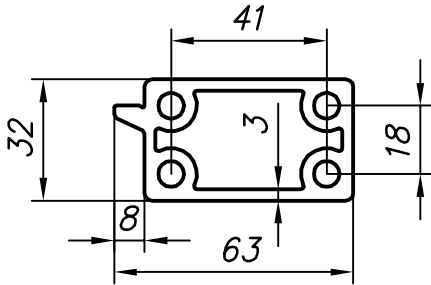

$F = 935\text{mm}^2$
 $G = 2,529\text{kg/m}$

500-3897

Мк: -170
бр. кан.-1
подл.
оп.п.

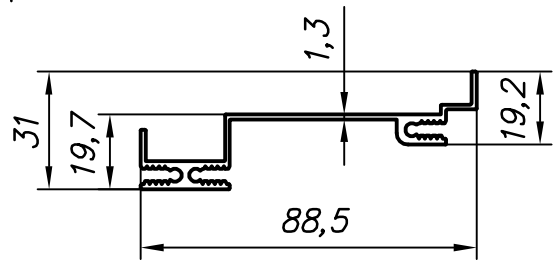

$F = 273\text{mm}^2$
 $G = 0,736\text{kg/m}$

500-3902

Мк: -130
бр. кан.-1
подл.
оп.п.

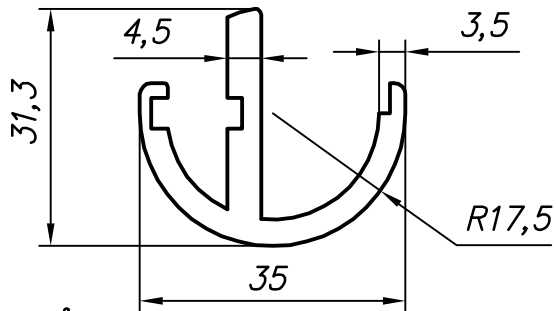

$F = 299\text{mm}^2$
 $G = 0,807\text{kg/m}$

500-3898

Мк: -170
бр. кан.-1

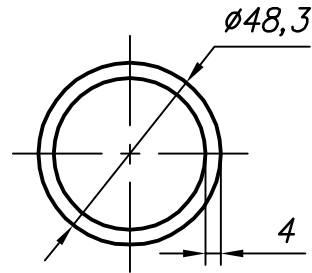

$F = 557\text{mm}^2$
 $G = 1,503\text{kg/m}$

500-3903

Мк: -270
бр. кан.-1
оп.п.

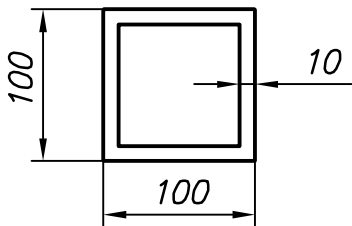

$F = 3600\text{mm}^2$
 $G = 9,720\text{kg/m}$

500-3899

Мк: -130
бр. кан.-6
подл.

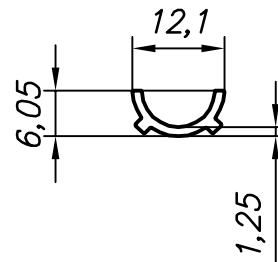

$F = 25,4\text{mm}^2$
 $G = 0,069\text{kg/m}$

500-3904

Мк: -270
бр. кан.-1
подл.
оп.п.

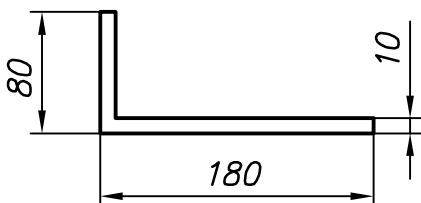

$F = 2500\text{mm}^2$
 $G = 6,750\text{kg/m}$

500-3900

Мк: -270
бр. кан.-1

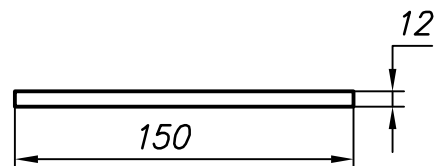

$F = 1800\text{mm}^2$
 $G = 4,859\text{kg/m}$

500-3905

Мк: -170
бр. кан.-1
подл.

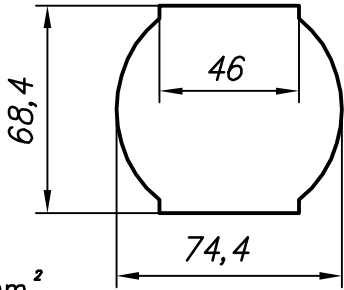

$F=4328\text{mm}^2$
 $G=11,687\text{kg/m}$

500-3906

Мк: -130
бр. кан.-6

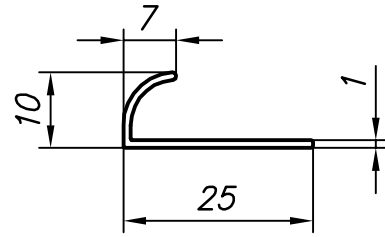

$F=37\text{mm}^2$
 $G=0,100\text{kg/m}$

500-3911

Мк: -230
бр. кан.-1
оп.п.

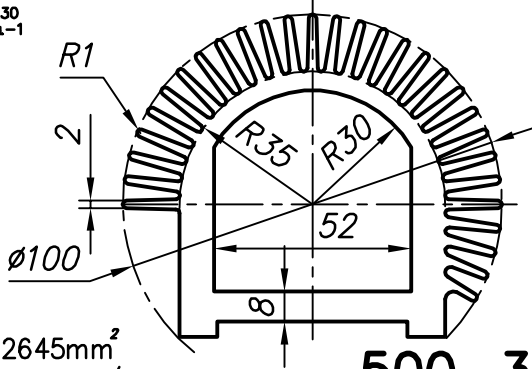

$F=2645\text{mm}^2$
 $G=7,143\text{kg/m}$

500-3907

Мк: -130
бр. кан.-1
подл.

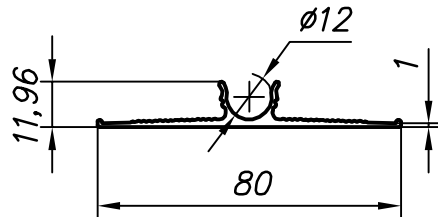

$F=170\text{mm}^2$
 $G=0,458\text{kg/m}$

500-3912

Мк: -270
бр. кан.-1

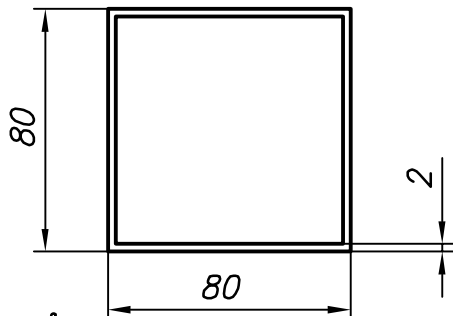

$F=624\text{mm}^2$
 $G=1,685\text{kg/m}$

500-3908

Мк: -200
бр. кан.-1
подл.

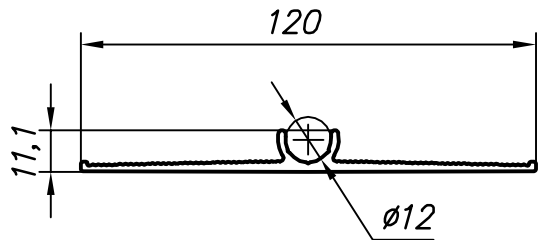

$F=313\text{mm}^2$
 $G=0,845\text{kg/m}$

500-3913

Мк: -130
бр. кан.-2
оп.п.

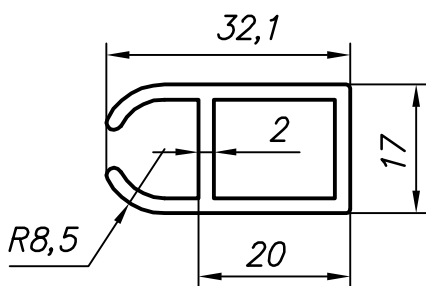

$F=186\text{mm}^2$
 $G=0,500\text{kg/m}$

500-3909

Мк: -270
бр. кан.-1
подл.
оп.п.

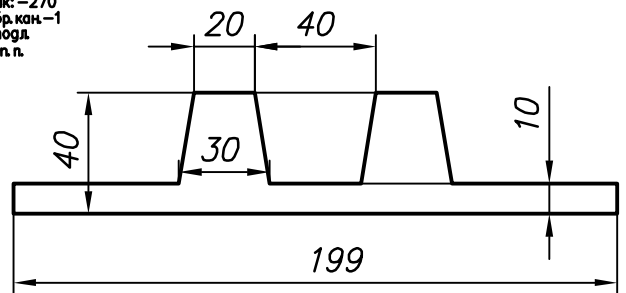

$F=3490\text{mm}^2$
 $G=9,423\text{kg/m}$

500-3914

Мк: -230
бр. кан.-2

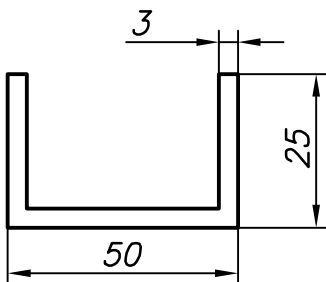

$F=282\text{mm}^2$
 $G=0,761\text{kg/m}$

500-3910

Мк: -170
бр. кан.-1
подл.

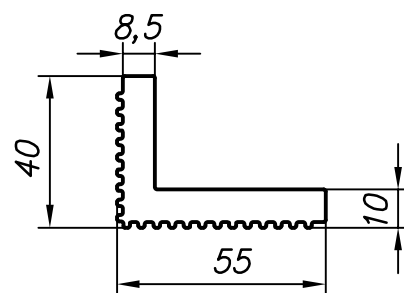

$F=766\text{mm}^2$
 $G=2,067\text{kg/m}$

500-3915

Мк: -270
бр. кан.-1
подл.
оп. п.

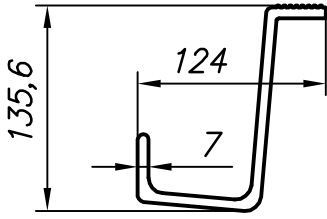

$F=1983\text{mm}^2$
 $G=5,353\text{kg/m}$

500-3916

Мк: -130
бр. кан.-2
подл.

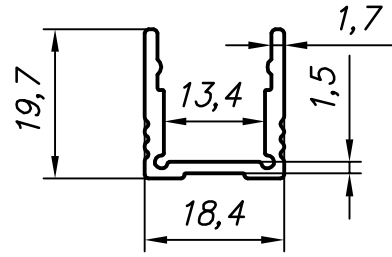

$F=104\text{mm}^2$
 $G=0,280\text{kg/m}$

500-3921

Мк: -130
бр. кан.-1

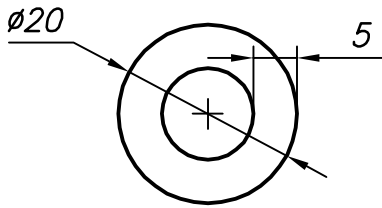

$F=236\text{mm}^2$
 $G=0,636\text{kg/m}$

500-3917

Мк: -230
бр. кан.-1

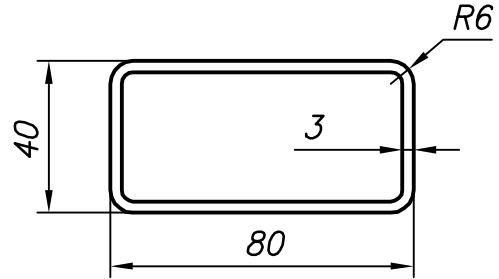

$F=684\text{mm}^2$
 $G=1,784\text{kg/m}$

500-3922

Мк: -200
бр. кан.-2

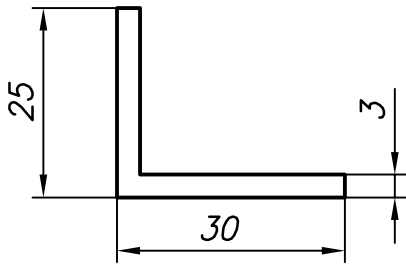

$F=156\text{mm}^2$
 $G=0,421\text{kg/m}$

500-3918

Мк: -270
бр. кан.-1
подл.
оп. п.

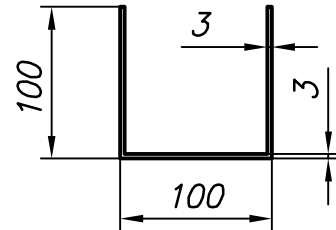

$F=882\text{mm}^2$
 $G=2,381\text{kg/m}$

500-3923

Мк: -230
бр. кан.-1

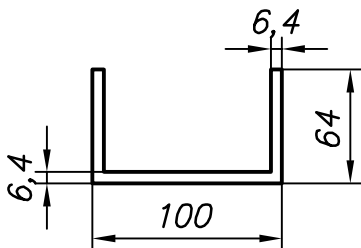

$F=377\text{mm}^2$
 $G=3,719\text{kg/m}$

500-3919

Мк: -270
бр. кан.-1

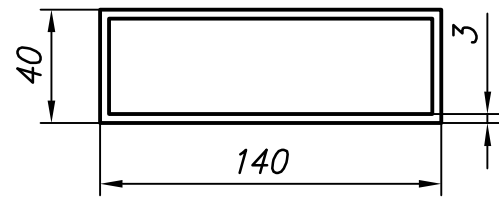

$F=1044\text{mm}^2$
 $G=2,819\text{kg/m}$

500-3924

Мк: -130
бр. кан.-4
подл.

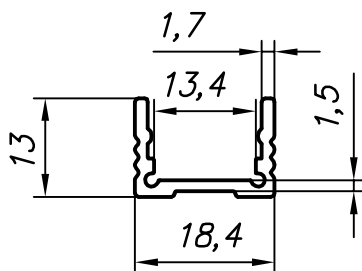

$F=70\text{mm}^2$
 $G=0,190\text{kg/m}$

500-3920

Мк: -170
бр. кан.-1
оп. п.

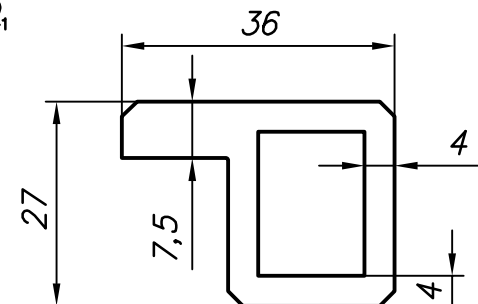

$F=425\text{mm}^2$
 $G=1,148\text{kg/m}$

500-3925

Мк: -200
бр. кан.-1
оп.п.

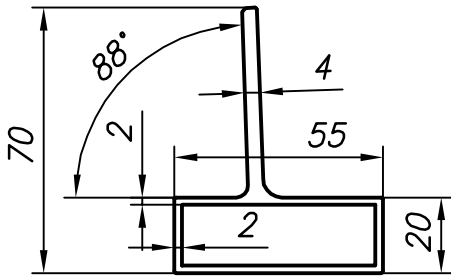

$F = 490\text{mm}^2$
 $G = 1,323\text{kg/m}$

500-3926

Мк: -230
бр. кан.-1
оп.п.

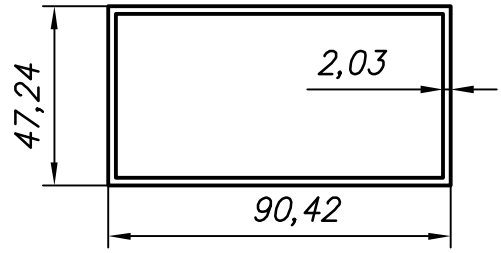

$F = 542\text{mm}^2$
 $G = 1,465\text{kg/m}$

500-3931

Мк: -200
бр. кан.-1
оп.п.

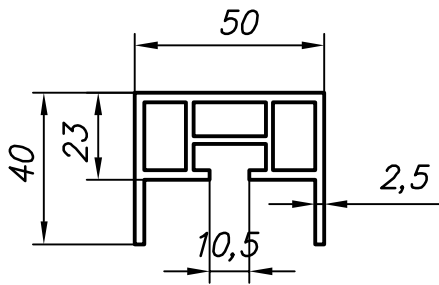

$F = 509\text{mm}^2$
 $G = 1,374\text{kg/m}$

500-3927

Мк: -130
бр. кан.-4
подл.

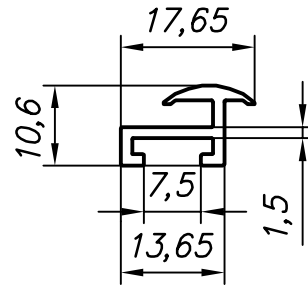

$F = 58\text{mm}^2$
 $G = 0,156\text{kg/m}$

500-3932

Мк: -270
бр. кан.-1
подл.
оп.п.
опора

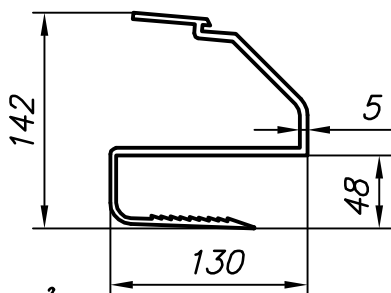

$F = 2016\text{mm}^2$
 $G = 5,444\text{kg/m}$

500-3928

Мк: -130
бр. кан.-1

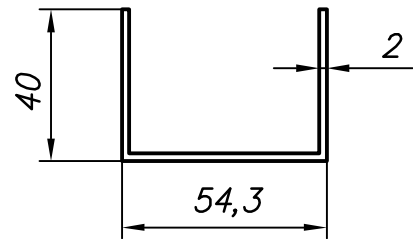

$F = 260\text{mm}^2$
 $G = 0,702\text{kg/m}$

500-3933

Мк: -230
бр. кан.-1
оп.п.

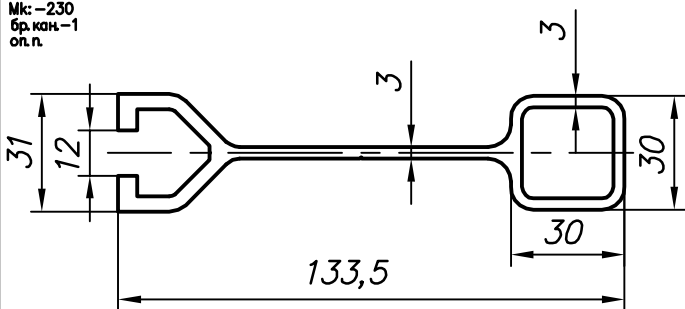

$F = 867\text{mm}^2$
 $G = 2,340\text{kg/m}$

500-3929

Мк: -230
бр. кан.-1
подл.

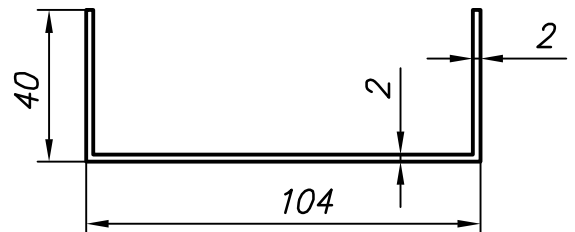

$F = 360\text{mm}^2$
 $G = 0,972\text{kg/m}$

500-3934

Мк: -230
бр. кан.-1
подл.

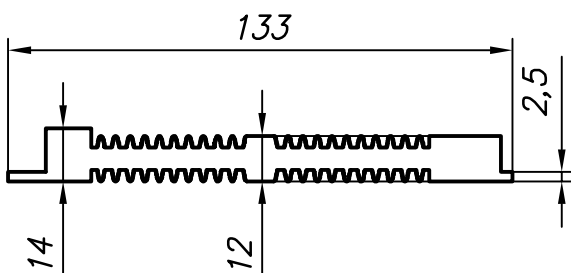

$F = 1178\text{mm}^2$
 $G = 3,180\text{kg/m}$

500-3930

Мк: -170
бр. кан.-1

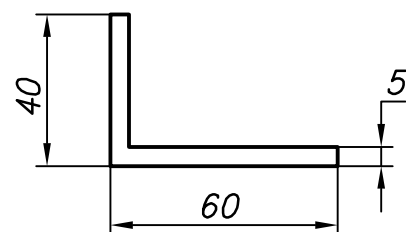

$F = 475\text{mm}^2$
 $G = 1,283\text{kg/m}$

500-3935

Мк: -170
бр. кан.-1
подл.
оп.п.

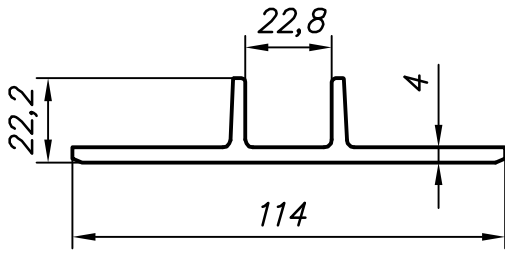

F= 587mm²
G=1,586kg/m

500-3936

Мк: -170
бр. кан.-1

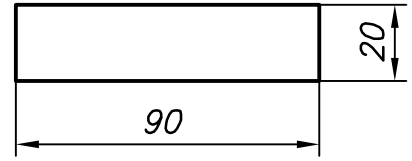

F=1800mm²
G=4,860kg/m

500-3941

Мк: -170
бр. кан.-1
подл.

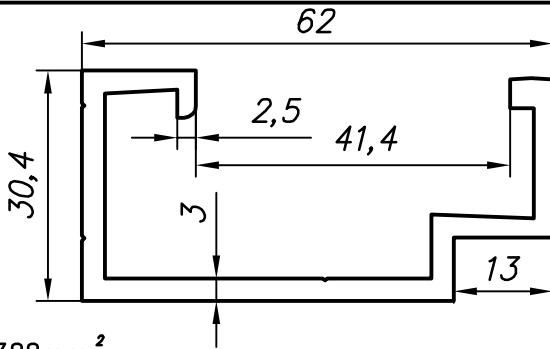

F= 388mm²
G=1,048kg/m

500-3937

Мк: -170
бр. кан.-4

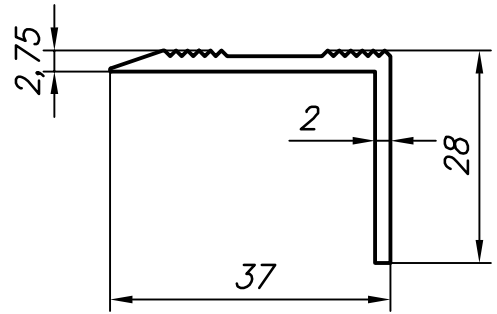

F= 128mm²
G=0,346kg/m

500-3942

Мк: -130
бр. кан.-1

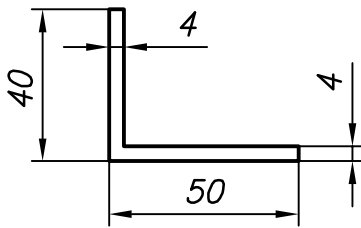

F= 344mm²
G=0,929kg/m

500-3938

Мк: -200
бр. кан.-4

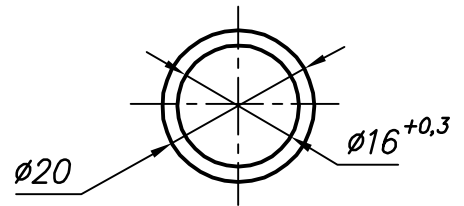

F= 113mm²
G=0,305kg/m

500-3943

Мк: -130
бр. кан.-2

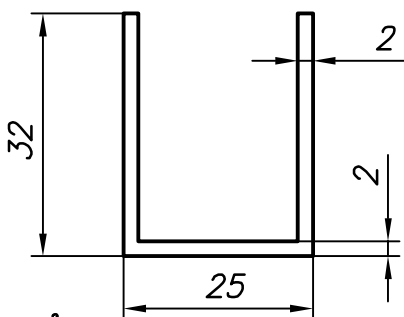

F= 170mm²
G=0,459kg/m

500-3939

Мк: -170
бр. кан.-1
оп.п.

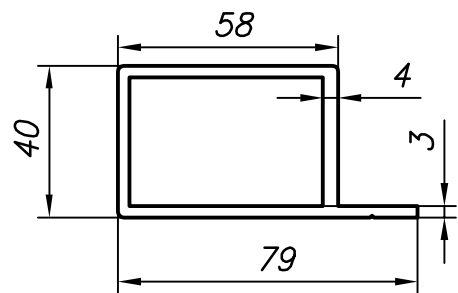

F= 647mm²
G=1,748kg/m

500-3944

Мк: -130
бр. кан.-4

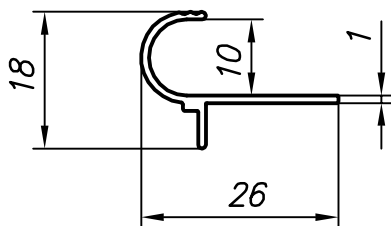

F= 47 mm²
G=0,127kg/m

500-3940

Мк: -200
бр. кан.-2

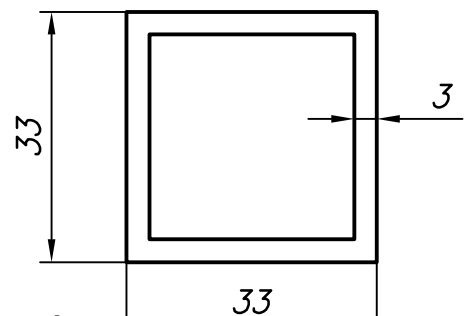

F= 360mm²
G=0,972kg/m

500-3945

Мк: -170
бр. кан.-1
подл.
оп. п.

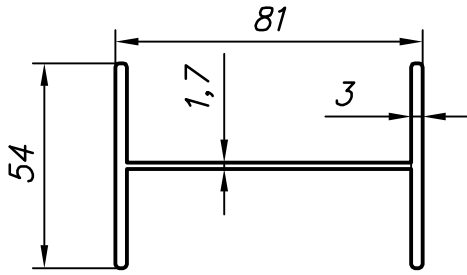

$F = 450\text{mm}^2$
 $G = 1,214\text{kg/m}$

500-3946

Мк: -170
бр. кан.-1
оп. п.

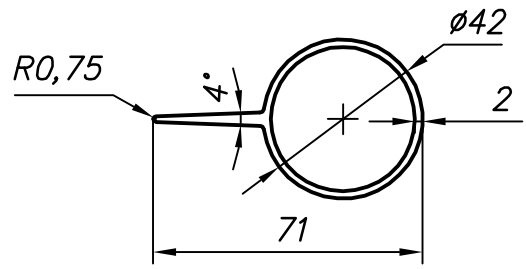

$F = 323\text{mm}^2$
 $G = 0,873\text{kg/m}$

500-3951

Мк: -270
бр. кан.-1
подл.

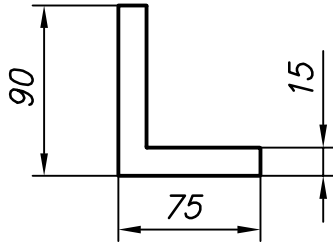

$F = 2250\text{mm}^2$
 $G = 6,074\text{kg/m}$

500-3947

Мк: -170
бр. кан.-1
оп. п.

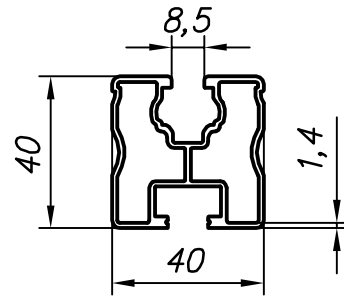

$F = 346\text{mm}^2$
 $G = 0,934\text{kg/m}$

500-3952

Мк: -130
бр. кан.-4

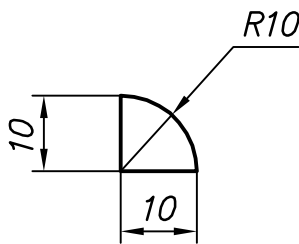

$F = 78,5\text{mm}^2$
 $G = 0,212\text{kg/m}$

500-3948

Мк: -170
бр. кан.-1
оп. п.

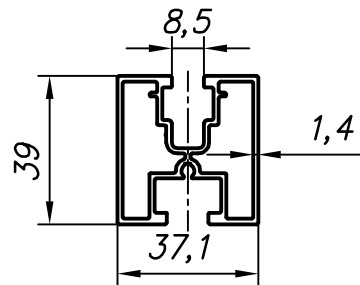

$F = 343\text{mm}^2$
 $G = 0,926\text{kg/m}$

500-3953

Мк: -170
бр. кан.-1

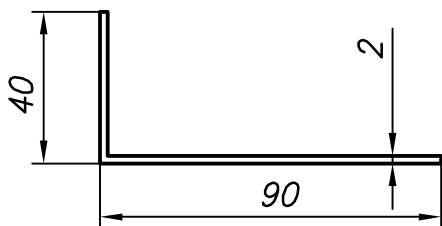

$F = 256\text{mm}^2$
 $G = 0,691\text{kg/m}$

500-3949

Мк: -170
бр. кан.-1
подл.
оп. п.

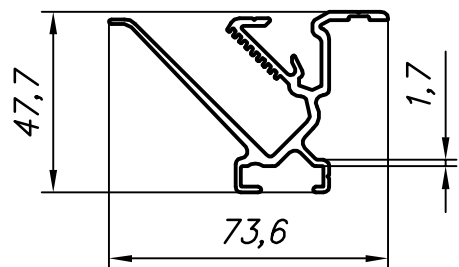

$F = 403\text{mm}^2$
 $G = 1,088\text{kg/m}$

500-3954

Мк: -130
бр. кан.-4

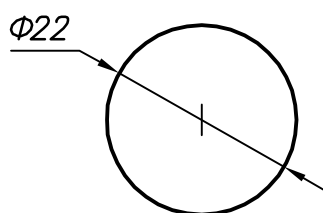

$F = 380\text{mm}^2$
 $G = 1,026\text{kg/m}$

500-3950

Мк: -270
бр. кан.-1
оп. п.

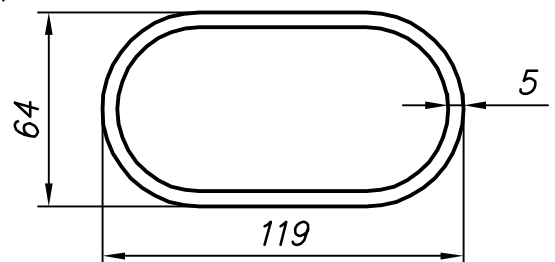

$F = 1477\text{mm}^2$
 $G = 3,987\text{kg/m}$

500-3955

Мк: -230
бр. кан.-1
подл.
оп.п.

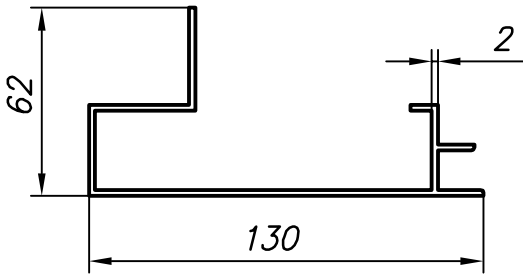

$F = 540 \text{ mm}^2$
 $G = 1,457 \text{ kg/m}$

500-3956

Мк: -130
бр. кан.-2

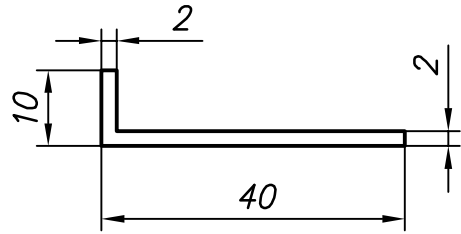

$F = 96 \text{ mm}^2$
 $G = 0,259 \text{ kg/m}$

500-3961

Мк: -130
бр. кан.-4

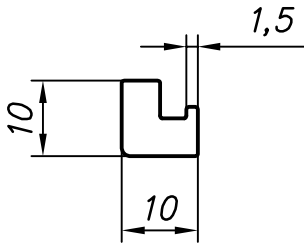

$F = 77 \text{ mm}^2$
 $G = 0,208 \text{ kg/m}$

500-3957

Мк: -130
бр. кан.-2

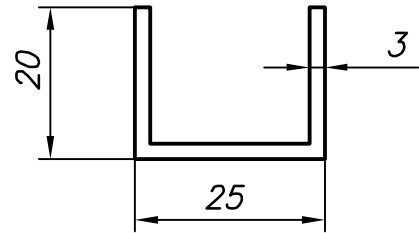

$F = 177 \text{ mm}^2$
 $G = 0,478 \text{ kg/m}$

500-3962

Мк: -130
бр. кан.-1
подл.

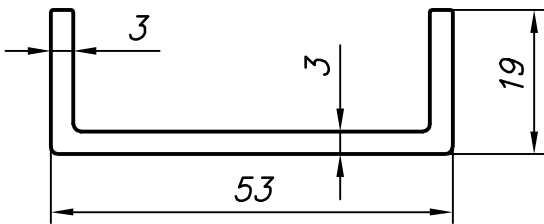

$F = 255 \text{ mm}^2$
 $G = 0,688 \text{ kg/m}$

500-3958

Мк: -230
бр. кан.-2

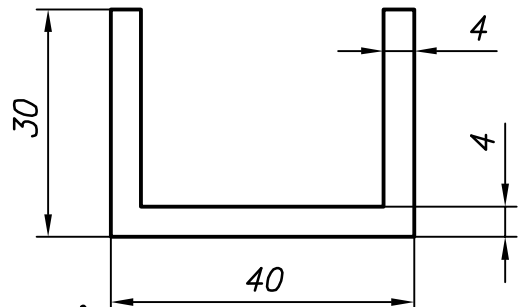

$F = 398 \text{ mm}^2$
 $G = 0,994 \text{ kg/m}$

500-3963

Мк: -200
бр. кан.-1

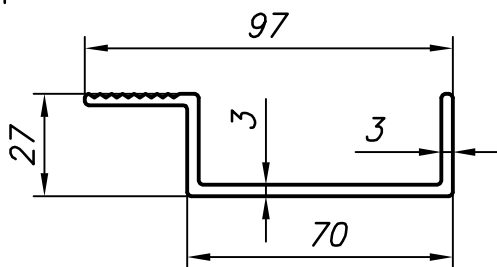

$F = 422 \text{ mm}^2$
 $G = 1,140 \text{ kg/m}$

500-3959

Мк: -270
бр. кан.-1
подл.
оп.п.

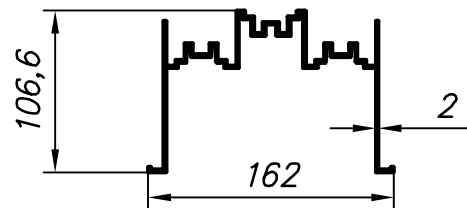

$F = 1178 \text{ mm}^2$
 $G = 2,912 \text{ kg/m}$

500-3964

Мк: -270
бр. кан.-1
подл.
оп.п.

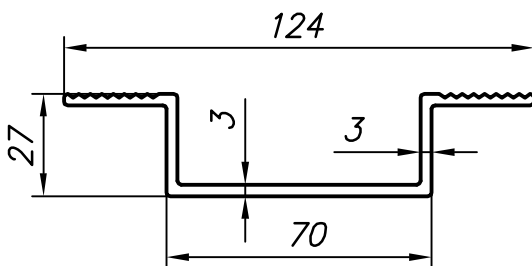

$F = 491 \text{ mm}^2$
 $G = 1,326 \text{ kg/m}$

500-3960

Мк: -170
бр. кан.-1

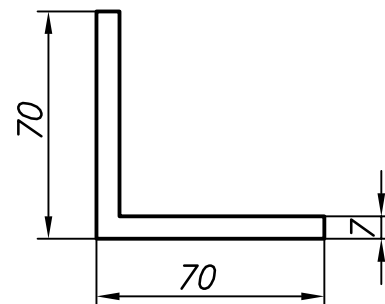

$F = 931 \text{ mm}^2$
 $G = 2,514 \text{ kg/m}$

500-3965

Мк: -270
бр. кан.-1

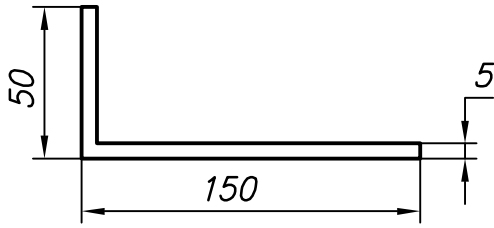

$F = 975 \text{ mm}^2$
 $G = 2,632 \text{ kg/m}$

500-3966

Мк: -130
бр. кан.-2

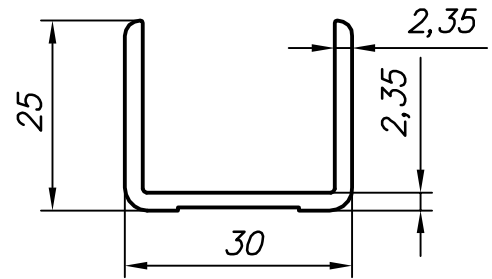

$F = 166 \text{ mm}^2$
 $G = 0,448 \text{ kg/m}$

500-3971

Мк: -270
бр. кан.-1
подл.
оп. п.

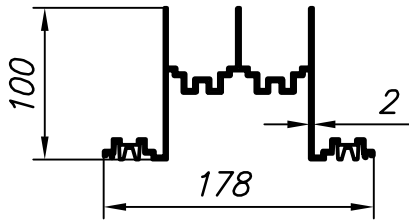

$F = 1207 \text{ mm}^2$
 $G = 3,258 \text{ kg/m}$

500-3967

Мк: -230
бр. кан.-1
оп. п.

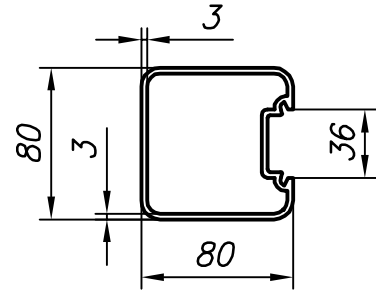

$F = 980 \text{ mm}^2$
 $G = 2,647 \text{ kg/m}$

500-3972

Мк: -170
бр. кан.-4
подл.

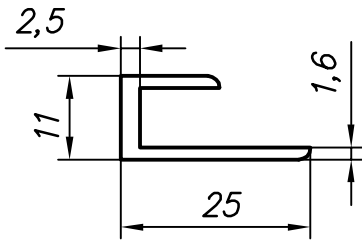

$F = 79 \text{ mm}^2$
 $G = 0,214 \text{ kg/m}$

500-3968

Мк: -130
бр. кан.-1
подл.
оп. п.

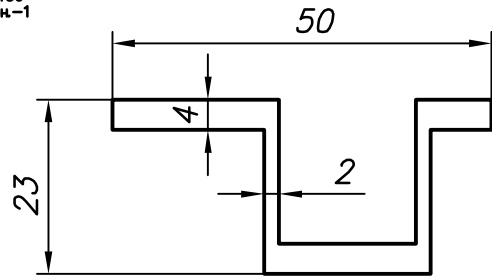

$F = 276 \text{ mm}^2$
 $G = 0,754 \text{ kg/m}$

500-3973

Мк: -170
бр. кан.-1
оп. п.

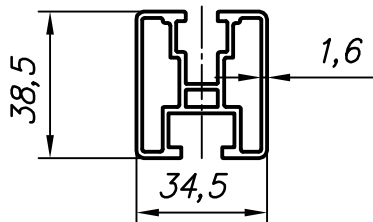

$F = 370 \text{ mm}^2$
 $G = 0,998 \text{ kg/m}$

500-3969

Мк: -130
бр. кан.-2

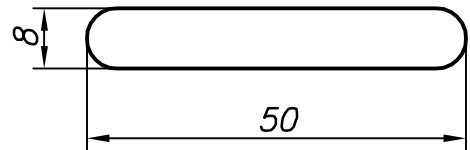

$F = 386 \text{ mm}^2$
 $G = 1,043 \text{ kg/m}$

500-3974

Мк: -170
бр. кан.-1
подл.

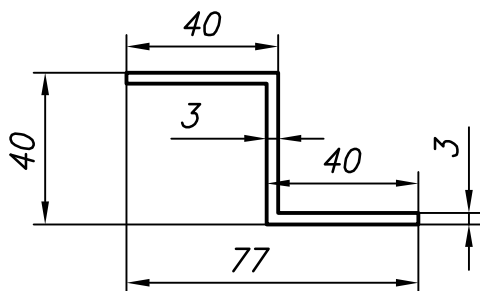

$F = 342 \text{ mm}^2$
 $G = 0,923 \text{ kg/m}$

500-3970

Мк: -170
бр. кан.-1

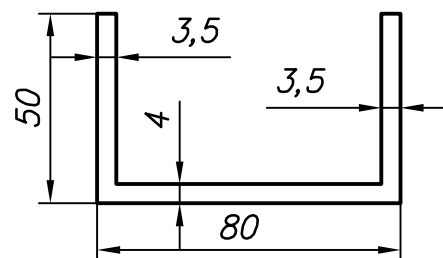

$F = 642 \text{ mm}^2$
 $G = 1,733 \text{ kg/m}$

500-3975

Мк: -230
бр. кан.-1
подл.

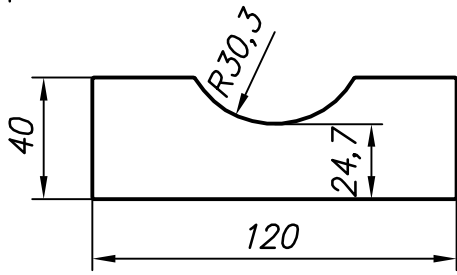

F=4228mm²
G=11,416kg/m

500-3976

PATENT

F= 893mm²
G=2,411kg/m

500-3981

Мк: -350
бр. кан.-1

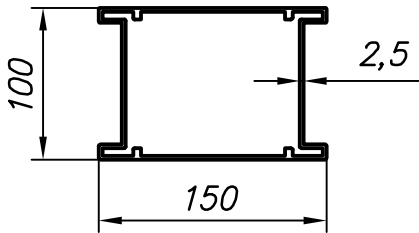

F=1472mm²
G=3,973kg/m

500-3977

Мк: -130
бр. кан.-1
подл.
оп.п.

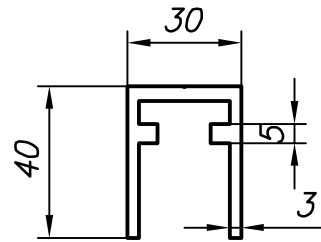

F= 386mm²
G=1,042kg/m

500-3982

Мк: -270
бр. кан.-4

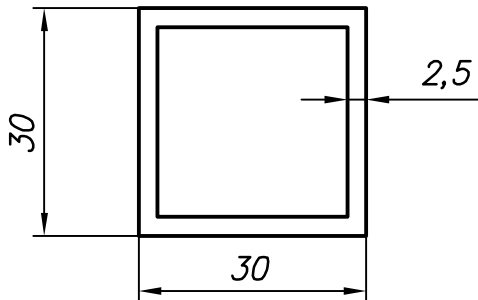

F= 275mm²
G=0,743kg/m

500-3978

Мк: -200
бр. кан.-1
подл.
оп.п.

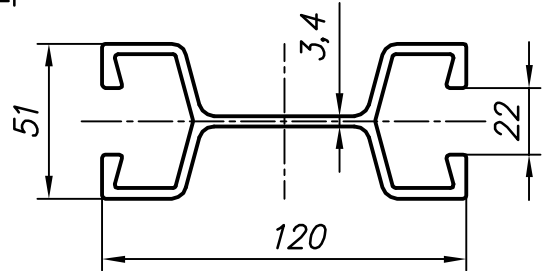

F=1101mm²
G=2,973kg/m

500-3983

Мк: -130
бр. кан.-4

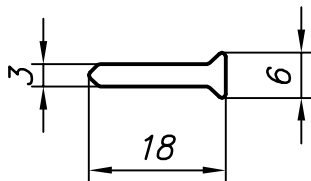

F=56,6mm²
G=0,153kg/m

500-3979

Мк: -170
бр. кан.-1
оп.п.

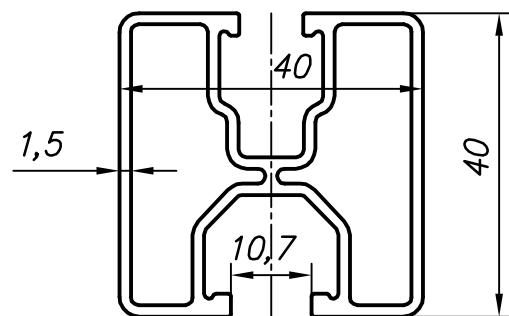

F= 353mm²
G=0,954kg/m

500-3984

PATENT

Мк: -130
бр. кан.-1
подл.
оп.п.

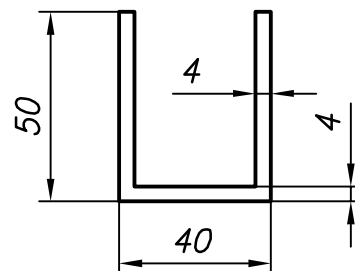

F=1353mm²
G=3,653kg/m

500-3980

F= 528mm²
G=1,426kg/m

500-3985

Мк: -170
бр. кан.-1

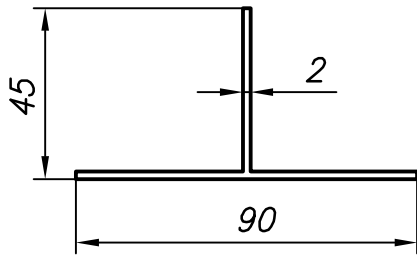

$F = 266 \text{ mm}^2$
 $G = 0,718 \text{ kg/m}$

500-3986

Мк: -200
бр. кан.-1
оп. п.

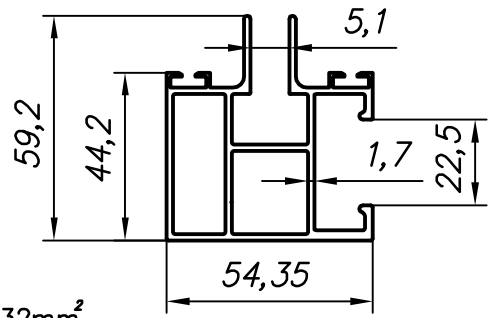

$F = 532 \text{ mm}^2$
 $G = 1,437 \text{ kg/m}$

500-3991

Мк: -130
бр. кан.-4
подл.

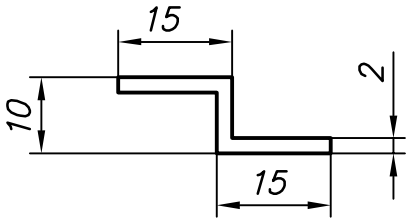

$F = 72 \text{ mm}^2$
 $G = 0,194 \text{ kg/m}$

500-3987

Мк: -170
бр. кан.-1
оп. п.

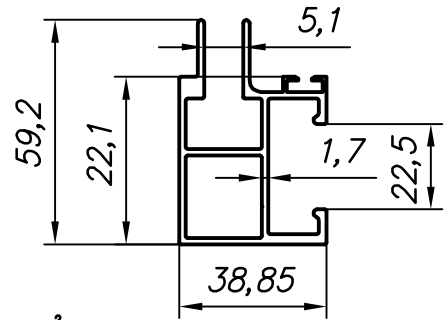

$F = 421 \text{ mm}^2$
 $G = 1,136 \text{ kg/m}$

500-3992

Мк: -270
бр. кан.-1
оп. п.

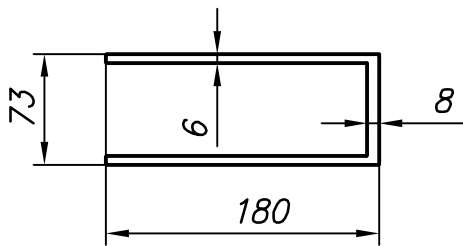

$F = 2648 \text{ mm}^2$
 $G = 7,149 \text{ kg/m}$

500-3988

Мк: -170
бр. кан.-1
оп. п.

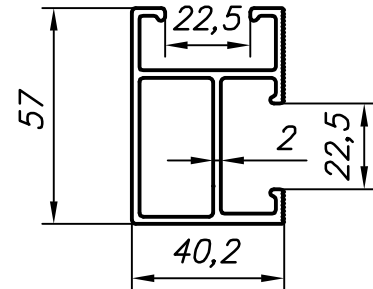

$F = 448 \text{ mm}^2$
 $G = 1,209 \text{ kg/m}$

500-3993

Мк: -170
бр. кан.-1

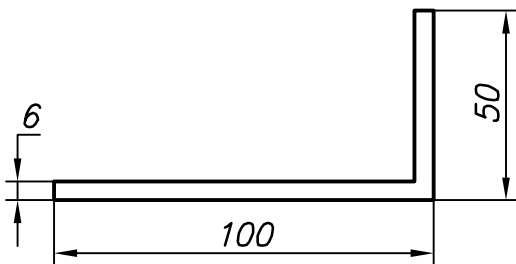

$F = 864 \text{ mm}^2$
 $G = 2,333 \text{ kg/m}$

500-3989

Мк: -130
бр. кан.-2

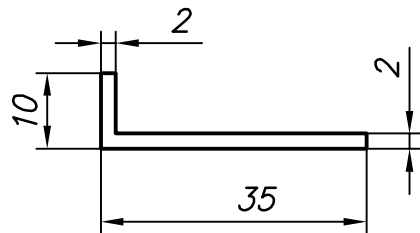

$F = 86 \text{ mm}^2$
 $G = 0,232 \text{ kg/m}$

500-3994

Мк: -270
бр. кан.-1

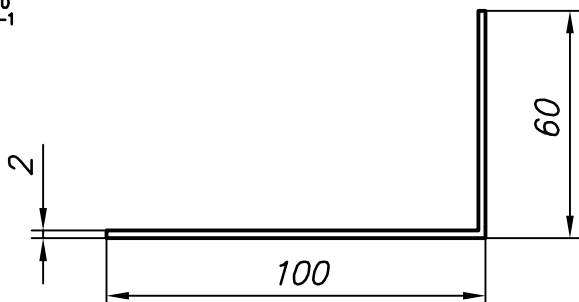

$F = 316 \text{ mm}^2$
 $G = 0,853 \text{ kg/m}$

500-3990

Мк: -230
бр. кан.-1

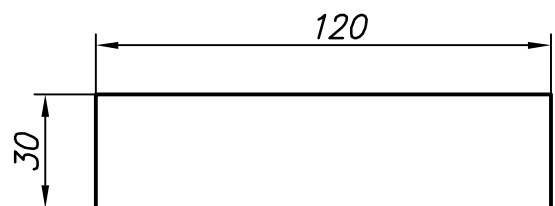

$F = 3600 \text{ mm}^2$
 $G = 9,720 \text{ kg/m}$

500-3995